

DEPARTMENT OF THE INTERIOR
U. S. GEOLOGICAL SURVEY

490-N-1-E/2-SE/4
STATE OF TEXAS
BOARD OF WATER ENGINEERS
JOHN A. NORRIS, CHAIRMAN
C. S. CLARK, A. H. DUNLAP

Advance sheet
Subject to correction

TEXAS
(CALDWELL COUNTY)
SAN MARCOS 1-d QUADRANGLE



100,000
YARDS

Topography by B.A. Jenkins and W.A. Fisher
Culture and drainage in part from aerial photographs
by Air Service, U. S. Army
Surveyed in 1925

Polyconic projection. North American datum
5000 yard grid based upon U. S. zone system, D

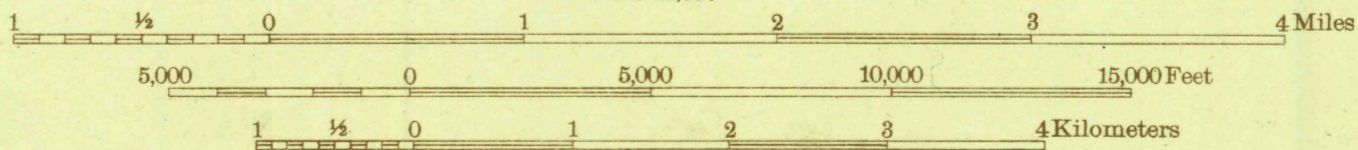

Contour interval 20 feet
10 foot contours in dashed lines
Datum is mean sea level

SAN MARCOS 1-d, TEX.

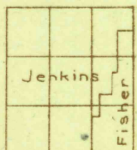

TRUE NORTH
MAGNETIC NORTH
APPROXIMATE MEAN
DECLINATION, 1925

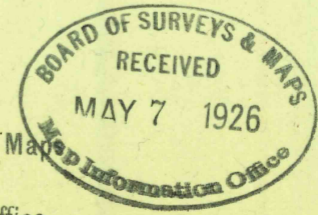
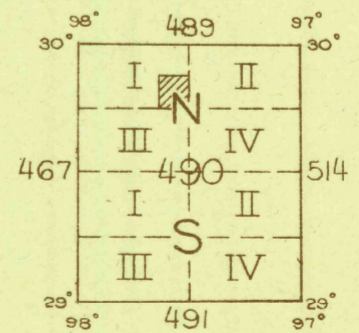

Board of Surveys & Maps
FILE COPY
Map Information Office