

U. S. G. S.
FILE COPY
Inspection and Editing.

Advance sheet
Subject to correction

DEPARTMENT OF THE INTERIOR
U. S. GEOLOGICAL SURVEY

490-N-111-W/2-SE/4
STATE OF TEXAS
BOARD OF WATER ENGINEERS
JOHN A. NORRIS, CHAIRMAN
C. S. CLARK, A. H. DUNLAP

TEXAS
(GUADALUPE COUNTY)
SAN MARCOS 3-d QUADRANGLE



Topography by R.H. Reineck
Culture and drainage in part from aerial photographs
from Air Service, U. S. Army
Surveyed in 1924

Polyconic projection. North American datum
5000 yard grid based upon U. S. zone system, D

TRUE NORTH
MAGNETIC NORTH
APPROXIMATE MEAN
DECLINATION, 1924

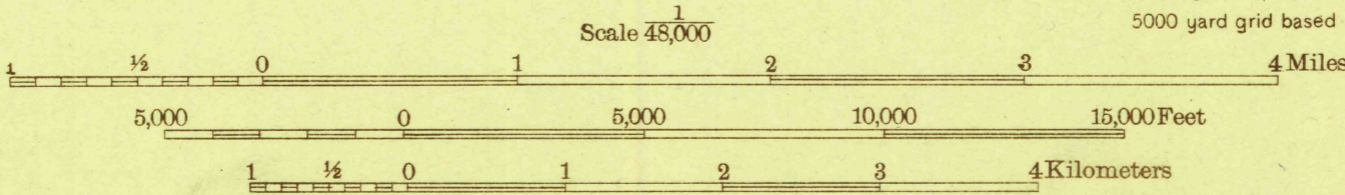

Contour interval 20 feet
10 foot contours in dashed lines
Datum is mean sea level

SAN MARCOS 3-d, TEX.

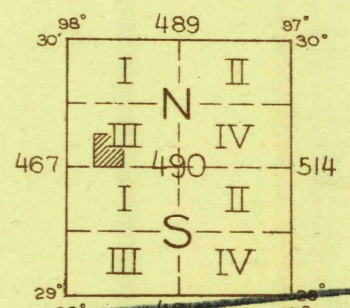

U. S. G. S.
FILE COPY
Inspection and Editing.