

TEXAS  
TEMPLE 2-c QUADRANGLE

488-S-11-W/2-SW/4  
STATE OF TEXAS  
BOARD OF WATER ENGINEERS  
JOHN A. NORRIS, CHAIRMAN  
C. S. CLARK, A. H. DUNLAP

DEPARTMENT OF THE INTERIOR  
U. S. GEOLOGICAL SURVEY

Advance sheet  
Subject to correction



Topography by R.G. Stevenson, F.H. Sargent, H.A. Bean,  
and G.A. Mock  
Surveyed in 1923 and 1924

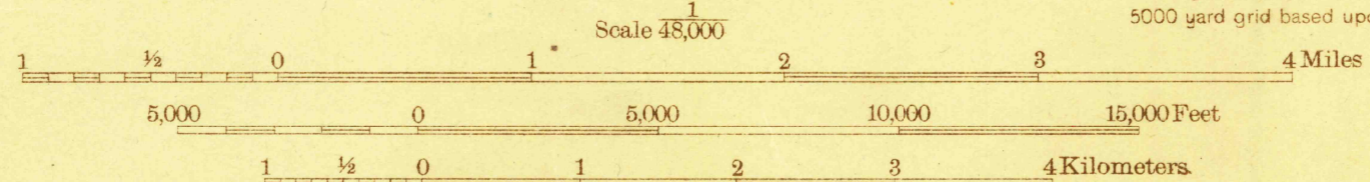

Polyconic projection. North American datum  
5000 yard grid based upon U. S. zone system, D

Contour interval 20 feet  
Datum is mean sea level

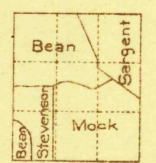
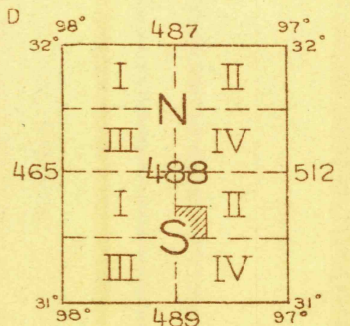

TRUE NORTH  
MAGNETIC NORTH  
APPROXIMATE MEAN DECLINATION, 1924

TEMPLE 2-c, TEX.

Board of Surveys & Maps  
FILE COPY  
Map Information Office

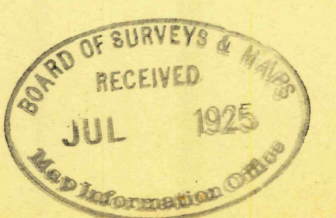

RETURN TO:  
USGS AND HISTORICAL MAP ARCHIVES