

U. S. G. S.
FILE COPY
Inspection and Editing.

468-N-11-E/2-NE/4
STATE OF TEXAS
BOARD OF WATER ENGINEERS
JOHN A. NORRIS, CHAIRMAN
C. S. CLARK, A. H. DUNLAP

Advance sheet
Subject to correction

TEXAS
TORDIA NO. 1 QUADRANGLE

DEPARTMENT OF THE INTERIOR
U. S. GEOLOGICAL SURVEY

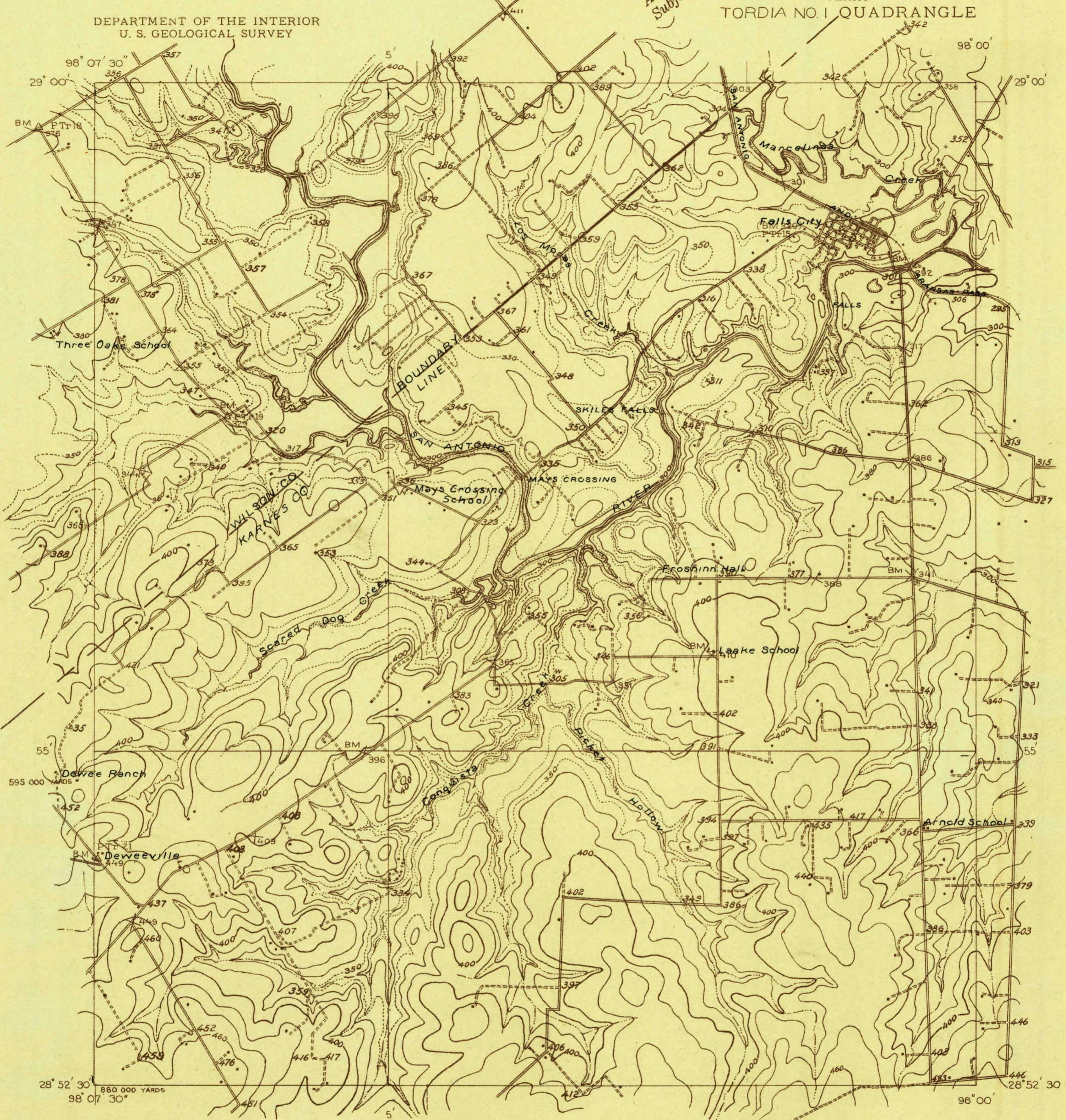

Topography by R.H. Reineck and J.T. Schultz
Culture and drainage in part from aerial photographs
from Air Service, U. S. Army
Control in part by U. S. Coast and Geodetic Survey
Surveyed in 1925

Polyconic projection. North American datum
5000 yard grid based upon U. S. zone system, D

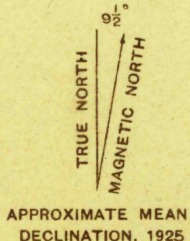
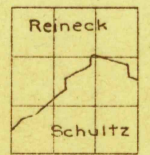
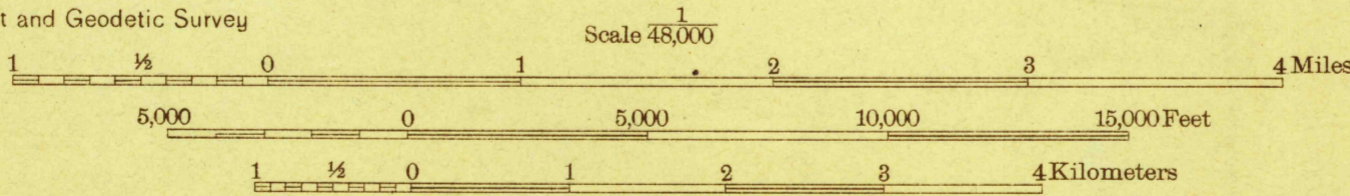

Contour interval 20 feet
10 foot contours in dashed lines
Datum is mean sea level

TORDIA NO. 1, TEX.

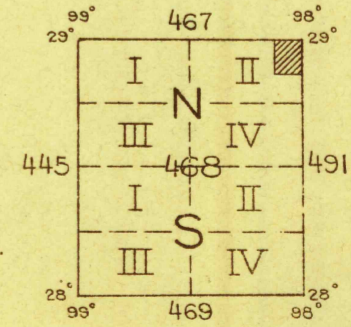

RETURN TO:
USGS OLD HISTORICAL MAP ARCHIVES

U. S. G. S.
FILE COPY
Inspection and Editing.