

# TOPOGRAPHY

DEPARTMENT OF THE INTERIOR  
 ALBERT B. FALL, SECRETARY  
 U.S. GEOLOGICAL SURVEY  
 GEORGE OTIS SMITH, DIRECTOR

THE UNIVERSITY OF TEXAS  
 R.E. VINSON, PRESIDENT  
 BUREAU OF ECONOMIC GEOLOGY AND TECHNOLOGY  
 J.A. UDDEN, DIRECTOR

TEXAS  
 BIG LAKE QUADRANGLE

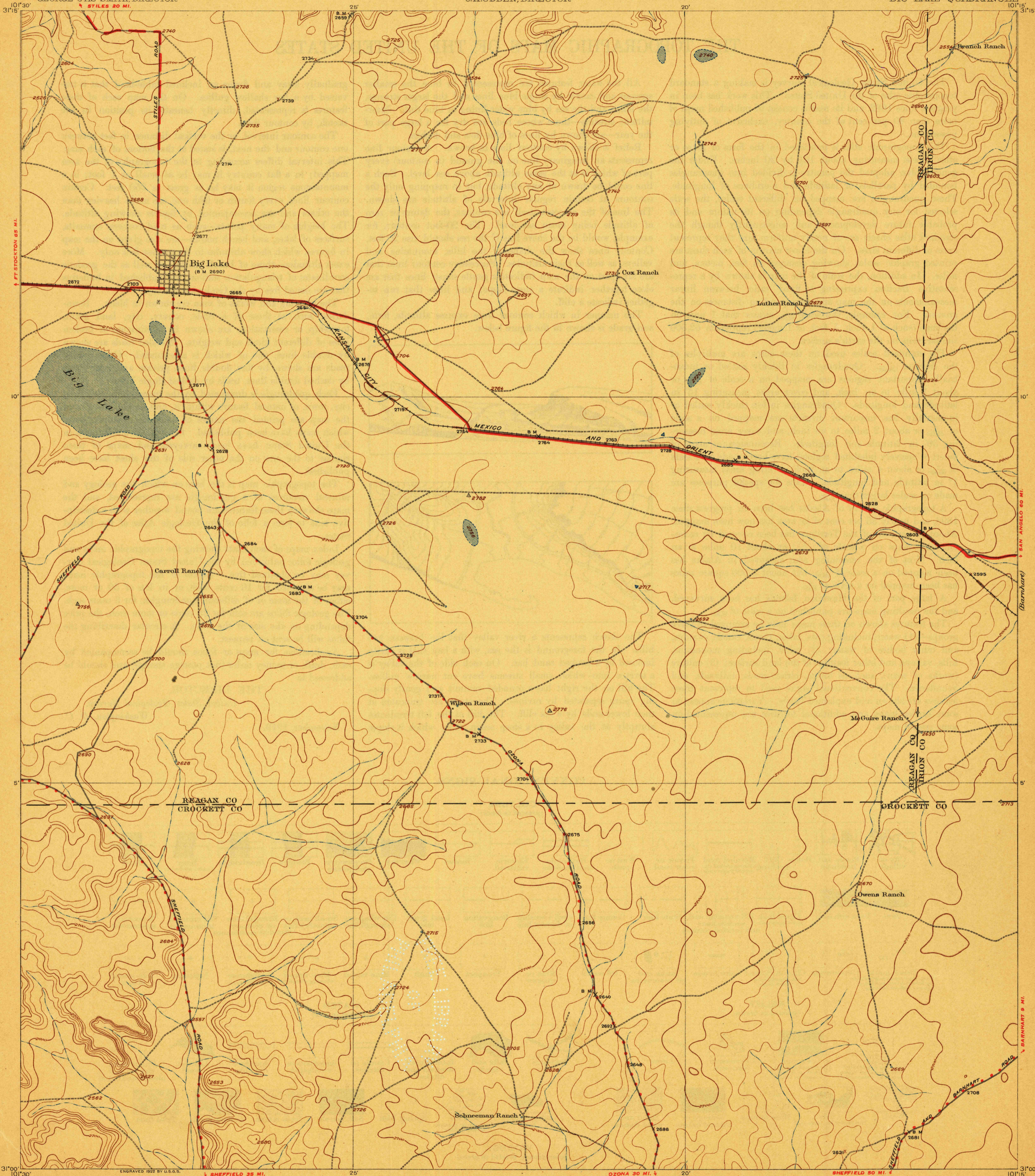

ENGRAVED 1922 BY U.S.G.S.

C. H. Birdseye, Chief Topographic Engineer.  
 T. G. Gerdine, Topographic Engineer in charge.  
 Topography by S. T. Penick and T. F. Murphy.  
 Control by R. M. Wilson and E. E. Harris.  
 Surveyed in 1920.

SURVEYED IN COOPERATION WITH THE UNIVERSITY OF TEXAS.

Penick  
 Murphy

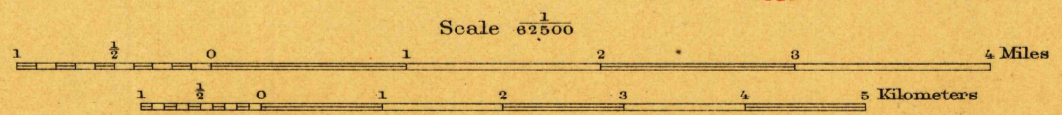

Contour interval 25 feet.  
 Datum is mean sea level.

APPROXIMATE MEAN DECLINATION 1920

Polyconic projection, North American datum.  
 THROUGH ROUTES (STANDARD)  
 THROUGH ROUTES (NOT STANDARD)  
 SECONDARY ROUTES

BIG LAKE  
 Edition of 1922.