

ADVANCE SHEET  
512-N-III-W/2

CORPS OF ENGINEERS, U. S. ARMY  
PROGRESSIVE MILITARY MAP

TEXAS  
MART



(Waco 1:125000)

(Waco 1:125000)

(512-N-III-E/2)

(Temple 1:125000)

Prepared under the direction of Col. W. P. Stokely,  
Corps of Engineers, U.S.A., Department Engineer,  
Southern Department, 1919.  
Compiled from Railroad Alignments and Profiles,  
and County Road Maps.  
Completed under the direction of Major W. G. Caples,  
Corps of Engineers, July and August, 1919.

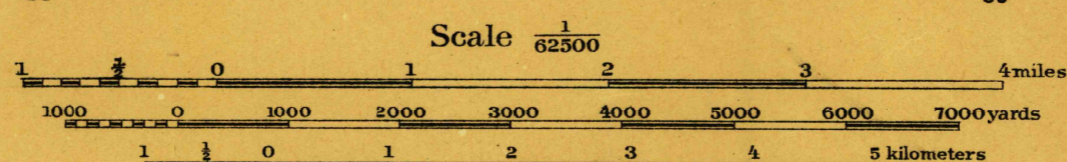

Contour Interval 20 feet  
Datum is mean sea level

NOTE: OFFICERS USING THIS MAP WILL MARK HEREON CORRECTIONS AND ADDITIONS WHICH COME TO THEIR ATTENTION AND MAIL DIRECT TO THE CHIEF OF ENGINEERS, WASHINGTON, D.C.

Engineer Reproduction Plant, U. S. Army, Washington Barracks, D.C.

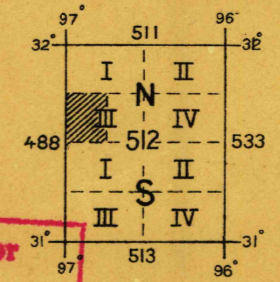

TRUE NORTH  
MAGNETIC NORTH  
APPROXIMATE MEAN  
DECLINATION 1920

U. S. Dept. of Interior  
Div. of Geography  
Class 630 CE 1919

RETURN TO:  
USGS AND HISTORICAL MAP ARCHIVES

MART, TEX.