

Mapped, edited, and published by the Geological Survey  
Control by USGS and NOS/NOAA  
Topography by photogrammetric methods from aerial photographs taken 1970. Field checked 1972  
Projection and 10,000-foot grid ticks: Utah coordinate system, central zone (Lambert conformal conic)  
1000-meter Universal Transverse Mercator grid ticks, zone 12, shown in blue.  
Fine red dashed lines indicate selected fence lines  
Where omitted, land lines have not been established  
To place on the predicted North American Datum 1983 move the projection lines 10 meters north and 71 meters east as shown by dashed corner ticks

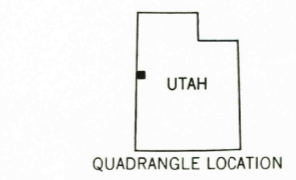
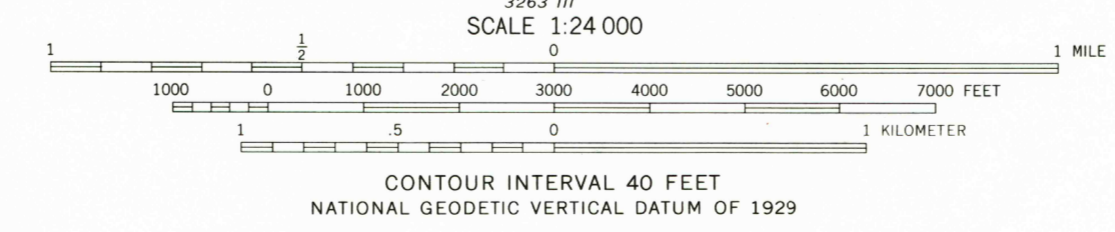
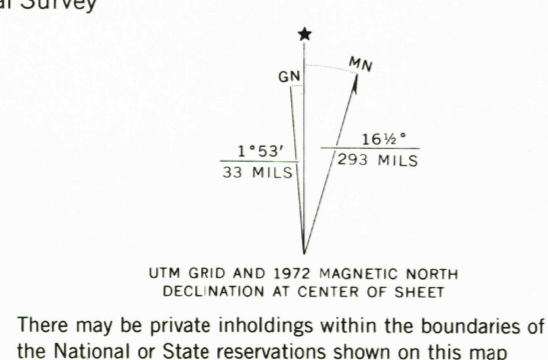

ROAD CLASSIFICATION

Primary highway, hard surface	Light duty road, hard or improved surface
Secondary highway, hard surface	Unimproved road
Interstate Route	U. S. Route
	State Route

THIS MAP COMPLIES WITH NATIONAL MAP ACCURACY STANDARDS  
FOR SALE BY U. S. GEOLOGICAL SURVEY, DENVER, COLORADO 80225, OR RESTON, VIRGINIA 22092  
A FOLDER DESCRIBING TOPOGRAPHIC MAPS AND SYMBOLS IS AVAILABLE ON REQUEST

IBAPAH PEAK, UTAH  
N3945-W11352.5/7.5  
1972  
DMA 3263 IV SW-SERIES V897

AUG 16 1982

RETURN TO:  
USGS AND HISTORICAL MAP ARCHIVES

1900