

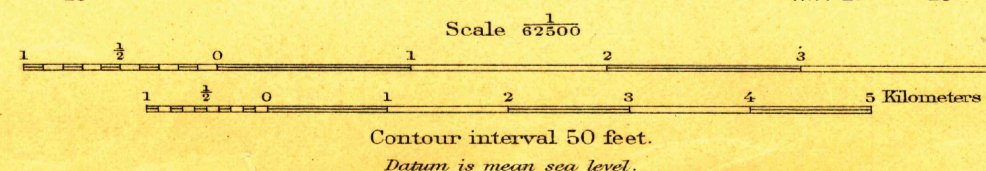

R.B. Marshall, Chief Geographer.  
T.G. Gerdine, Geographer in charge.  
Topography by T.M. Bannon, S.P. Floore,  
and E.P. Davis.  
Control by Coast and Geodetic Survey,  
T.M. Bannon, and L.F. Biggs.  
Surveyed in 1910-1911 and 1913.

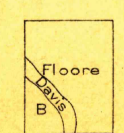

USGS  
Historical File  
Topographic Division

Edition of Jan. 1915.

APR 30 1915 3508

SUNNYSIDE, Utah.

U.S.G.S.  
FILE COPY