

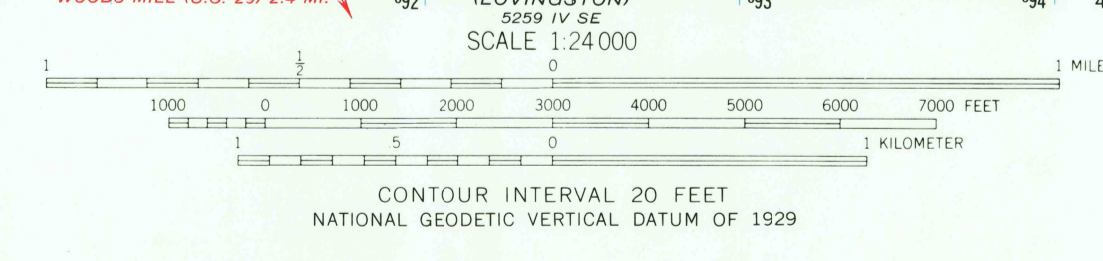

Mapped, edited, and published by the Geological Survey  
Control by USGS and USC&GS  
Topography by photogrammetric methods from aerial photographs  
taken 1967. Field checked 1967  
Polyconic projection. 10,000-foot grid ticks based on Virginia coordinate  
system, south zone. 1000-meter Universal Transverse Mercator grid ticks,  
zone 17, shown in blue. 1927 North American Datum.  
To place on the predicted North American Datum 1983 move the  
projection lines 10 meters south and 23 meters west  
as shown by dashed corner ticks  
Fine red dashed lines indicate selected fence and field lines where  
generally visible on aerial photographs. This information is unchecked  
There may be private inholdings within the boundaries of the  
National or State reservations shown on this map

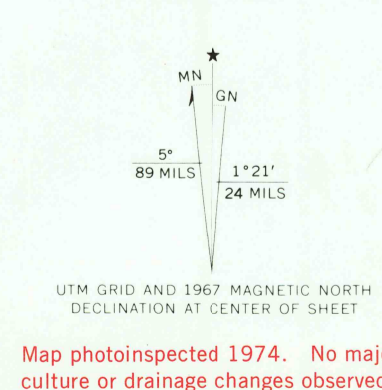

THIS MAP COMPLIES WITH NATIONAL MAP ACCURACY STANDARDS  
FOR SALE BY U.S. GEOLOGICAL SURVEY, RESTON, VIRGINIA 22092  
AND VIRGINIA DIVISION OF MINERAL RESOURCES, CHARLOTTESVILLE, VIRGINIA 22903  
A FOLDER DESCRIBING TOPOGRAPHIC MAPS AND SYMBOLS IS AVAILABLE ON REQUEST



ROAD CLASSIFICATION	
Primary highway, all weather, hard surface	Light-duty road, all weather, improved surface
Secondary highway, all weather, hard surface	Unimproved road, fair or dry weather
State Route	

GREENFIELD, VA.  
N3752.5—W7845/7.5  
PHOTOINSPECTED 1974  
1967  
AMS 5259 IV NE—SERIES B754

NOV 12 1981

RETURN TO:  
USGS AND HISTORICAL MAP ARCHIVES

2650