



A.M.S. V501

AMS 1, 1947

Prepared under the direction of the Chief of Engineers by the Army Map Service (AMS), Corps of Engineers, Department of the Army, Washington, D. C. Compiled in 1947 from United States Quadrangles, 1:25,000, 1:62,500 and 1:125,000 Corps of Engineers and U. S. Geological Survey, 1891-1945. Intelligence data, 1946. Planimetric detail revised by photo-planimetric methods. Aerial photography 1936-44. Road, Railroad and Aeronautical data verified by state authorities, 1947. Control by U. S. Coast and Geodetic Survey.

Scale 1:250,000

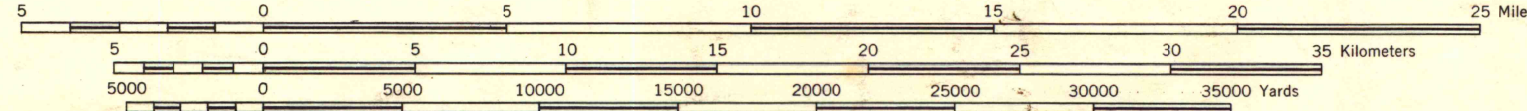

CONTOUR INTERVAL 100 FEET

DATUM IS MEAN SEA LEVEL

TRANSVERSE MERCATOR PROJECTION

1927 NORTH AMERICAN DATUM

TEN THOUSAND METER UNIVERSAL TRANSVERSE MERCATOR GRID, ZONE 17

GRAY NUMBERED TICKS INSIDE THE NEATLINE INDICATE THE 1000 YARD U. S. POLYCONIC GRID, ZONE 8

THE LAST FOUR DIGITS OF THE GRID NUMBERS ARE OMITTED

1944 MAGNETIC DECLINATION FOR THIS SHEET VARIES FROM 27°11' WESTERLY FOR THE CENTER OF THE WEST EDGE TO 27°10' WESTERLY FOR THE CENTER OF THE EAST EDGE. NEAR ANNUAL CHANGE IS NEGLIGIBLE

USUAL WARNING SIGNS OR CHANGES ON THIS MAP ARE SHOWN IN RED AND SHOWN DIRECTLY TO COMMANDING OFFICER, ARMY MAP SERVICE, WASHINGTON, D. C. MAPS SO FORWARDED WILL BE RETURNED OR REPLACED IF DESIRED.

LEGEND		ROAD DATA 1947	
POPULATED PLACES	Small: Large built-up area	Hard surface, heavy duty road, more than two lanes wide	3 LANES & LARGER
500,000 or over		Hard surface, heavy duty road, two lanes wide	2 LANES & LARGER
100,000 to 500,000		Hard surface, medium duty road, more than two lanes wide	2 LANES & LARGER
25,000 to 100,000		Hard surface, medium duty road, two lanes wide	2 LANES & LARGER
5,000 to 25,000		Loose surface, graded and drained road	
1,000 to 5,000		Old Dominion Dirt road, Trail	
1,000 or less		Stowell Route markers: Federal; State	
RAILROADS	Standard gauge	Single track	
		Multiple track	
	Narrow gauge	Woodland	
BOUNDARIES	International	Principal navigation light	Falls; Rapids
	State	Military or commercial airfield	Intermittent stream
	County	Park and reservation	Swamp, marsh
		Auxiliary airfield	Reef; Limit of danger line
		Horizontal control point	Rocks awash; Wharf, pier
		Spot elevation in feet	Seaplane base
			Foreshore flat
			Seaplane anchorage

INDEX TO BOUNDARIES

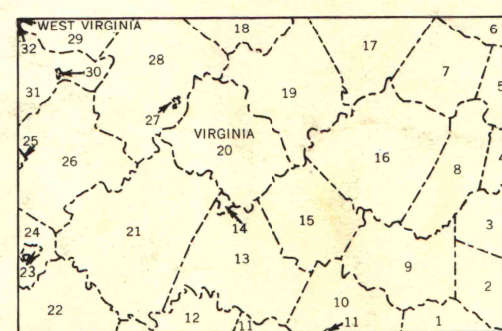

Virginia Counties	
1. Loudoun	12. Pittsylvania
2. Netley	13. Campbell
3. Amelia	14. Lynchburg (Free City)
4. Powhatan	15. Appomattox
5. Gloucester	16. Buchanan
6. Louisa	17. Albemarle
7. Fluvanna	18. Augusta
8. Cumberland	19. Nelson
9. Prince Edward	20. Amherst
10. Charlotte	21. Bedford
11. Halifax	22. Franklin
	23. Roanoke (Free City)
	24. Roanoke
	25. Craig
	26. Botetourt
	27. Buena Vista (Free City)
	28. Rockingham
	29. Bath
	30. Clinch Forge (Free City)
	31. Alleghany
	32. West Virginia Counties

LOCATION DIAGRAM FOR NJ 17-9

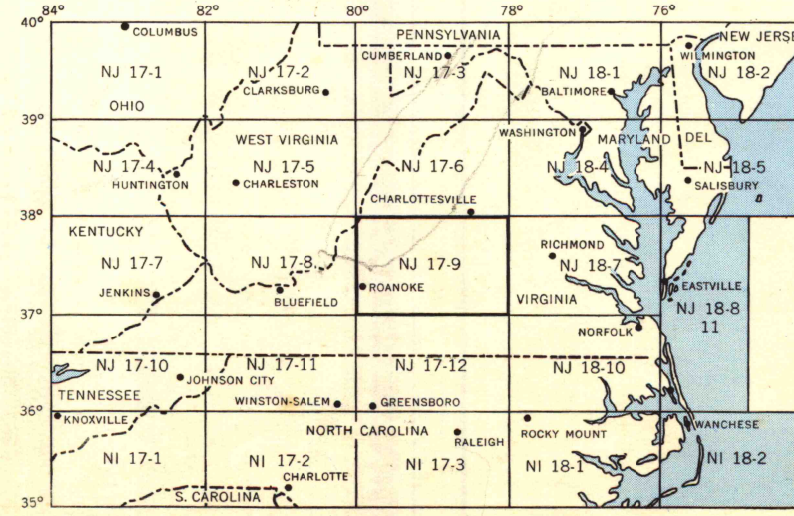

COVERAGE DIAGRAM

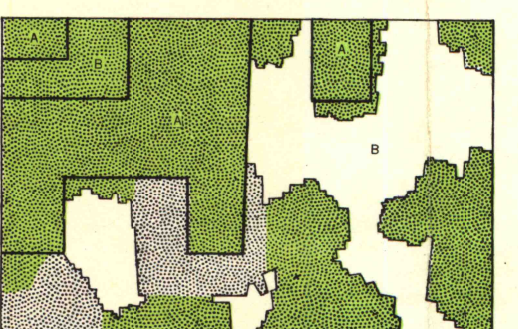

COMPILATION METHOD

Photo-aerial
Photo-planimetric

Areas for which woodblock information is available

A. Large scale topographic maps, 1:50,000-1:250,000, reliability good.
B. Medium scale topographic maps, 1:50,000-1:250,000, reliability fair.
Dates of aerial photography, 1936-44.

MAP AND AIR PHOTO LIBRARY
University of Wisconsin

ROANOKE, UNITED STATES
N3700W7800/100x200
UNIVERSITY OF WISCONSIN