

(FARMVILLE)
1:125,000

VIRGINIA 1:31,680

WAR DEPARTMENT
CORPS OF ENGINEERS, U. S. ARMY

AMELIA QUADRANGLE
7.5 MINUTE SERIES

(CLAYVILLE)

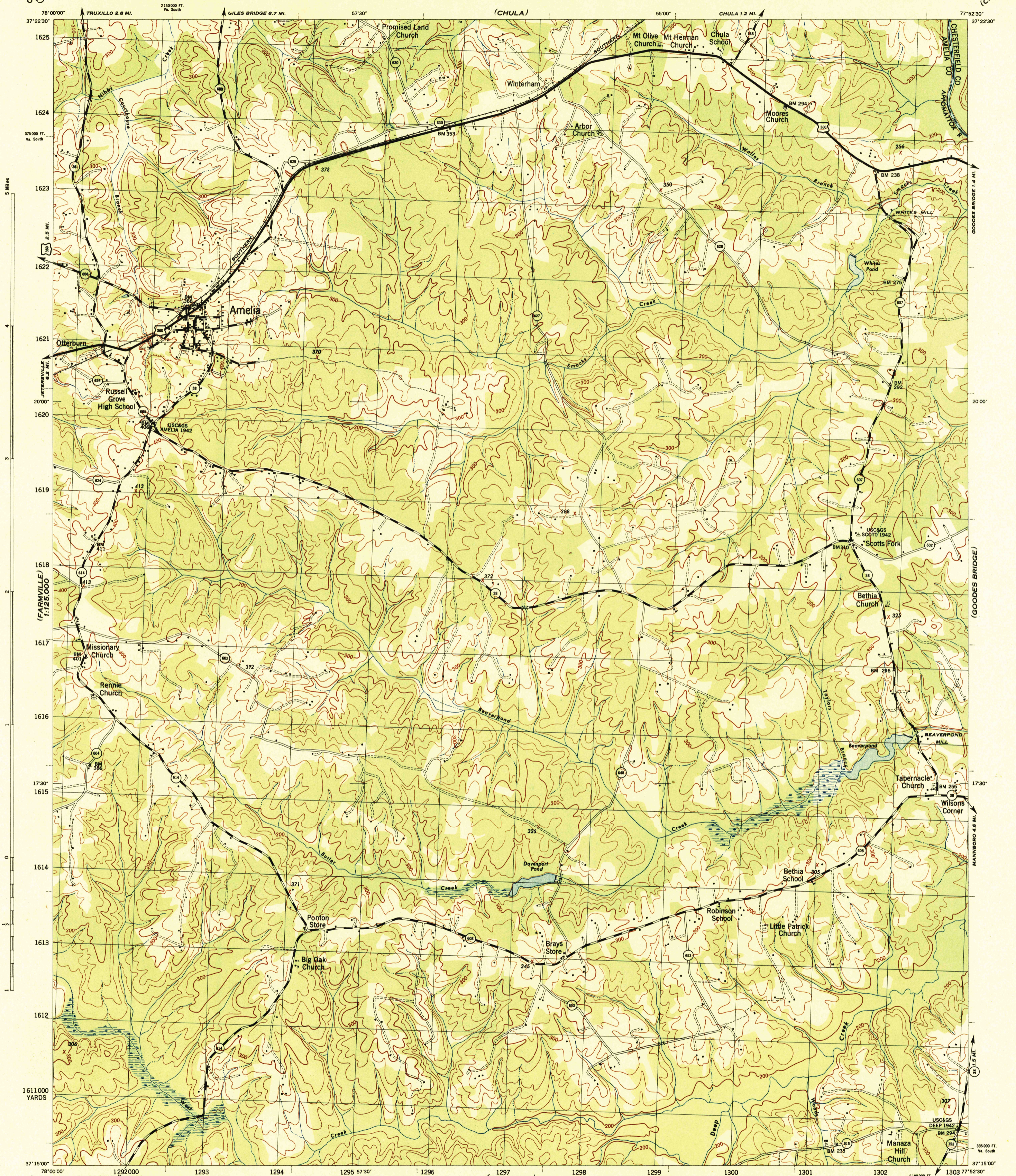

(FARMVILLE)
1:125,000

Prepared by U. S. Department of Agriculture, Soil Conservation Service,
under the direction of the Chief of Engineers, U. S. Army, 1943.
Horizontal and vertical control by U. S. Coast and Geodetic Survey, U. S. Geological Survey, and S. C. S., 1943.
Topography by S. C. S., 1943. Wide-angle photography by S. C. S., 1942.
Polyconic projection, North American datum, 1927.
This map complies with the National standard map accuracy requirements.

ROAD CLASSIFICATION 1943

Dependable hard-surface, heavy-duty road ——— U. S. Route 286
Loose-surface graded, dry-weather road ——— U. S. Route 286
Secondary, hard-surface, all-weather road ——— State Route 602
Unimproved road ——— State Route 602
More than two lanes indicated by note along road with tick at point of change 3 LANE 2 LANE

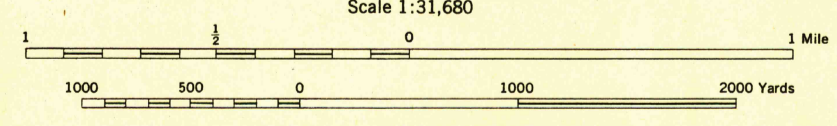

**CONTOUR INTERVAL 20 FEET
DATUM IS MEAN SEA LEVEL**

ONE THOUSAND YARD GRID COMPUTED FROM "GRID SYSTEM FOR PROGRESSIVE MAPS IN THE U. S. ZONE B, U. S. C. & G. S. SPECIAL PUBLICATION NO. 59" THE LAST THREE DIGITS OF THE GRID NUMBERS ARE OMITTED.

VIRGINIA STATE GRID, SOUTH ZONE, IS INDICATED BY DOTTED TICKS OUTSIDE THE NEAT LINE AT 5000 FOOT INTERVALS.

NOTE: OFFICERS USING THIS MAP WILL MARK HEREON CORRECTIONS AND ADDITIONS WHICH COME TO THEIR ATTENTION AND MAIL DIRECT TO "THE CHIEF OF ENGINEERS, WASHINGTON, D. C."

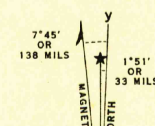

AMELIA, VA.
N3715-W7752.5/7.5

USGS
Historical File
Topographic Division