

(ANNANDALE)

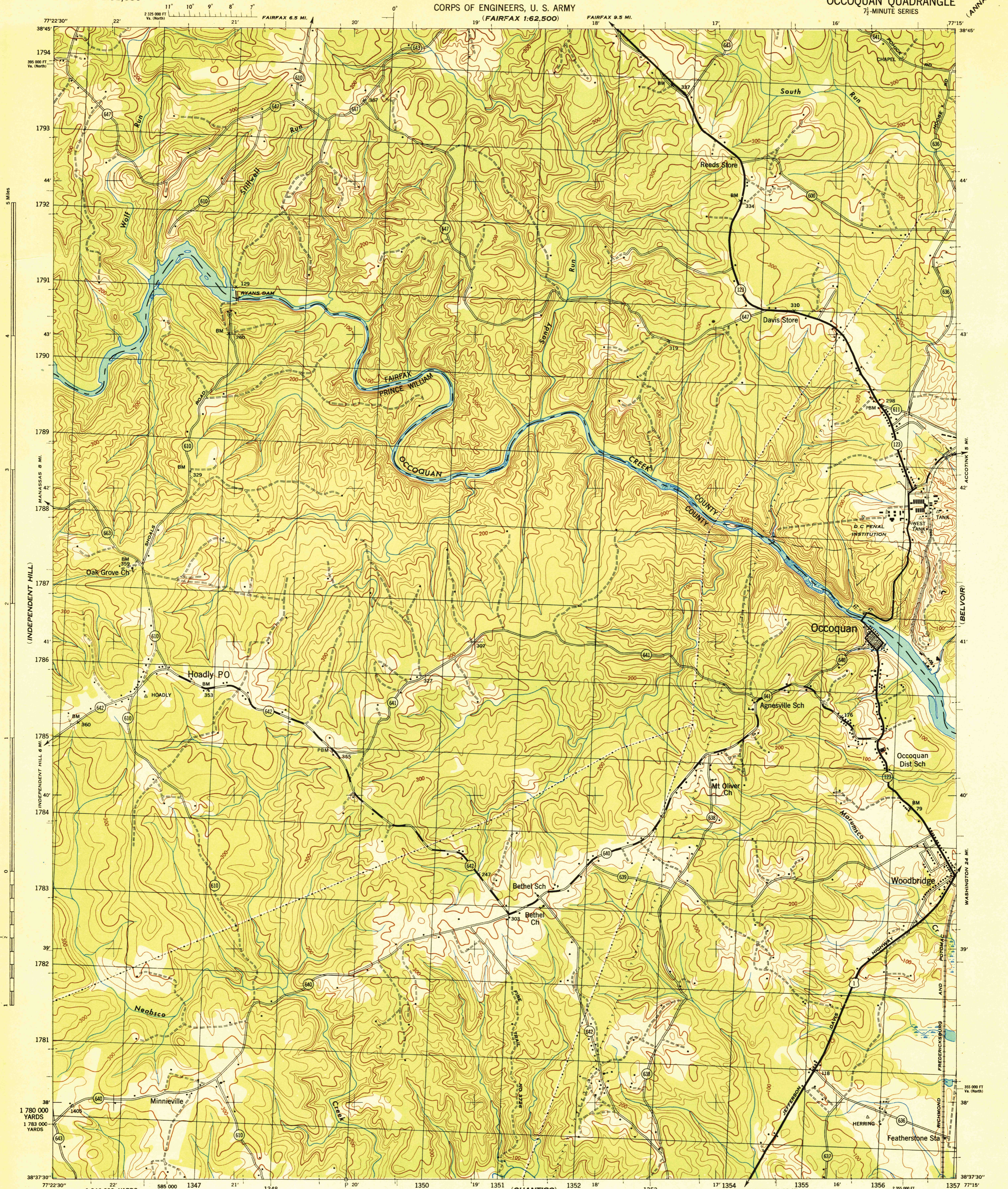

5 Miles
4
3
2
1
0
1
2
3
4
5 Miles

MANASSAS 6 MI.
INDEPENDENT HILL 6 MI.
WASHINGTON 24 MI.
INDIAN HEAD

Prepared under direction of the Chief of Engineers, U. S. Army, 1944.
By the Mapping Section, Office Division Engineer, South Atlantic Division.
Control by Corps of Engineers, U. S. Geological Survey, U. S. Coast and Geodetic Survey and U. S. Soil Conservation Service.
Topography by Stereophotogrammetric methods (Multiplex).
Aerial photography by 1st Mapping Group, U. S. Army, 1943.
Polyconic projection, 1927 North American datum.

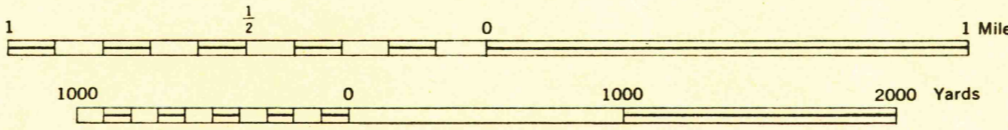

CONTOUR INTERVAL 20 FEET
DATUM IS MEAN SEA LEVEL

ONE THOUSAND YARD GRID COMPUTED FROM GRID SYSTEM FOR PROGRESSIVE MAPS
IN THE U. S. ZONE B U. S. G. & G. S. SPECIAL PUBLICATION NO. 99
THE LAST THREE DIGITS OF THE GRID NUMBERS ARE OMITTED
THE OVERLAPPING GRID ZONE A IS INDICATED BY SHORT BROKEN TICKS CROSSING THE NEAT LINE
VIRGINIA THREE AND NORTH ZONE B IS INDICATED BY DOTTED TICKS
OUTSIDE THE NEAT LINE AT 500 FOOT INTERVALS
NOTE: OFFICERS USING THIS MAP WILL MAKE PERSON CORRECTIONS AND ADDITIONS WHICH COME
TO THEIR ATTENTION AND MAIL DIRECT TO THE CHIEF OF ENGINEERS, WASHINGTON, D. C.

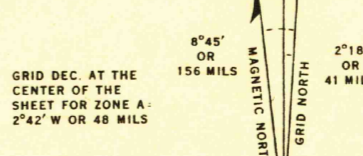

Use diagram only to obtain numerical values.
To determine magnetic north line connect the pivot
point "P" on the south edge of the map with the value of
the angle between grid and magnetic north, as plotted
on the degree scale of the north edge of the map.

ROAD CLASSIFICATION 1943
Dependable hard-surface, heavy-duty road. U. S. Route 1
Secondary, hard-surface, all-weather road. State Route 25
Loose surface graded, dry-weather road.
Dirt Road.
3 LANE, 4 LANE
More than two lanes indicated by note along road with tick at point of change.

THIS MAP COMPLIES WITH THE NATIONAL STANDARD MAP ACCURACY REQUIREMENTS.

HISTORICAL FILES
(DO NOT REMOVE)

OCOQUAN, VA.
N3837.5-W7715/7.5
EDITION OF 1944