

DEPARTMENT OF THE INTERIOR
FRANKLIN K. LANE, SECRETARY
U. S. GEOLOGICAL SURVEY
GEORGE OTIS SMITH, DIRECTOR

WAR DEPARTMENT
CORPS OF ENGINEERS, U. S. ARMY

STATE OF VIRGINIA
GEOLOGICAL SURVEY
THOMAS L. WATSON, DIRECTOR

Advance sheet.
Subject to correction.

VIRGINIA
MCKENNEY QUADRANGLE



R. B. Marshall, Chief Geographer.
G. Gerdine, Geographer in charge.
Topography by W. J. Lloyd, F. B. Hatch, S. L. Parker,
J. C. Blackburn, and U. S. Grant.
Control by J. C. Fales, C. R. French, and S. L. Parker.
Surveyed in 1918-1919.

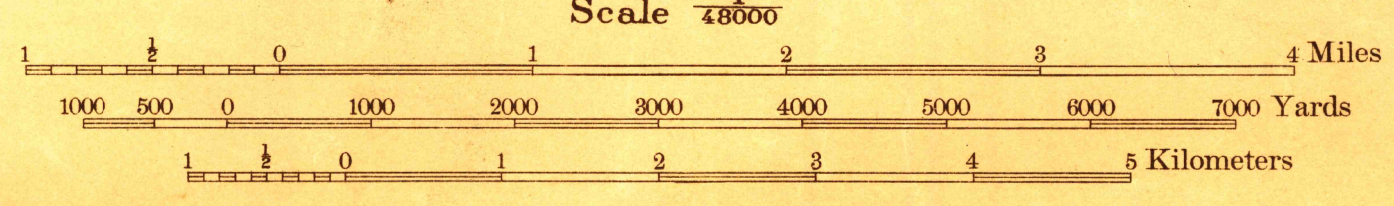
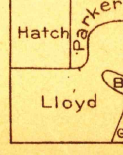

Contour interval 10 feet.
Datum is mean sea level.

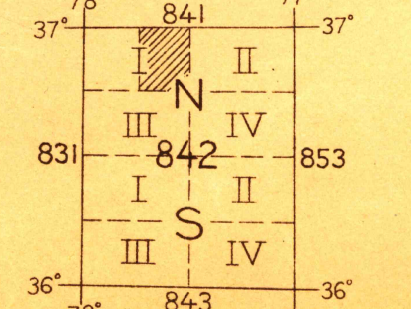

H. STOR. CAL. FILES
RETURN TO CENTRAL FILE
(DO NOT REMOVE)

MCKENNEY

APPROXIMATE MEAN
DECLINATION, 1918.