

Lewisburg
17500

DEPARTMENT OF THE INTERIOR
U. S. GEOLOGICAL SURVEY

818 S-1-W/2
STATE OF VIRGINIA
CONSERVATION AND DEVELOPMENT COMMISSION
VIRGINIA GEOLOGICAL SURVEY
ARTHUR C. BEVAN, STATE GEOLOGIST
(Eagle Rock)

Advance sheet
Subject to correction

VIRGINIA
ROANOKE QUADRANGLE

79°45' (Natural Bridge)
17500



Polygonic projection. North American datum
5000 yard grid based upon U. S. zone system, B

Albert Pike, Division Engineer
Topography by E. J. Ireland, Fred Graff, Jr.
J. M. Rawls, E. V. Holloway, A. G. England,
H. Levinson, W. A. Fisher, R. L. Marx,
S. Waggener, H. G. Warner, C. H. Price
W. H. Austin, E. H. Cummings
B. H. Yeaman and J. H. Lucett
Control by U. S. Geological Survey
Surveyed in 1928-1929

3°
TRUE NORTH
MAGNETIC NORTH
APPROXIMATE MEAN
DECLINATION, 1929

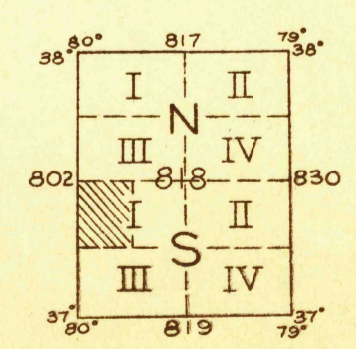
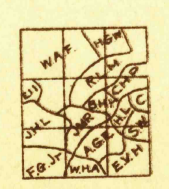
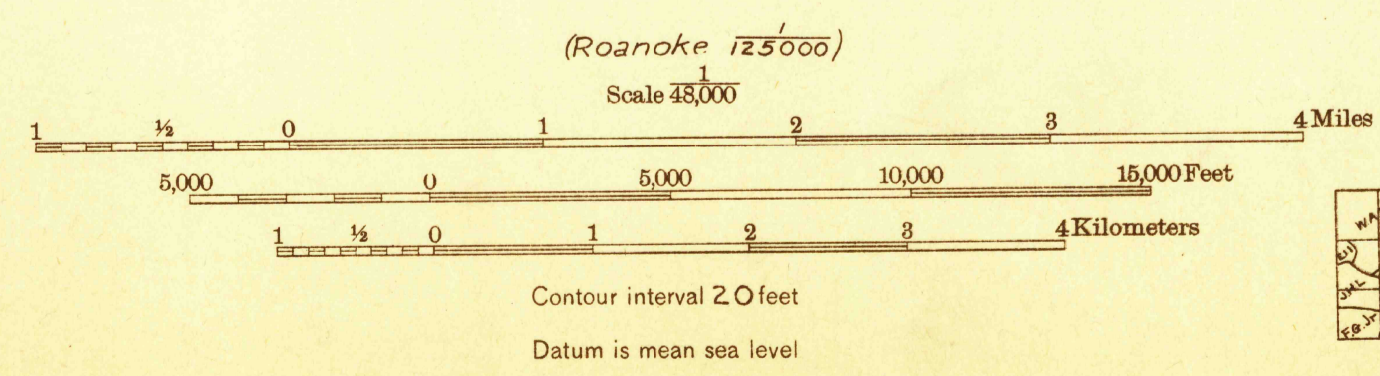

HISTORICAL FILES
(DO NOT REMOVE)
FILE COPY
RETURN TO CENTRAL FILE

ROANOKE, VA.