

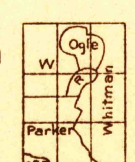

(Wilmington) 72° 45' 30" W
43° 00' N

Albert Pike, Division Engineer
Topography by J. M. Whitman, A. J. Ogle, Roscoe Reeves,
S. L. Parker and C. F. Fuechsel
Culture and drainage in part compiled from aerial photographs
taken by Air Corps, U. S. Army
Control by U. S. Geological Survey
and U. S. Coast and Geodetic Survey
Surveyed in 1926-1929-1930



APPROXIMATE MEAN
DECLINATION, 1980

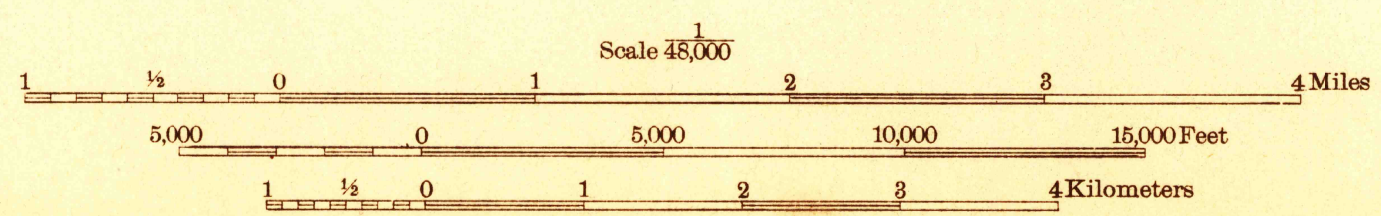

Contour interval 20 feet
Datum is mean sea level

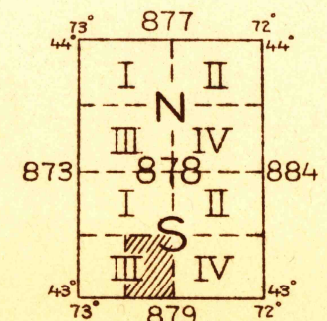

FILE COPY
RETURN TO CENTRAL FILE

SAXTONS RIVER, VT.

15 Miles
14
13
12
11
10
9
8
7
6
5
4
3
2
1
0
1
2
3
4
5
6
7
8
9
10
11
12
13
14
15

(Bellevue Falls)

(Brattleboro)

(Keene)