

Prepared under the direction of
Col. F. R. Shunk, Corps of Engineers, U.S.A.
Department Engineer, Northeastern Department,
Dec. 1918.
Compiled from Bear's Atlas and other data on
file in the office of the Department Engineer,
Northeastern Department.

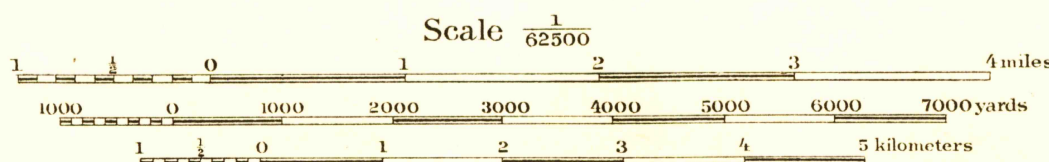

Contour Interval 20 feet
Datum is mean sea level

NOTE: OFFICERS USING THIS MAP WILL MARK HEREON CORRECTIONS AND ADDITIONS WHICH COME
TO THEIR ATTENTION AND MAIL DIRECT TO "THE CHIEF OF ENGINEERS, WASHINGTON, D.C."

Engineer Reproduction Plant, U. S. Army, Washington Barracks, D. C.
1920

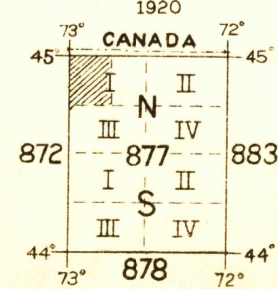

APPROXIMATE MEAN
DECLINATION 1920

FRANKLIN POND, VT.

(Now ENOSBURG FALLS)

*Remapped as Enosburg Falls (CS 1922)
(CE 194)*