

NOT MAPPED BY U. S. G. S. PRIOR TO 1904

Revised by
Sheet of military maps

ADVANCE SHEET 878-N-I-E-2

CONFIDENTIAL

VERMONT ROYALTON QUADRANGLE

CORPS OF ENGINEERS, U.S. ARMY
PROGRESSIVE MILITARY MAP

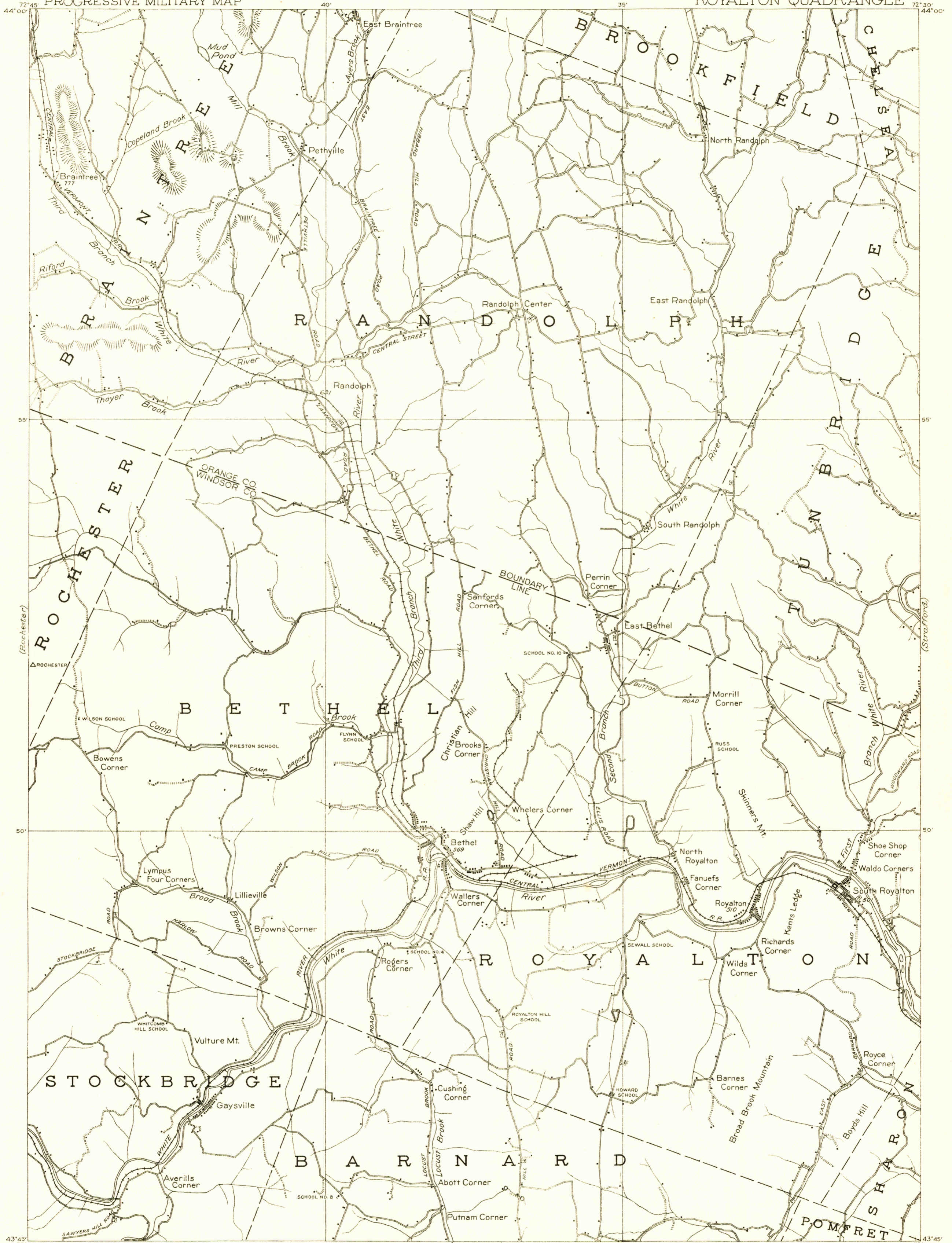

Compiled under the direction of
Col. Francis R. Shunk, Corps of Engineers, U.S.A.,
Department Engineer, Northeastern Department,
1919.

The authorities for this map are the Soil Map
of Windsor County, 1916, and Beers Atlas of
Orange County, 1877. With additional data
from Postal Route Maps, Windsor Co. 1901 & 1905,
& Orange Co. 1904 & 1908, and miscellaneous
Correspondence on file in the office of the
Department Engineer, Northeastern Department.

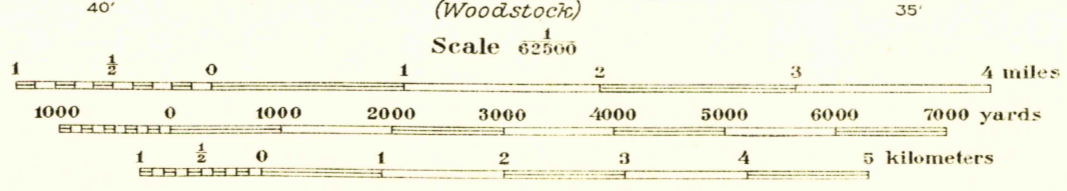

Datum is mean sea level

NOTE: OFFICERS USING THIS MAP WILL MARK HEREON CORRECTIONS AND ADDITIONS WHICH COME TO THEIR ATTENTION AND MAIL DIRECT TO THE CHIEF OF ENGINEERS, WASHINGTON D.C.

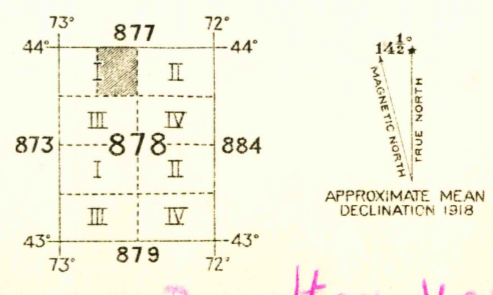

Royalton, Vermont