

UNITED STATES
DEPARTMENT OF THE INTERIOR
GEOLOGICAL SURVEY

FREDERICKSON QUADRANGLE
WASHINGTON-PIERCE CO.
7.5 MINUTE SERIES (TOPOGRAPHIC)

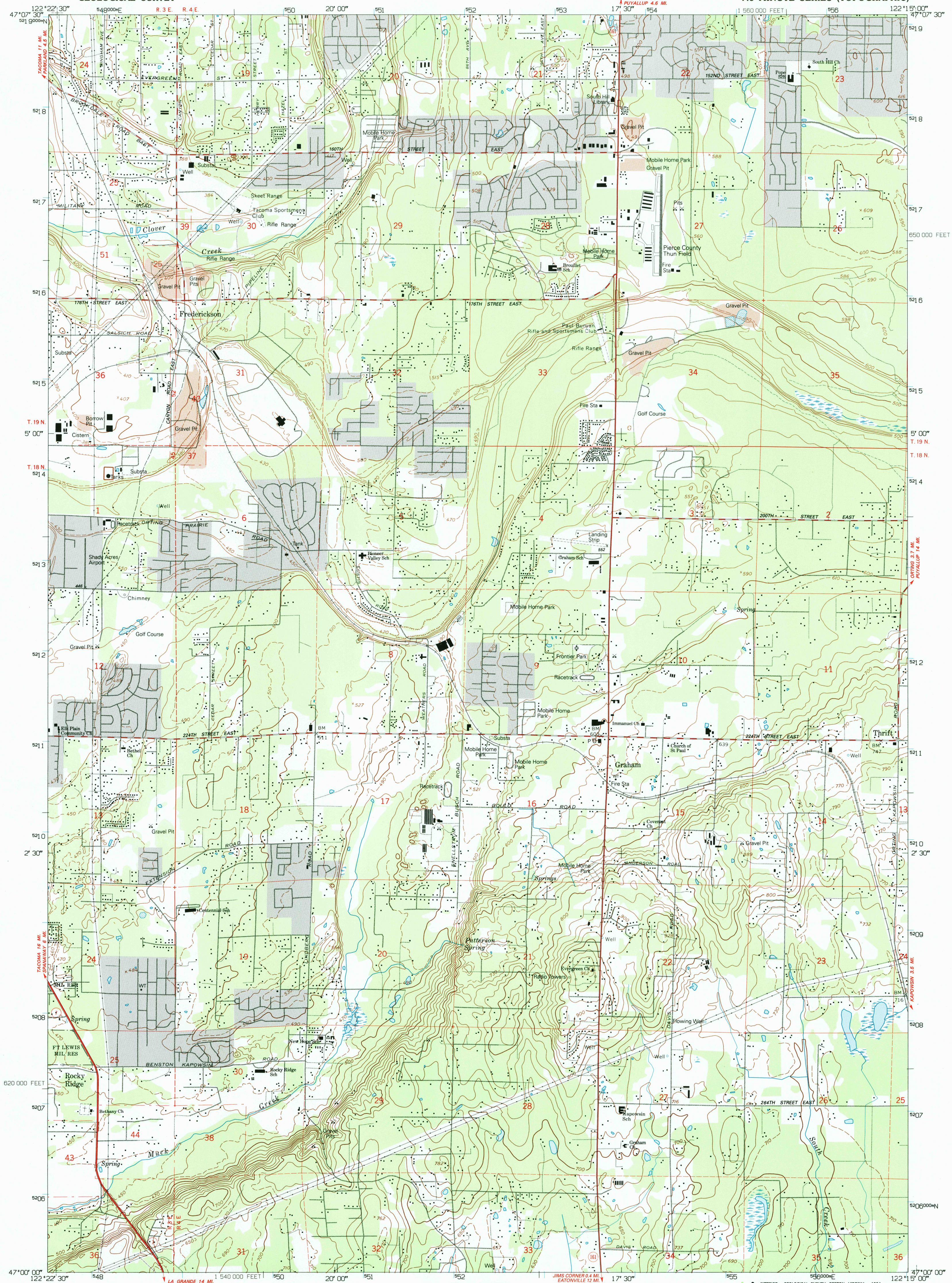

Produced by the United States Geological Survey
Control by USGS, NOS/NOAA and USCE
Compiled from aerial photographs taken 1957. Revised from
aerial photographs taken 1990 and other sources. Field checked
1993. Map edited 1994. Contours and land elevations have
not been revised and may conflict with other content
North American Datum of 1927 (NAD 27). Projection and
blue 1000-meter ticks: Universal Transverse Mercator, zone 10
10 000-foot ticks: Washington Coordinate System, south zone
North American Datum of 1983 (NAD 83) is shown by dashed
corner ticks. The values of the shift between NAD 27 and
NAD 83 for 7.5-minute intersections are obtainable from
National Geodetic Survey NADCON Software
Gray tint indicates areas in which only landmark buildings are
shown

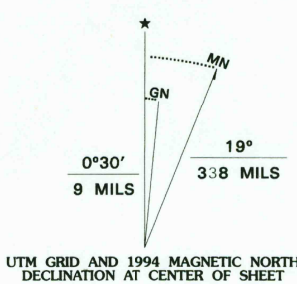

SCALE 1:24 000
1 000 000 2000 4000 6000 8000 10000
KILOMETERS
METERS
MILES
FEET
CONTOUR INTERVAL 20 FEET
SUPPLEMENTARY CONTOUR INTERVAL 10 FEET
NATIONAL GEODETIC VERTICAL DATUM OF 1929
TO CONVERT FEET TO METERS MULTIPLY BY 0.3048
TO CONVERT METERS TO FEET MULTIPLY BY 3.2808
THIS MAP COMPLIES WITH NATIONAL MAP ACCURACY STANDARDS
FOR SALE BY U.S. GEOLOGICAL SURVEY
DENVER, COLORADO 80225, OR RESTON, VIRGINIA 22092
A FOLDER DESCRIBING TOPOGRAPHIC MAPS AND SYMBOLS IS AVAILABLE ON REQUEST

ROAD CLASSIFICATION
Primary highway
Light-duty road, hard or
improved surface
Secondary highway
Unimproved road
Interstate Route
U.S. Route
State Route
QUADRANGLE LOCATION
WASHINGTON
1 2 3
4 5
6 7 8
1 Tacoma South
2 Puyallup
3 Sumner
4 Spanaway
5 Orting
6 Harts Lake
7 Tanwax Lake
8 Lake Kapowsin
FREDERICKSON, WA
47122-A3-TF-024
1959
REVISED 1994
DMA 1578 III SE-SERIES V891

USGS 1994 HISTORICAL
MAP ARCHIVES
OCT 25 1994
REC'D FILE COPY