

UNITED STATES
DEPARTMENT OF THE INTERIOR
GEOLOGICAL SURVEY

GRANT ORCHARDS QUADRANGLE
WASHINGTON—GRANT CO.
7.5 MINUTE SERIES (TOPOGRAPHIC)

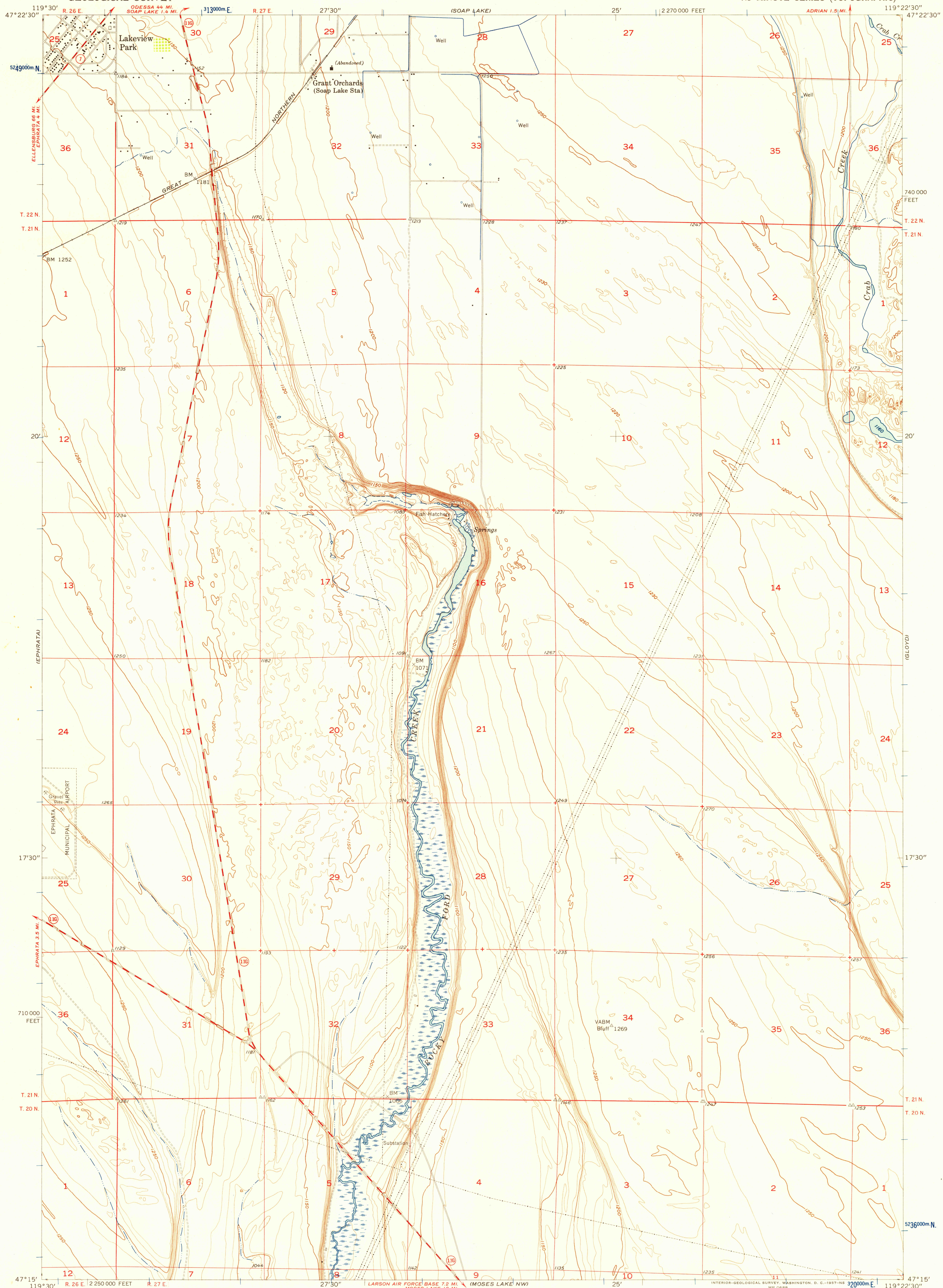

U.S.G.S.
FILE COPY
TOPOGRAPHIC DIVISION

U.S.G.S.
FILE COPY
TOPOGRAPHIC DIVISION

Maped, edited, and published by the Geological Survey
Control by USGS, USC&GS, and USBR

Culture and drainage compiled from aerial photographs
taken 1954. Topography from planetable surveys by
USBR 1937. Field check 1956

Polyconic projection. 1927 North American datum
10,000-foot grid based on Washington coordinate system,
south zone
1000-meter Universal Transverse Mercator grid ticks,
zone 11, shown in blue

TRUE NORTH
MAGNETIC NORTH
APPROXIMATE MEAN
DECLINATION, 1956

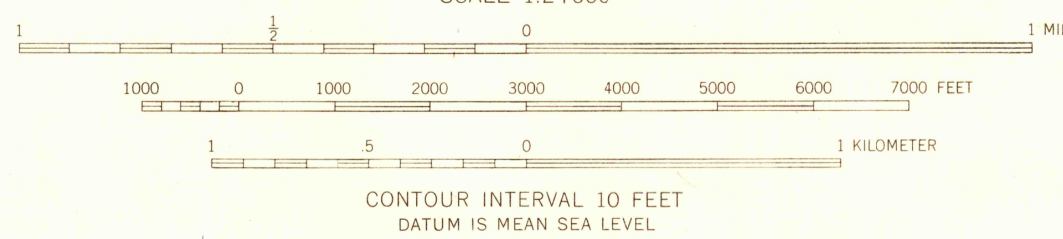

ROAD CLASSIFICATION
Medium-duty ——— Light-duty - - - - -
Unimproved dirt
State Route (O)

GRANT ORCHARDS, WASH.
N4715—W11922.5/7.5

1956

NOV 14 1957

19-5