

UNITED STATES
DEPARTMENT OF THE INTERIOR
GEOLOGICAL SURVEY

SIMS CORNER QUADRANGLE
WASHINGTON
7.5 MINUTE SERIES (TOPOGRAPHIC)

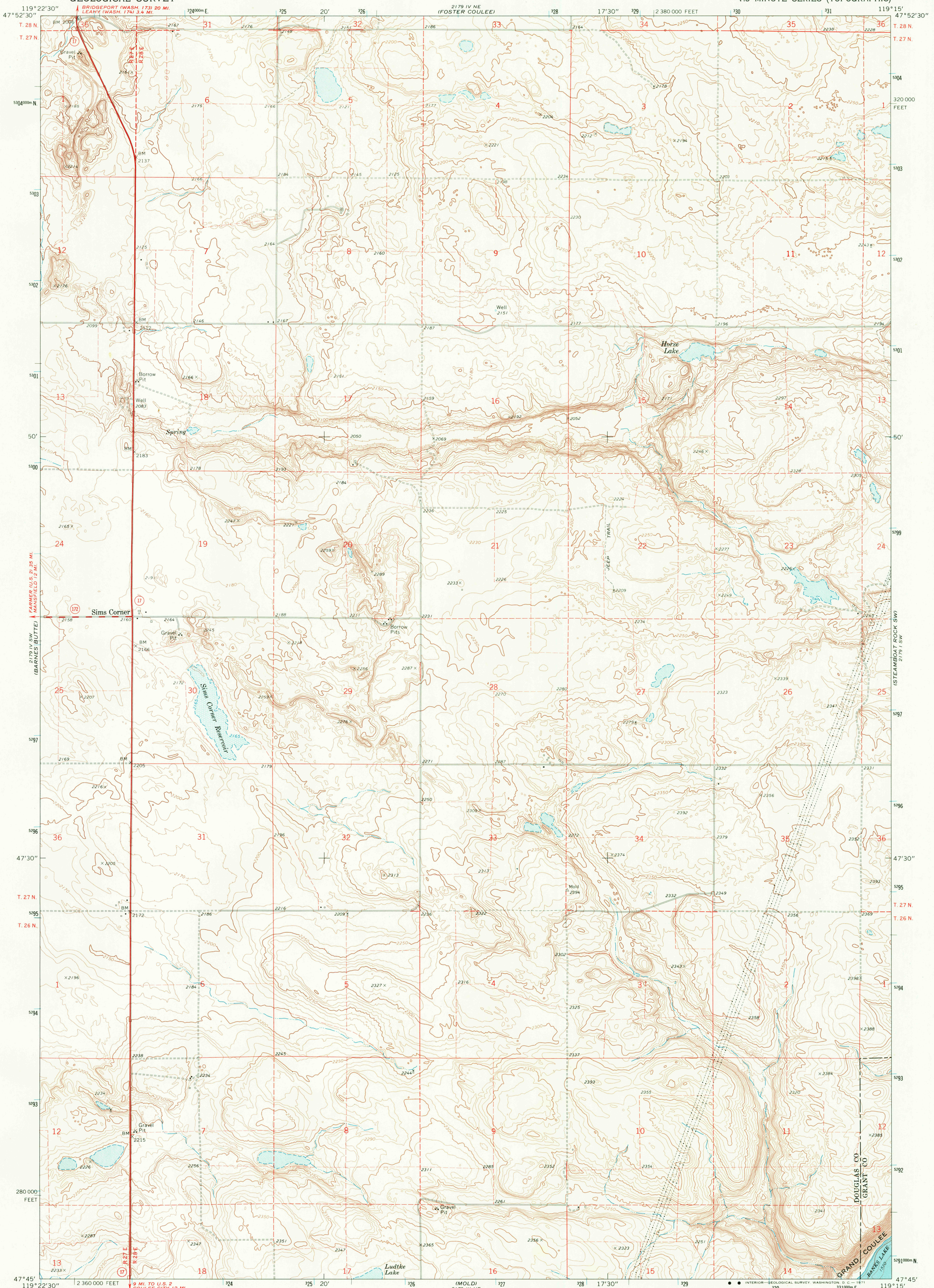

Mapped, edited, and published by the Geological Survey

Control by USGS and USC&GS

Topography by photogrammetric methods from aerial photographs taken 1967. Field checked 1968
Underwater contours by U. S. Bureau of Reclamation 1949 and 1950

Polyconic projection. 1927 North American datum
10,000-foot grid based on Washington coordinate system, north zone
1000-meter Universal Transverse Mercator grid ticks, zone 11, shown in blue

Fine red dashed lines indicate selected fence lines
Areas covered by dashed light-blue pattern are subject to controlled inundation

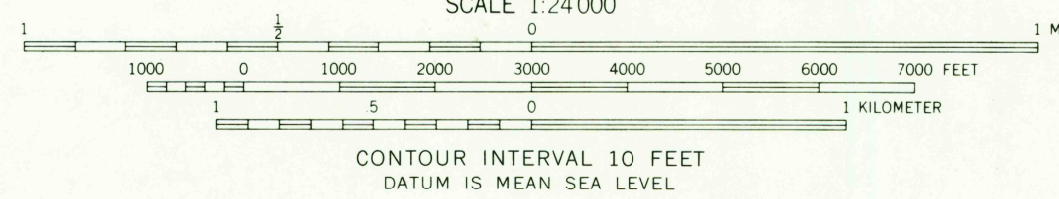
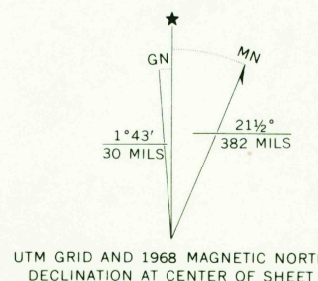

ROAD CLASSIFICATION

Heavy-duty	Light-duty
Medium-duty	Unimproved dirt
State Route	

SIMS CORNER, WASH.
N4745-W1915/7.5

1968

AMS 2179 IV SE—SERIES V891

AUG 10 1971

USGS
HISTORICAL FILE
TOPOGRAPHIC DIVISION