

Produced by the U.S. Geological Survey
Revised by the U.S. Forest Service
Topography compiled 1966. Planimetry derived from imagery taken 1994
Public Land Survey System and survey control current as of 1996. Partial
field check by U.S. Forest Service 1995
North American Datum of 1927 (NAD 27). Projection and 10 000-foot ticks:
Washington coordinate system, south zone (Lambert conformal conic)
Blue 1000-meter Universal Transverse Mercator ticks, zone 11
North American Datum of 1983 (NAD 83) is shown by dashed corner ticks
The values of the shift between NAD 27 and NAD 83 for 7.5-minute
intersections are obtainable from National Geodetic Survey NADCON software
Non-National Forest System lands within the National Forest
Inholdings may exist in other National or State reservations
This map is not a legal land line or ownership document. Public lands are
subject to change and leasing, and may have access restrictions; check
with local offices. Obtain permission before entering private lands

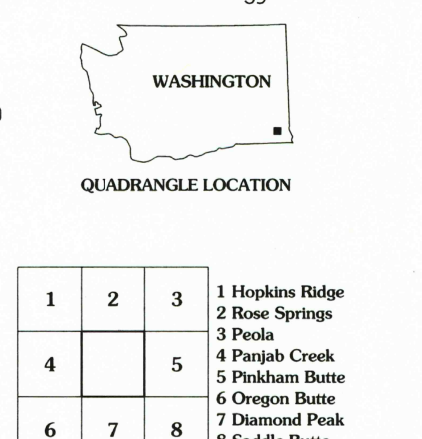
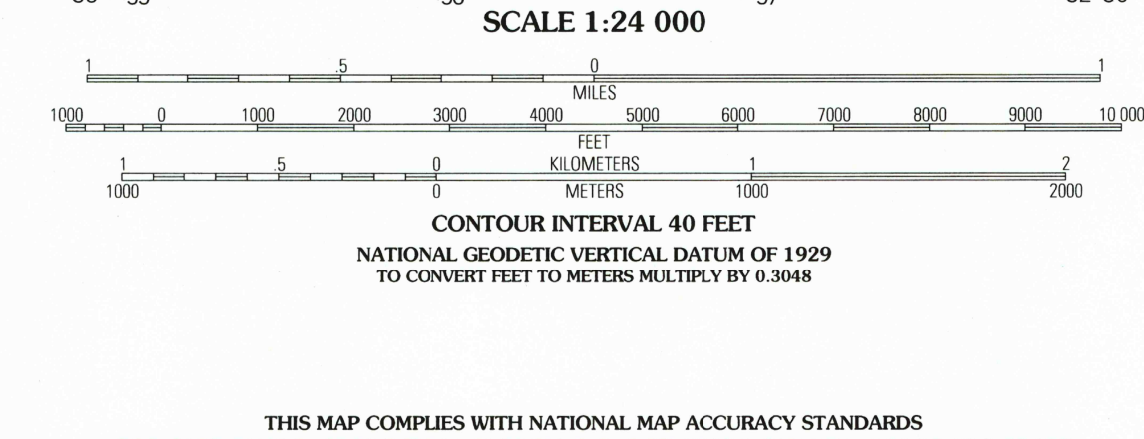
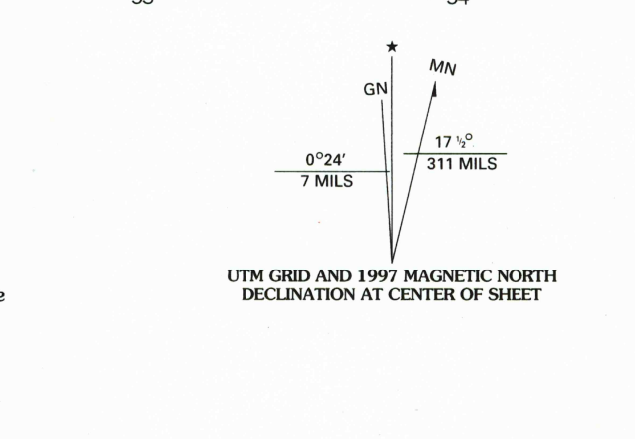

HIGHWAYS AND ROADS	
Interstate	1
U. S.	2
State	3
County	4
National Forest, suitable for passenger cars	5
National Forest, suitable for high clearance vehicles	6
National Forest Trail	7
Primary highway	8
Secondary highway	9
Light-duty road	10
Paved	11
Gravel	12
Dirt	13
Composition unspecified	14
Unimproved; 4 wheel drive	15
Trail	16
Gate	17

1	2	3
1 Hopkins Ridge	2 Rose Springs	3 Peaks
4 Panjab Creek	5 Pinkham Butte	6 Oregon Butte
7 Diamond Peak	8 Saddle Butte	

THIS MAP COMPLIES WITH NATIONAL MAP ACCURACY STANDARDS
FOR SALE BY U.S. GEOLOGICAL SURVEY, P.O. BOX 25286, DENVER, COLORADO 80225
A FOLDER DESCRIBING TOPOGRAPHIC MAPS AND SYMBOLS IS AVAILABLE ON REQUEST

STENTZ SPRING, WA
1995
DMA 2476 II NE - SERIES W891

RECEIVED
JAN 31 1999
USGS M&D
HISTORICAL MAP ARCHIVES

