

Produced by the United States Geological Survey 1987
Revision by USDA Forest Service 2004
Topography compiled 1967. Planimetry derived from imagery taken 1998 and other sources. Public Land Survey System and survey control current as of 2006. Boundaries current as of 2006.
North American Datum of 1983 (NAD 83). Projection and 1 000-meter grid: Universal Transverse Mercator, zone 10
2 500-meter ticks: Washington Coordinate System (north zone)
North American Datum of 1927 (NAD 27) is shown by dashed corner ticks. The values of the shift between NAD 83 and NAD 27 for 7.5-minute intersections are obtainable from National Geodetic Survey NADCON software.
Non-National Forest System lands within the National Forest
Inholdings may exist in other National or State reservations
This map is not a legal document. Public lands are subject to change and leasing, and may have access restrictions; check with appropriate offices. Obtain permission before entering private lands.

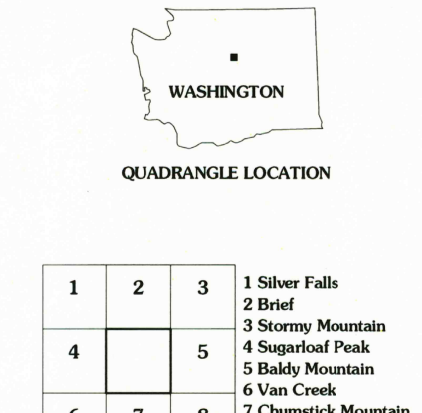
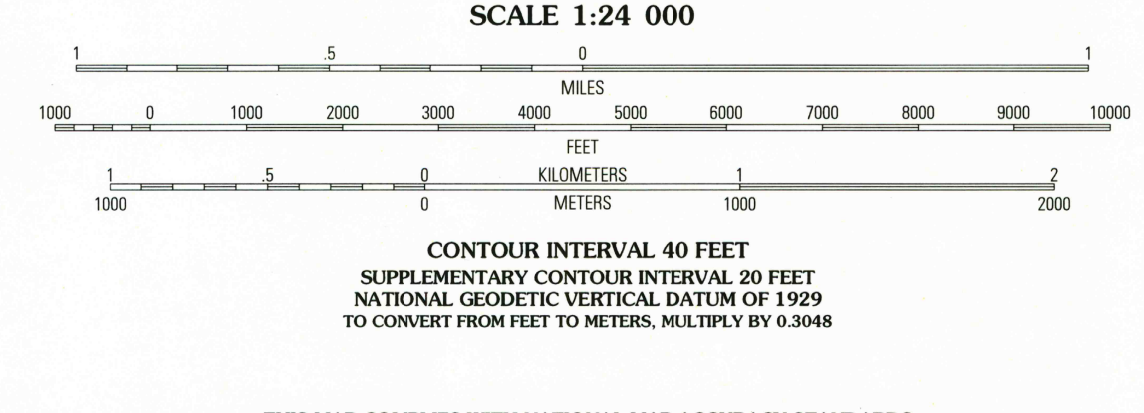
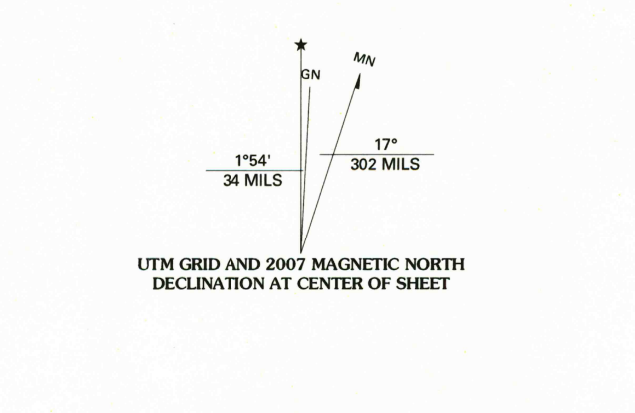

Interstate.....	(5)	Primary highway.....	(1)
U.S.	(10)	Secondary highway.....	(2)
State.....	(6)	Light-duty road.....	(3)
County.....	(8)	Composition: Unspecified.....	(4)
National Forest, suitable for passenger cars.....	(106)	Paved.....	(5)
National Forest, suitable for high clearance vehicles.....	(6)	Dirt.....	(6)
National Forest Trail.....	(304)	Unimproved; 4 wheel drive.....	(490)
		Trail.....	(491)
		Gate; Barrier.....	(492)

THIS MAP COMPLIES WITH NATIONAL MAP ACCURACY STANDARDS
FOR SALE BY U.S. GEOLOGICAL SURVEY, P.O. BOX 25286, DENVER, COLORADO 80225
A FOLDER DESCRIBING TOPOGRAPHIC MAPS AND SYMBOLS IS AVAILABLE ON REQUEST

USGS LIBRARY - RESTON
ADJOINING 7.5' QUADRANGLES

TYEE MOUNTAIN, WA
2004
47120-G4-TF-024
NGA 1979 IV SW-SERIES V891

ISBN 1-411-31359-3
9 781411 313590

3 1818 0053143 2