

U. S. G. S.
FILE COPY
Inspection and Editing.

UNITED STATES
DEPARTMENT OF THE INTERIOR
GEOLOGICAL SURVEY

STATE OF WASHINGTON
REPRESENTED BY THE
DEPARTMENT OF CONSERVATION AND DEVELOPMENT

WASHINGTON
OTHELLO QUADRANGLE

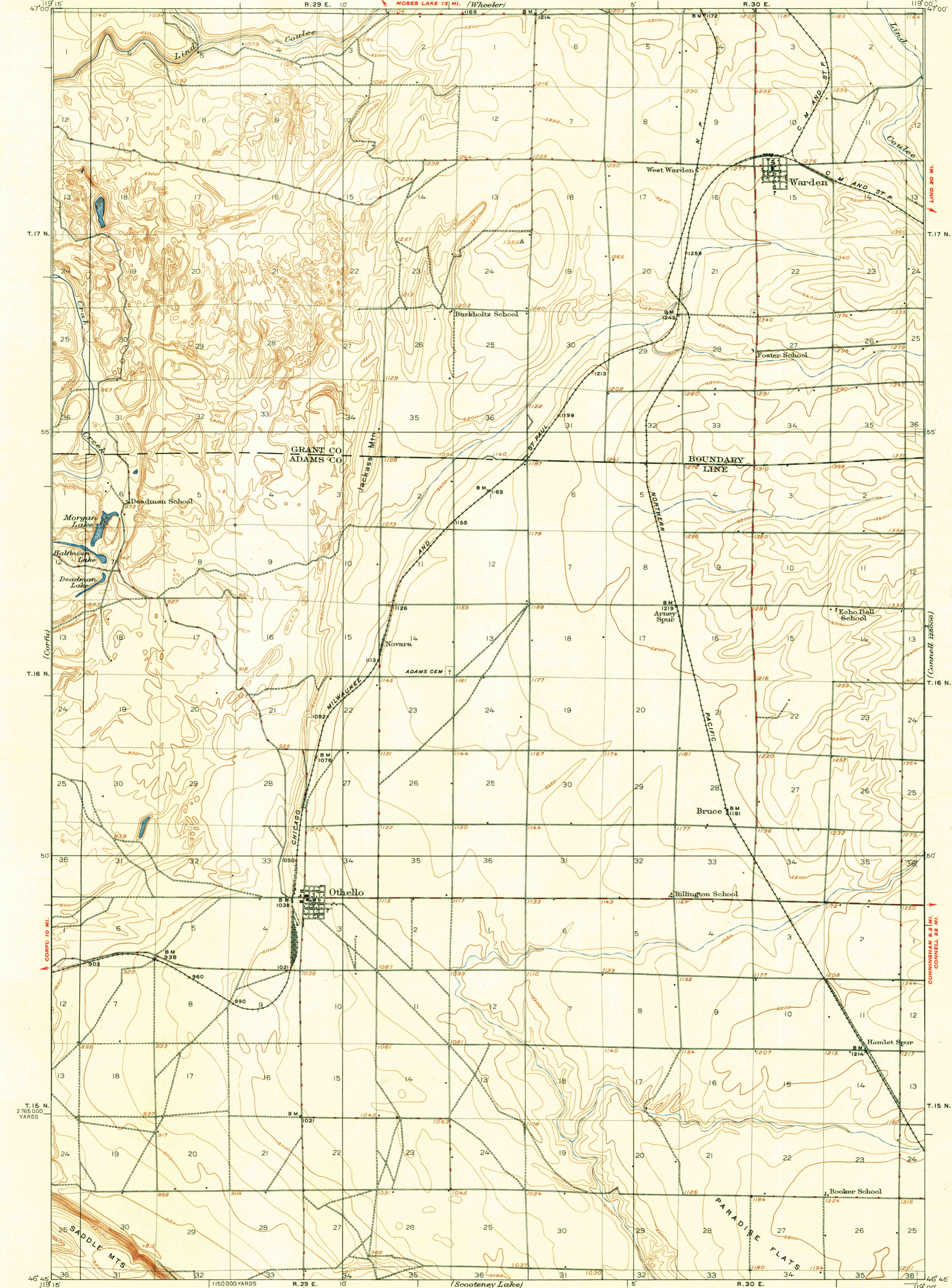

Topography by W. G. Carson.
Surveyed in 1922.

ROAD CLASSIFICATION
1947
Dependable hard surface
heavy-duty road
Secondary hard surface
all-weather road
Dirt road
Loose-surface graded
Unsurfaced, graded
Dirt road
U. S. Route
State Route
APPROXIMATE MEAN DECLINATION 1922

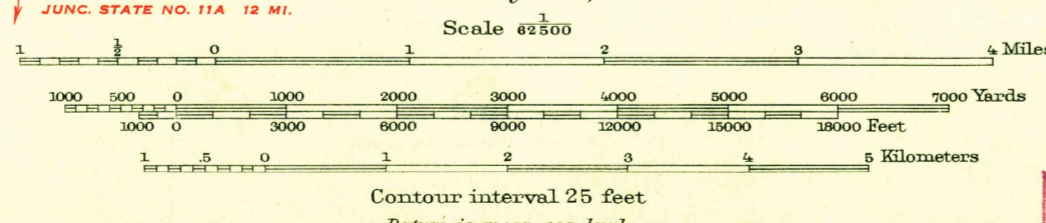

Polycyclic projection. To place on North American datum move projection lines 310 feet south and 530 feet west.
To join Connell use dotted projection corners.
5000 yard grid based upon U.S. zone system G.

U. S. G. S.
FILE COPY
Inspection and Editing.

OTHELLO, WASH.
Edition of 1924
reprinted 1948
N4645-W11900/15

USGS
Historical File
Topographic Division

APR 20 1948 3230