

UNITED STATES
DEPARTMENT OF THE INTERIOR
GEOLOGICAL SURVEY

WILSON CREEK QUADRANGLE
WASHINGTON—GRANT CO.
15 MINUTE SERIES (TOPOGRAPHIC)

2178 IV SE
(COULLEE CITY)

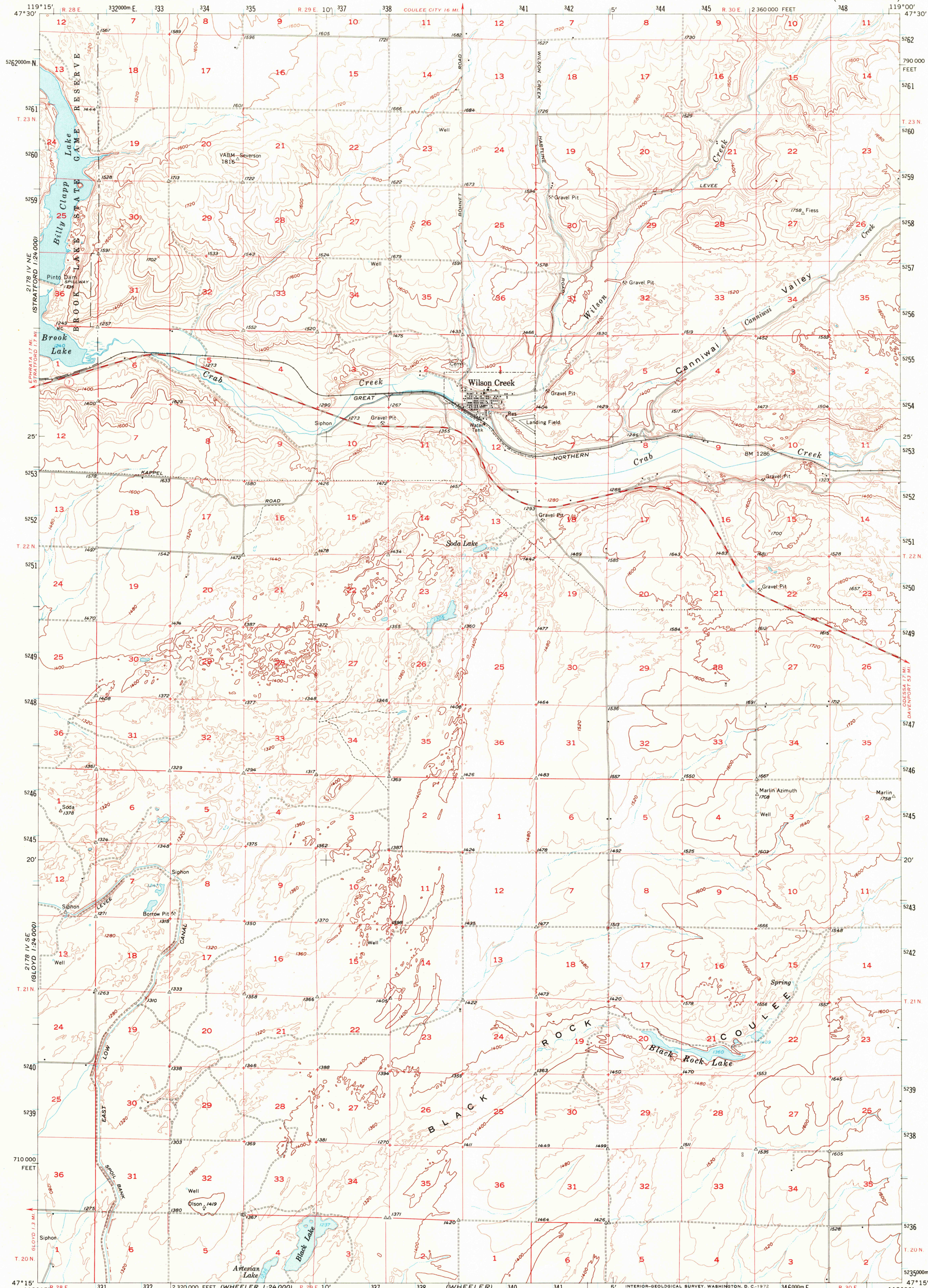

2178 IV SE
(MOSES LAKE)

Mapped, edited, and published by the Geological Survey
Control by USGS, USC&GS, and USBR
Topography from planimeter surveys by USBR 1937
and from aerial photographs by photogrammetric methods
Aerial photographs taken 1954. Field check 1956
Polyconic projection. 1927 North American datum
10,000-foot grid based on Washington coordinate system,
south zone
1000-meter Universal Transverse Mercator grid ticks,
zone 11, shown in blue

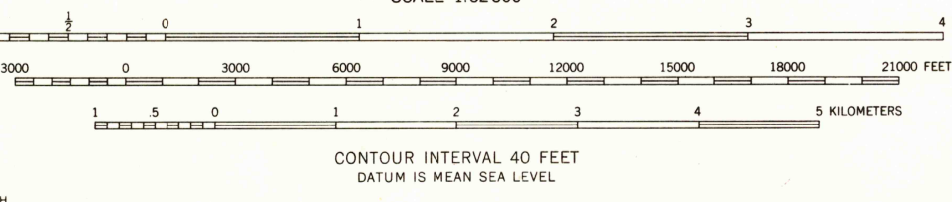
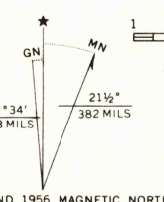

ROAD CLASSIFICATION
Medium-duty ——— Light-duty ———
Unimproved dirt ———

State Route
This area also partially covered by 1:24,000 scale maps of
Wilson Creek NW, Wilson Creek SW, and Wilson Creek SE
7.5 minute quadrangles, surveyed 1956

WILSON CREEK, WASH.
N4715—W11900/15

THIS MAP COMPLIES WITH NATIONAL MAP ACCURACY STANDARDS
FOR SALE BY U. S. GEOLOGICAL SURVEY, DENVER, COLORADO 80225 OR WASHINGTON, D. C. 20242
A FOLDER DESCRIBING TOPOGRAPHIC MAPS AND SYMBOLS IS AVAILABLE ON REQUEST

USGS
Historical File
Topographic Division

1956
AMS 2178 I—SERIES V791

USGS
HISTORICAL FILE
TOPOGRAPHIC DIVISION
1745
JAN 24 1972