

UNITED STATES
DEPARTMENT OF THE INTERIOR
GEOLOGICAL SURVEY

OSHKOSH NE QUADRANGLE
WISCONSIN
7.5-MINUTE SERIES (TOPOGRAPHIC)

REC'D FILE COPY
MAY 2 3 1996
USGS AND HISTORICAL
MAP ARCHIVES

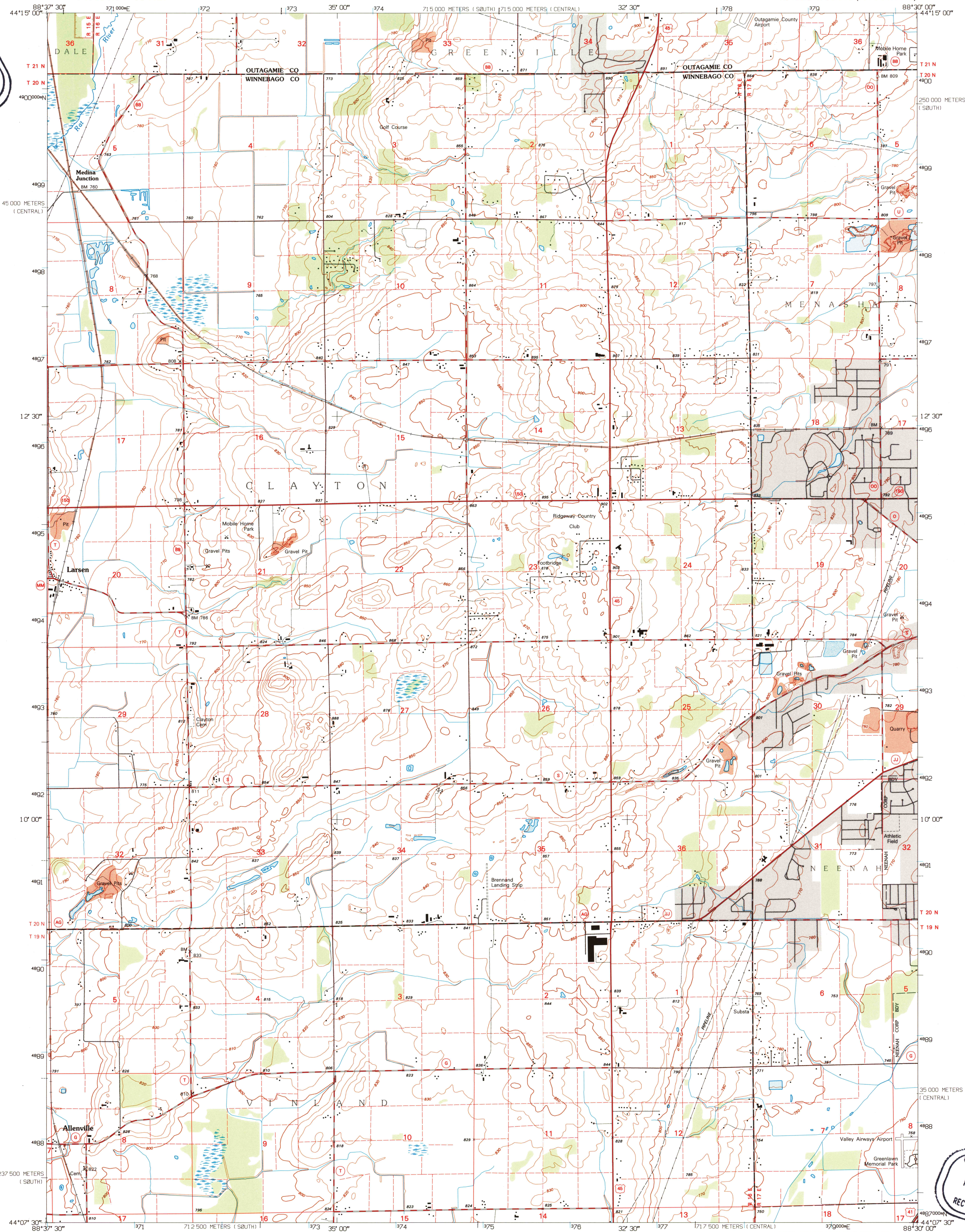

Produced by the United States Geological Survey
Compiled from imagery dated 1960. Revised from imagery dated 1992. PLSS and survey control current as of 1961. Contours and elevations current as of 1960. Map edited 1995.
North American Datum of 1983 (NAD 83). Projection and blue 1000-meter ticks: Universal Transverse Mercator, zone 16 2500-meter ticks: Wisconsin Coordinate System of 1983 (south and central zones).
North American Datum of 1927 (NAD 27) is shown by dashed corner ticks. The values of the shift between NAD 83 and NAD 27 for 7.5-minute intersections are obtainable from National Geodetic Survey NADCON software.
There may be private inholdings within the boundaries of the National or State reservations shown on this map.

UTM GRID AND 1995 MAGNETIC NORTH DECLINATION AT CENTER OF SHEET

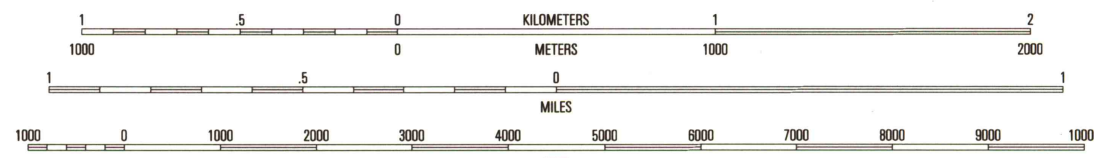

CONTOUR INTERVAL 10 FEET
NATIONAL GEODETIC VERTICAL DATUM OF 1929

THIS MAP COMPLIES WITH NATIONAL MAP ACCURACY STANDARDS
FOR SALE BY U.S. GEOLOGICAL SURVEY
DENVER, COLORADO 80225, OR RESTON, VIRGINIA 22092
AND WISCONSIN GEOLOGICAL AND NATURAL HISTORY SURVEY, MADISON, WISCONSIN 53706
A FOLDER DESCRIBING TOPOGRAPHIC MAPS AND SYMBOLS IS AVAILABLE ON REQUEST



QUADRANGLE LOCATION

1	2	3	1 Hortonville
			2 Greenville
			3 Appleton
4		5	4 Oshkosh NW
			5 Neenah
			6 Onro
6	7	8	7 Oshkosh
			8 Indian Point

ADJOINING 7.5' QUADRANGLE NAMES

ROAD CLASSIFICATION
Primary highway
hard surface Light-duty road, hard or improved surface
Secondary highway
hard surface Unimproved road
Interstate Route U.S. Route State Route

OSHKOSH NE, WI
44088-B5-TF-024

1992

DMA 3272 II NE-SERIES V861

USGS AND HISTORICAL
MAP ARCHIVES
MAY 2 3 1996
REC'D FILE COPY

