

Prepared under the direction of the Chief of Engineers by the Army Map Service (AM), U.S. Army, Washington, D.C. Copied in 1946 from West Virginia, 1:31,680, AMS, Sheet 5462 IV SE, 1944. Original map compiled by SCS from aerial photography by stereophotogrammetric methods. Horizontal and vertical control by USGS, USGS, USGS, and SCS, 1943-44. Aerial photography for SCS, 1943. Scale changed and marginal data revised, 1946. Map field checked, 1944. This map complies with the national standard map accuracy requirements.

LEGEND	
ROAD DATA 1943	
Hard surface, heavy duty road, more than two lanes wide	Loose surface, graded, dry-weather road
Hard surface, heavy duty road, two lanes wide; Federal route marker	Trail; Dirt road
Secondary, hard surface, all-weather road, two lanes wide; State route marker	Railroad in street; Carline in street
RAILROADS	UNDER CONSTRUCTION
Standard gauge	Single track
Narrow gauge	Double track
Single track carline	ABANDONED
BOUNDARIES	Single track
International	Double track
State	Single track
County (with monument)	Double track
County subdivision	Single track
Reservation	Double track
Military reservation	Single track
School; Church	Double track
Cemetery	Single track
Churchyard	Double track
Mine	Intermittent lake
Triangulation station	Intermittent stream
Bench mark	Dam
Spot elevation	Rapids; Falls
Woods	Large rapids and falls
Woods-brushwood	Swamp, marsh
Brushwood	Rocks awash at low tide
Orchard	Wharf, pier
Vineyard	Man-made shoreline

SCALE 1:24,000
MOUNTAIN MISSION 0.8 MI.
MOUNTAIN MISSION 1.3 MI.
HILLSBORO 4.5 MI.

POLYCONIC PROJECTION
1927 NORTH AMERICAN DATUM

REPRINTED FROM MILITARY EDITION FOR CIVIL USE
FOR SALE BY U.S. GEOLOGICAL SURVEY, WASHINGTON 25, D.C.
A FOLDER DESCRIBING TOPOGRAPHIC MAPS AND SYMBOLS IS AVAILABLE ON REQUEST

APPROXIMATE MEAN DECLINATION, 1946

INDEX TO BOUNDARIES

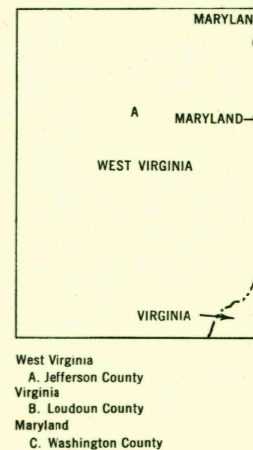

INDEX TO ADJOINING SHEETS

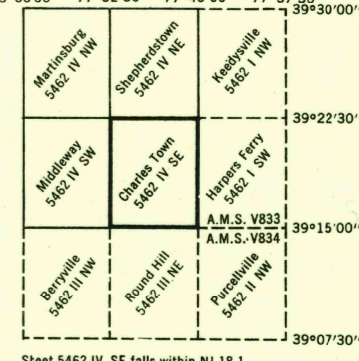

USGS
Historical File
Topographic Division

CHARLES TOWN, W. VA., VA., MD.
N3915-W7745/7.5

U.S.G.S.
FILE COPY
Inspection and Editing

MAY 18 1953

2655