

Advance sheet.
Subject to correction.

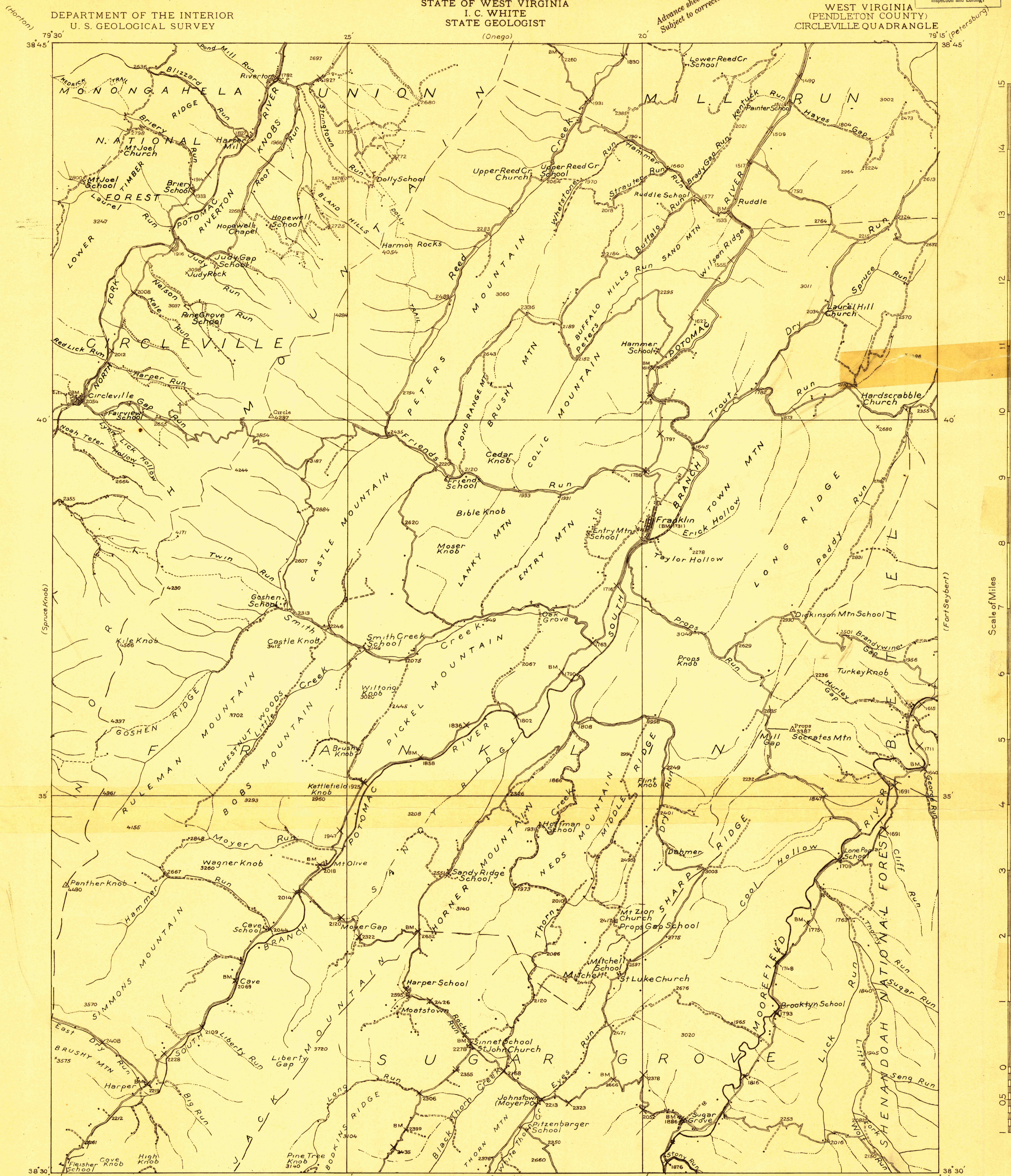

Topography by E. Ireland, J. P. Harrison and H. R. Kilmer
Surveyed in 1921-1922 in cooperation with the state of West Virginia.

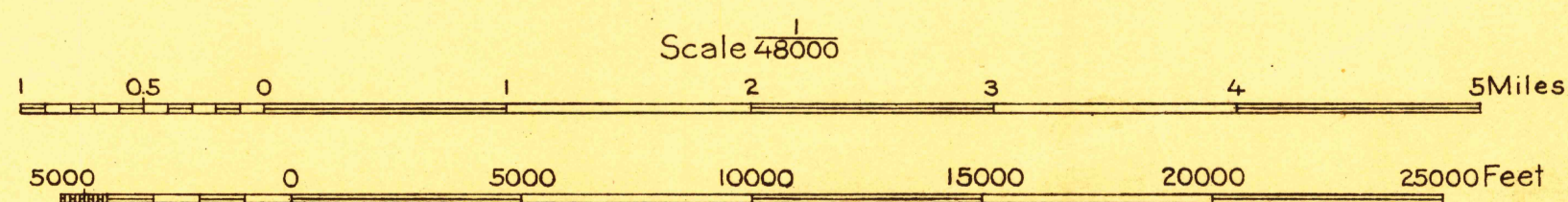

Datum is mean sea level.

Polyconic projection, North American datum

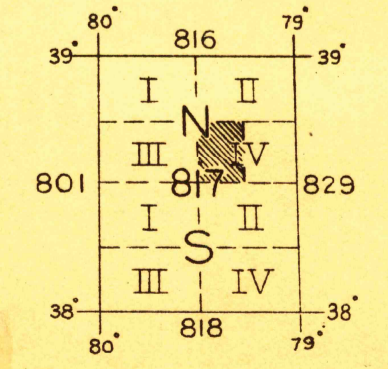

USGS
Historical File
Topographic Division

CIRCLEVILLE, W. VA.