

DEPARTMENT OF THE INTERIOR
 FRANKLIN K. LANE, SECRETARY
 U. S. GEOLOGICAL SURVEY
 GEORGE OTIS SMITH, DIRECTOR

816-S-11-E/2
TOPOGRAPHY
 STATE OF WEST VIRGINIA
 I. C. WHITE
 STATE GEOLOGIST
 (Grantsville)

Advance sheet.
 Subject to correction.

WEST VIRGINIA
 ELK GARDEN QUADRANGLE

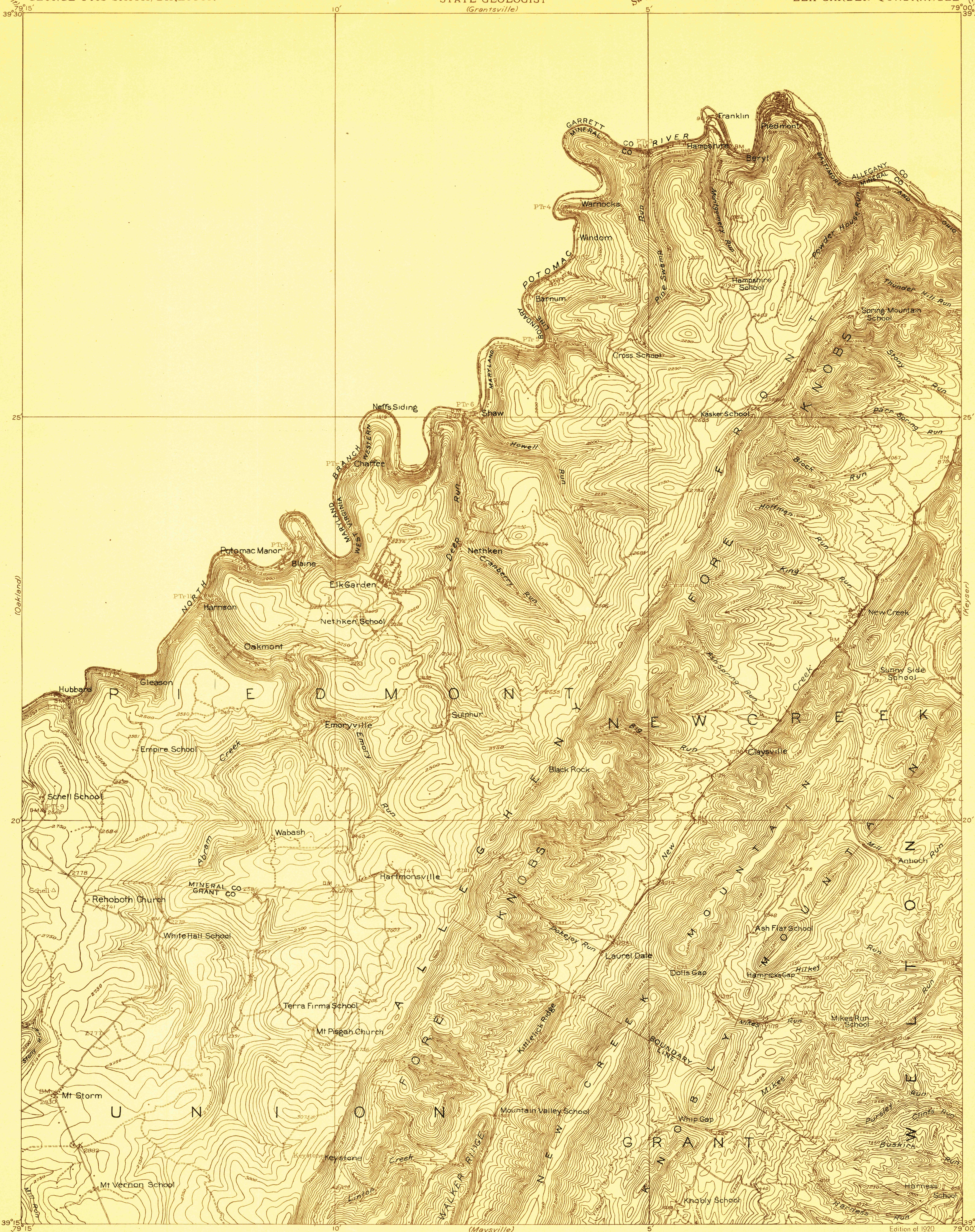

R. B. Marshall, Chief Geographer.
 Frank Sutton, Geographer.
 Topography by E. I. Ireland, J. I. Gayetty,
 M. J. Gleissner, and A. T. Munson.
 Control by U. S. Coast and Geodetic Survey, Baltimore and Ohio
 Railroad; Geo. T. Hawkins, J. B. Metcalf, Jr., H. H. Hodgeson,
 E. E. Harris, K. F. Maxcy, and Walter McCrea.
 Surveyed in 1916, and 1919.

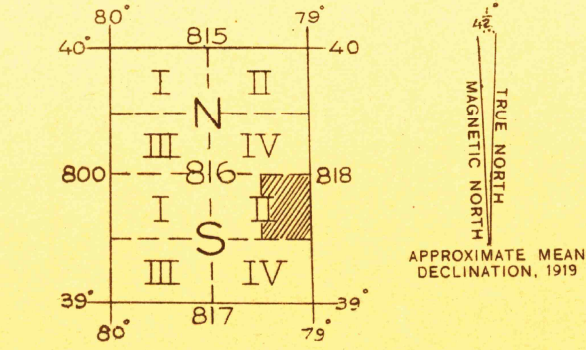
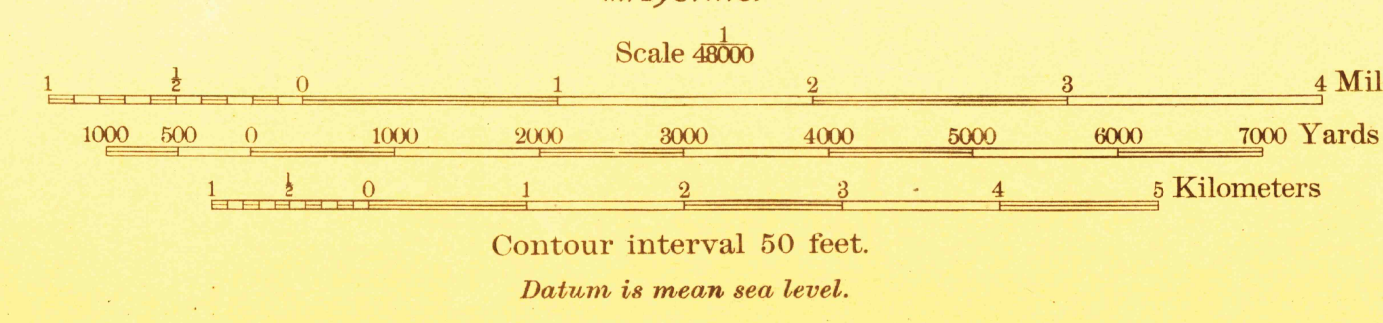

ELK GARDEN

FILE COPY
 RETURN TO CENTRAL FILE

SURVEYED IN COOPERATION WITH THE STATE OF WEST VIRGINIA.