

DEPARTMENT OF THE INTERIOR  
ALBERT B. FALL, SECRETARY  
U. S. GEOLOGICAL SURVEY  
GEORGE OTIS SMITH, DIRECTOR

828-S--E/2  
**TOPOGRAPHY**  
STATE OF WEST VIRGINIA  
I. C. WHITE  
STATE GEOLOGIST  
(Flintstone)

**TOPOGRAPHIC FILES**  
MAY 17 1922

Advance sheet.  
Subject to correction.

WEST VIRGINIA  
HANGING ROCK QUADRANGLE

U. S. GEOLOGICAL SURVEY  
This sheet must not be taken  
from the files without an order  
from the Chief Geographer.



C. H. Birdseye, Chief Topographic Engineer  
Frank Sutton, Division Topographic Engineer  
E. I. Ireland, Topographic Engineer in charge  
Topography by E. I. Ireland, D. H. Watson, C. W. Stump, Jr.,  
J. I. Gayetty and F. L. Whaley.  
Control by D. H. Watson, E. E. Harris and F. L. Shalibo  
Surveyed in 1916, 1918 and 1921.  
SURVEYED IN COOPERATION WITH THE STATE OF WEST VIRGINIA

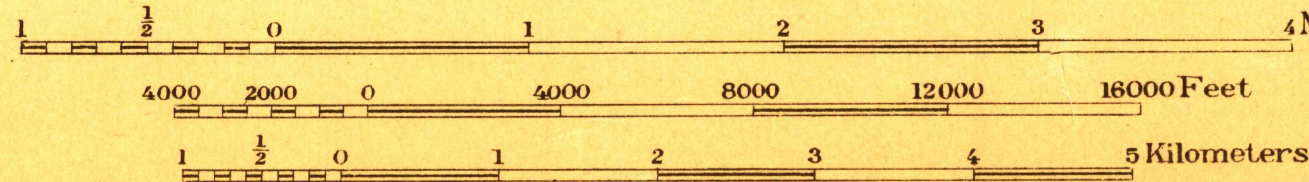
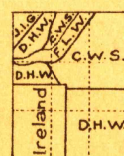

Contour interval 50 feet.  
Datum is mean sea level.

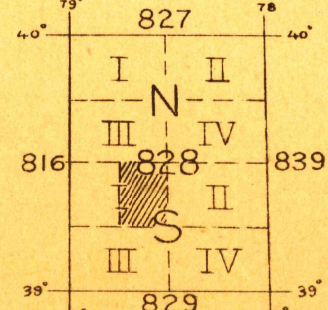

Polyconic projection, North American datum  
5000 yard grid based upon U. S. zone system, B

**FILE COPY**

RETURN TO CENTRAL FILE

HANGING ROCK

APPROXIMATE MEAN  
ELEVATION 1921.