

DEPARTMENT OF THE INTERIOR  
JOHN BARTON PAYNE, SECRETARY  
U. S. GEOLOGICAL SURVEY  
GEORGE OTIS SMITH, DIRECTOR

STATE OF WEST VIRGINIA I. C. WHITE  
STATE GEOLOGIST  
STATE OF MARYLAND WILLIAM BULLOCK CLARK  
STATE GEOLOGIST

# TOPOGRAPHIC FILES

WEST VIRGINIA-MARYLAND  
KEYSER QUADRANGLE MAR 26 1921

Advance sheet.  
Subject to correction.

RETAINED COPY  
This sheet must not be taken  
from the files without an order  
from the Chief Geographer.

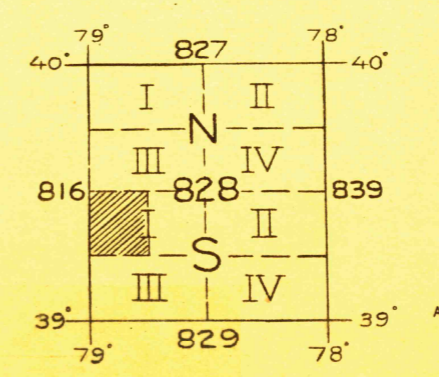
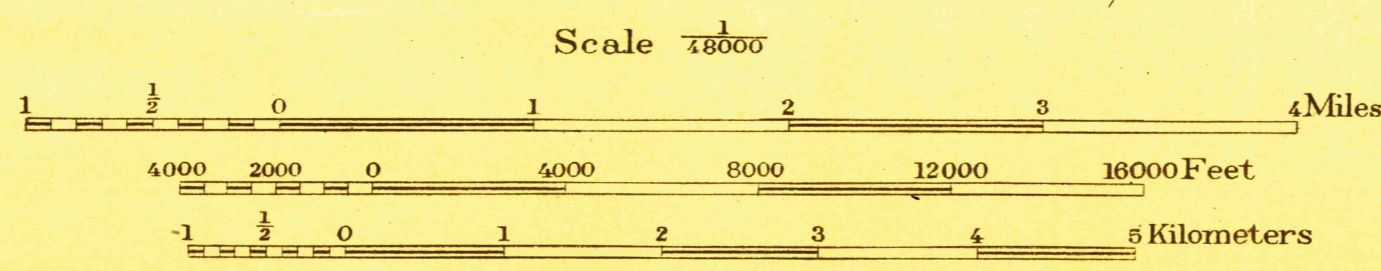
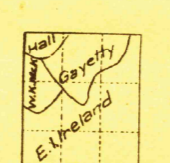
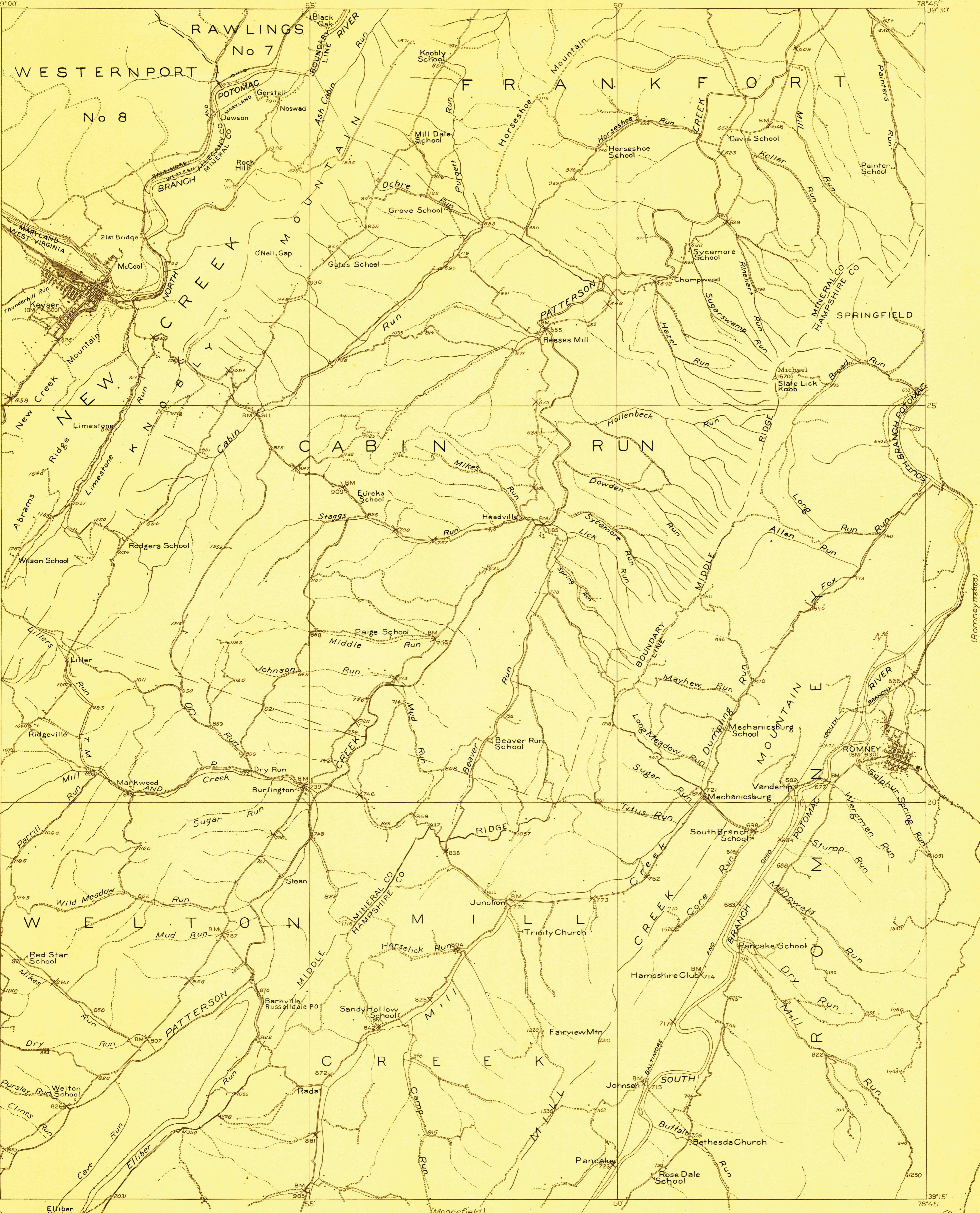

Polyconic projection, North American datum  
APPROXIMATE MEAN DECLINATION, 1920

FILE COPY  
RETURN TO CENTRAL FILE

KEYSER  
Edition of 1921

C. H. Birdseye, Chief Topographic Engineer  
Frank Sutton, Topographic Engineer in charge  
Topography by E. I. Ireland, J. I. Gayetty,  
W. K. McKinley, and W. C. Hall  
Control by U.S. Coast and Geodetic Survey, J. B. Metcalf, Jr.,  
E. E. Harris, F. L. Shalibo, and Baltimore and Ohio Railroad  
Surveyed in 1898, 1916, and 1920.