

RETAINED COPY
This sheet must not be taken from
the files without an order from the
Chief Topographic Engineer.

TOPOGRAPHIC FILE

FEB 8 1924

Advance sheet
Subject to correction

801-S-IV-E/2
STATE OF WEST VIRGINIA
I. C. WHITE
STATE GEOLOGIST
(Mingo)

WEST VIRGINIA
MARLINTON QUADRANGLE

DEPARTMENT OF THE INTERIOR
U. S. GEOLOGICAL SURVEY



(Webster Springs)

(Cass)

15 Miles
14
13
12
11
10
9
8
7
6
5
4
3
2
1
0
1
2
3
4
5
6
7
8
9
10
11
12
13
14
15 Miles

Topography by E. I. Ireland
Surveyed in 1923.

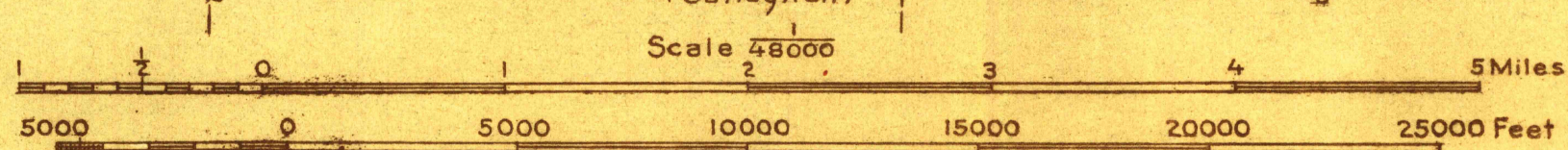

Scale 48000
Contour interval 50 feet
Datum is mean sea level

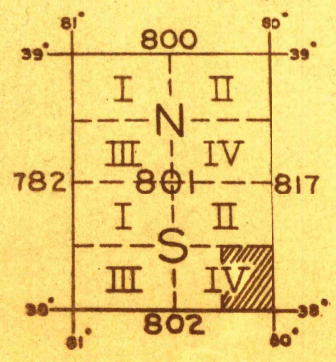

Polyconic projection. North American datum
5000 yard grid based upon U. S. zone system, B

FILE COPY
RETURN TO CENTRAL FILE
MARLINTON, W.VA.

APPROXIMATE MEAN
DECLINATION 1923

(White Sulphur Springs)

(Neutral Bridge)