

RETAINED COPY
This sheet must not be taken from
the files without an order from the
Chief Topographic Engineer.
Advance sheet
Subject to correction

JAN 7 1924

WEST VIRGINIA
MINGO QUADRANGLE

801-S-1-E/2
STATE OF WEST VIRGINIA
I. C. WHITE
STATE GEOLOGIST
(Pickens)

DEPARTMENT OF THE INTERIOR
U. S. GEOLOGICAL SURVEY

THIS AREA IS SHOWN ON THE MAP OF
WEBSTER SPRINGS WEST VIRGINIA QUADRANGLE,
SURVEYED IN 1915, SCALE 1:62500

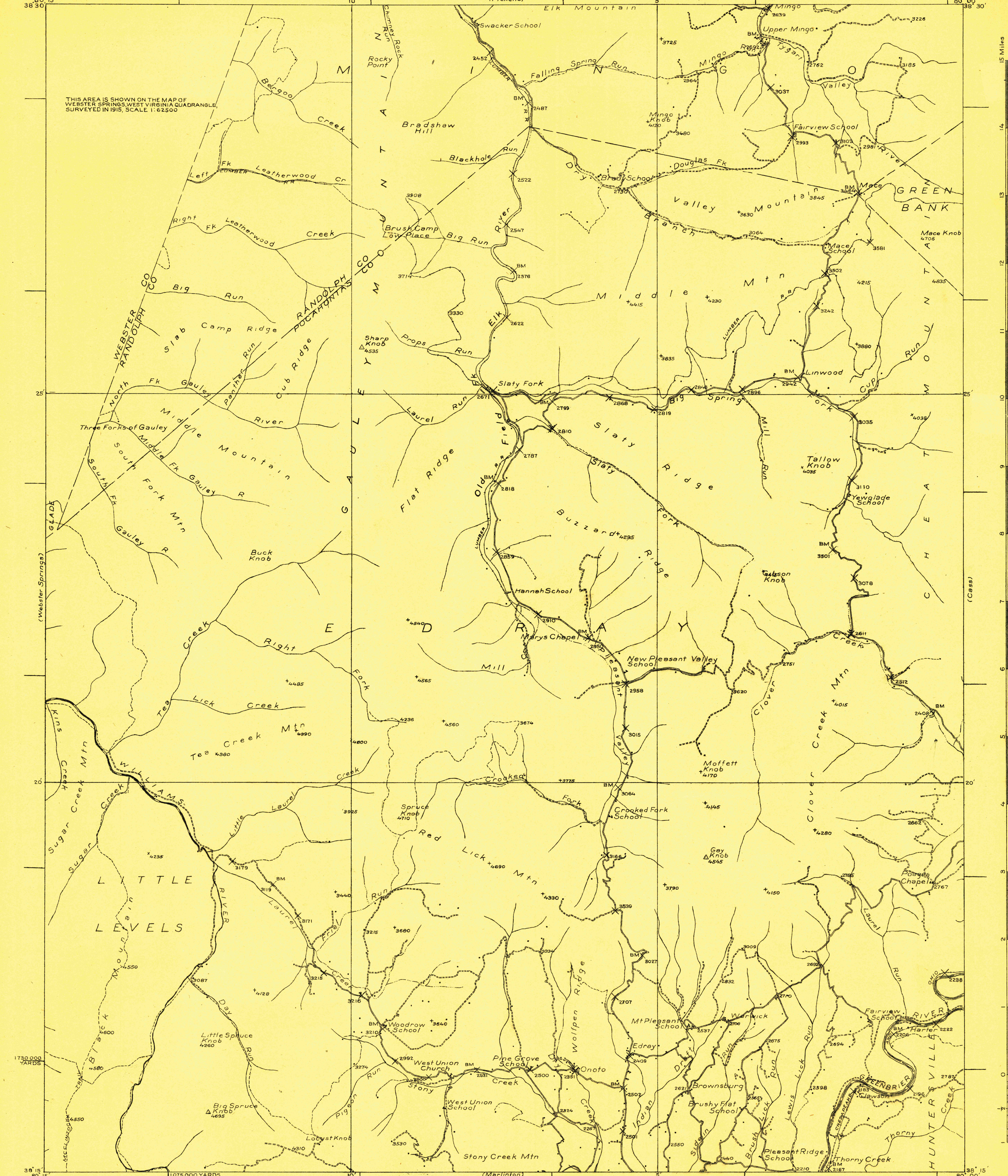

(Webster Springs)

(Cass)

15 Miles

(Marlinton)

(Warm Springs)

Topography by R.C. Seitz, H.R. Kilmer and A.J. Ogle
Surveyed in 1923

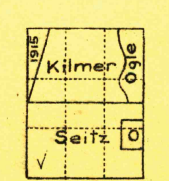

APPROXIMATE MEAN
DECLINATION 1923

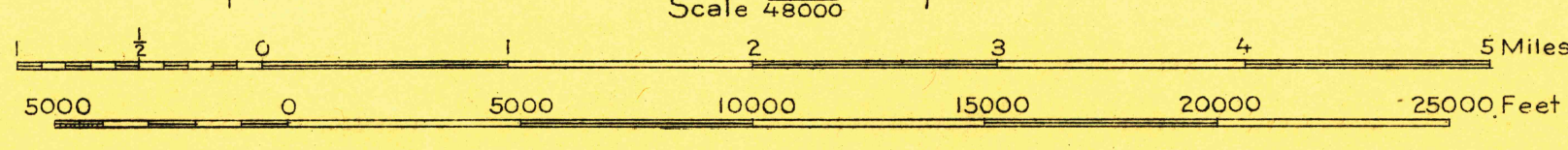

Datum is mean sea level

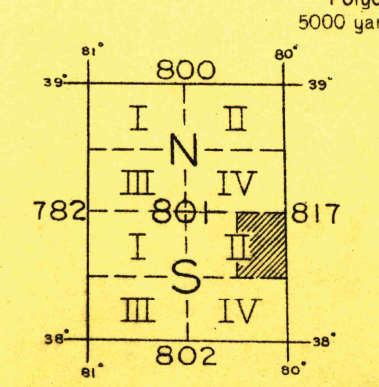

FILE COPY

RETURN TO CENTRAL FILE

MINGO, W.VA