

# TOPOGRAPHIC FILES

RETAINED COPY  
This sheet must not be taken  
from the files without an order  
from the Chief Geographer.

817-N-11-W2  
TOPOGRAPHY  
STATE OF WEST VIRGINIA  
I. C. WHITE  
STATE GEOLOGIST  
(Davis)

DEPARTMENT OF THE INTERIOR  
JOHN BARTON PAYNE, SECRETARY  
U. S. GEOLOGICAL SURVEY  
GEORGE OTIS SMITH, DIRECTOR

Advance sheet.  
Subject to correction.

FEB 16 1921  
WEST VIRGINIA  
ONEGO QUADRANGLE

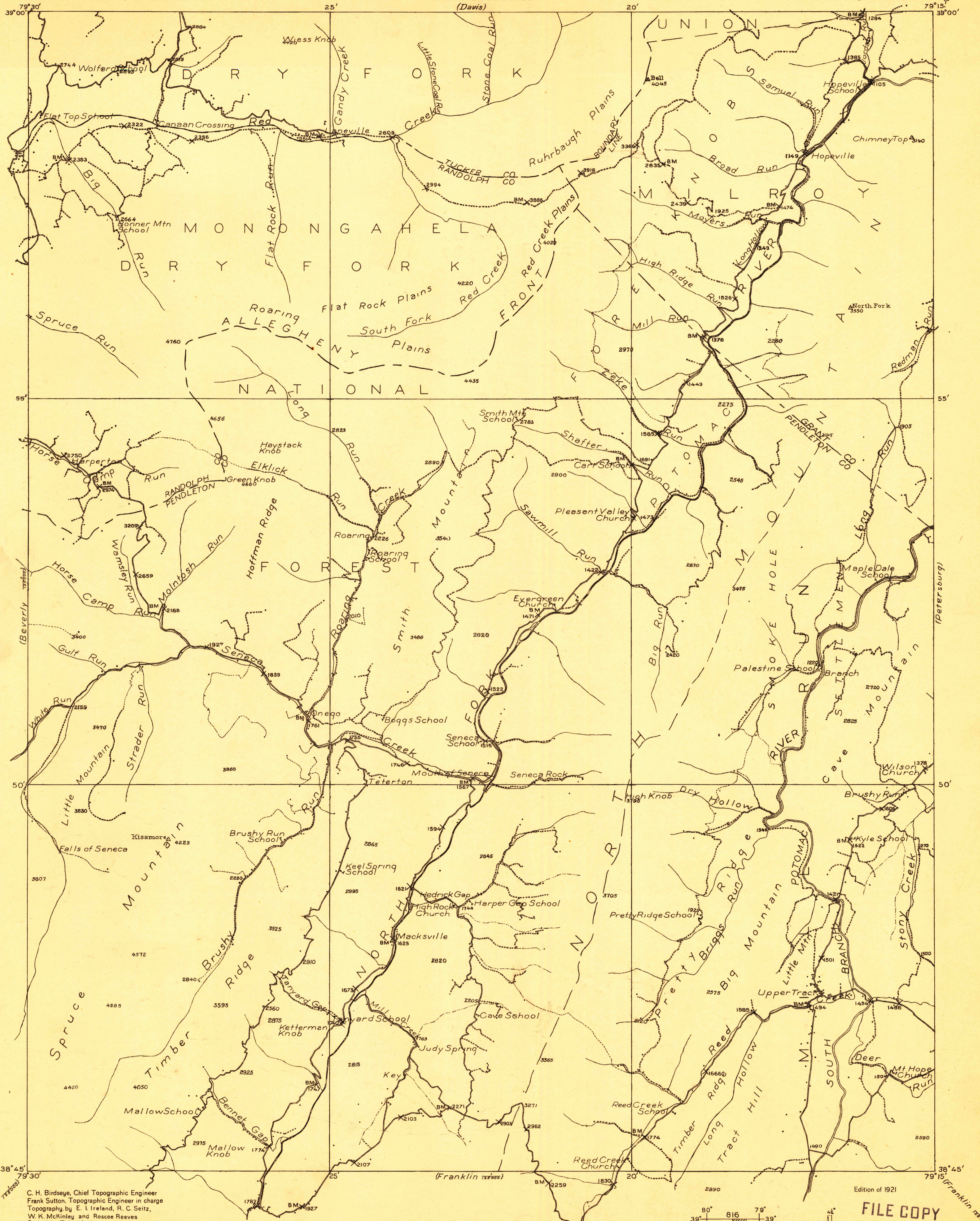

C. H. Birdseye, Chief Topographic Engineer  
Frank Sutton, Topographic Engineer in charge  
Topography by E. I. Ireland, R. C. Seitz,  
W. K. McKinley and Roscoe Reeves  
Control by E. L. McNair, Walter McCrea  
and F. L. Shalibo  
Surveyed in 1919-1920

SURVEYED IN COOPERATION WITH THE STATE OF WEST VIRGINIA

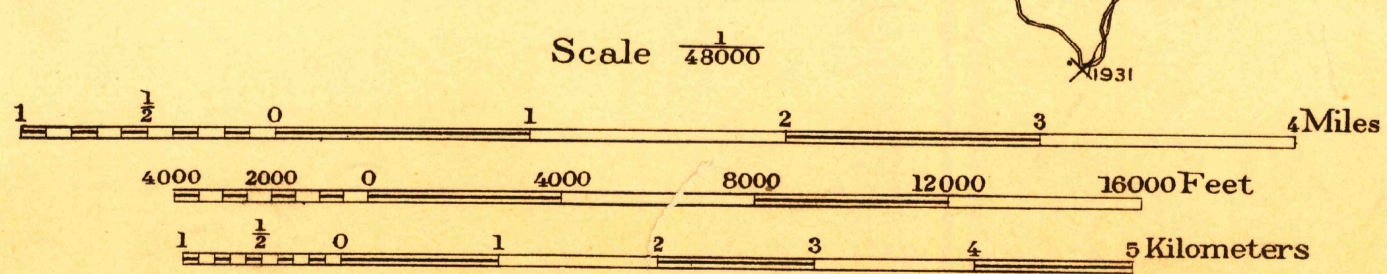

Contour interval 50 feet.  
Datum is mean sea level.

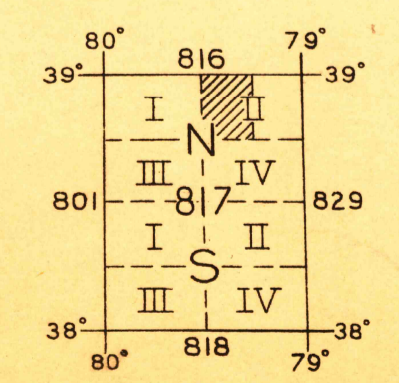

FILE COPY  
RETURN TO CENTRAL FILE  
ONEGO  
North American Datum  
APPROXIMATE MEAN DECLINATION 1989  
Polyconic Projection