

817-N-11-E/2
TOPOGRAPHY
STATE OF WEST VIRGINIA
I. C. WHITE
STATE GEOLOGIST

DEPARTMENT OF THE INTERIOR
JOHN BARTON PAYNE, SECRETARY
U. S. GEOLOGICAL SURVEY
GEORGE OTIS SMITH, DIRECTOR

Advance sheet.
Subject to correction.

APR 4 1921
WEST VIRGINIA - VIRGINIA
PETERSBURG QUADRANGLE

RETAINED COPY.
This sheet must not be taken from the files without an order from the Chief Geographer.



C. H. Birdseye, Chief Topographic Engineer
Frank Sutton, Geographer in charge
Topography by E. I. Ireland, R. T. Evans, Roscoe Reeves,
J. M. Rawls, R. C. Seitz, W. K. McKinley, and J. J. Murphy.
Control by E. L. McNair, F. L. Shalibo, and Walter McCrea.
Surveyed in 1919 and 1920.

SURVEYED IN COOPERATION WITH THE STATE OF WEST VIRGINIA

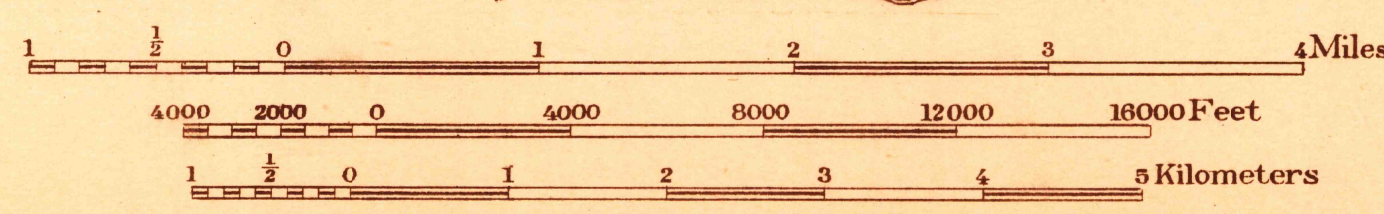
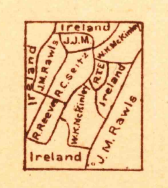

Contour interval 50 feet.
Datum is mean sea level.

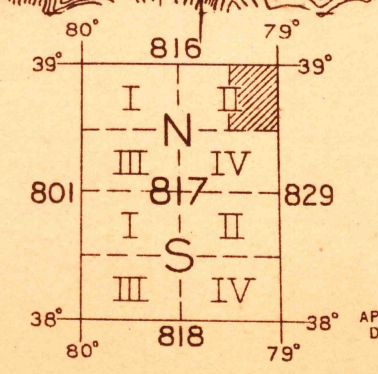

Polyconic projection North American datum

PETERSBURG
Edition of 1921

FILE COPY

RETURN TO CENTRAL FILE