

801-S-III-E/2 **TOPOGRAPHIC FILES**

U. S. GEOLOGICAL SURVEY
 RETAINED COPY
 This sheet must not be taken
 from the files without an order
 from the Chief Geographer
 APR 6 1922

DEPARTMENT OF THE INTERIOR
 ALBERT B. FALL, SECRETARY
 U. S. GEOLOGICAL SURVEY
 GEORGE OTIS SMITH, DIRECTOR

STATE OF WEST VIRGINIA
 I. C. WHITE
 STATE GEOLOGIST

WEST VIRGINIA
 RICHWOOD QUADRANGLE

THIS AREA PUBLISHED
 AS RICHWOOD QUADRANGLE
 PRELIMINARY EDITION

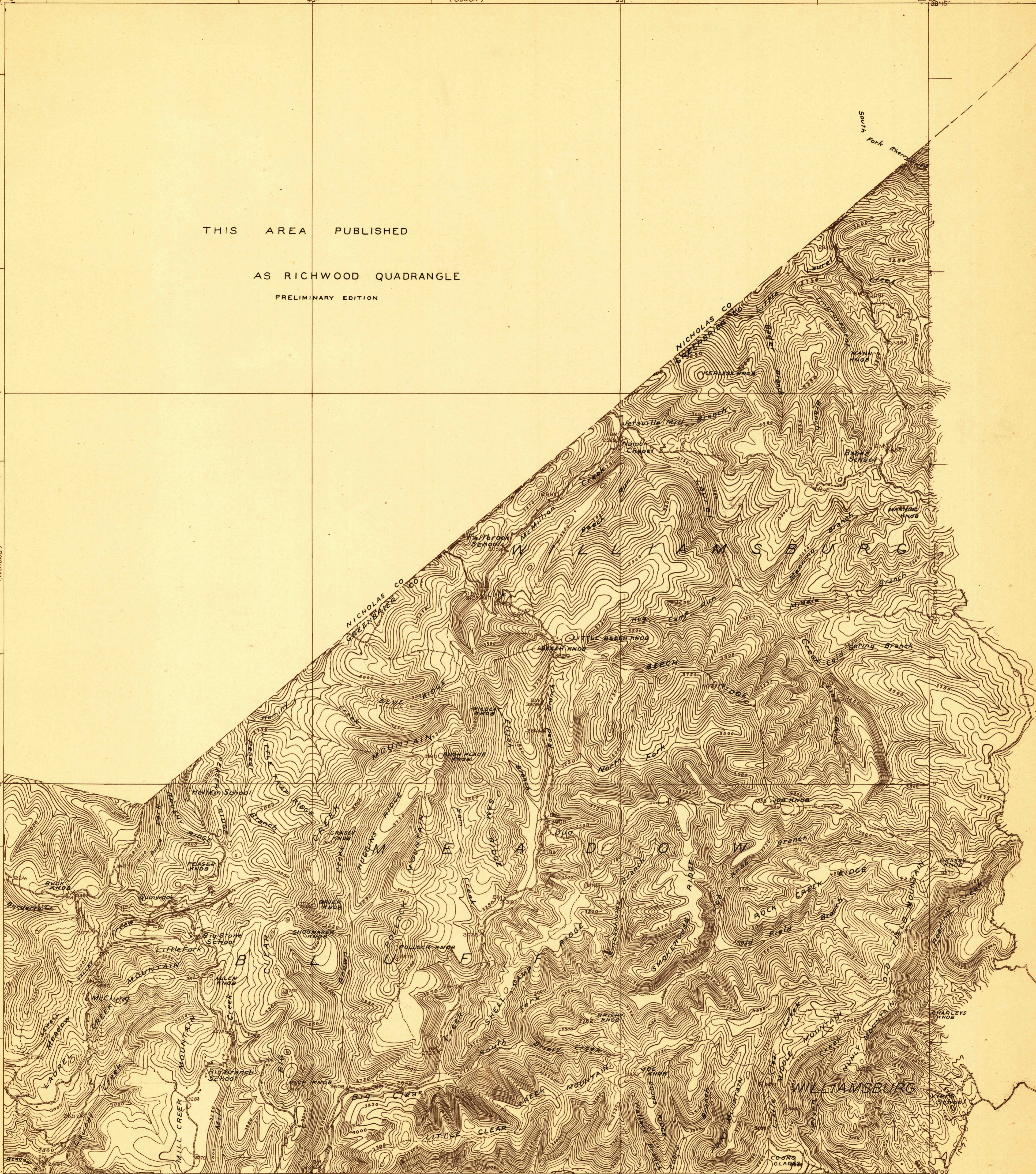

C. H. Birdseye, Chief Topographic Engineer
 Frank Sutton, Division Topographic Engineer
 E. I. Ireland, Topographic Engineer in charge
 Topography by E. I. Ireland, R. C. Seitz, W. K. McKinley, and H. R. Kilmer.
 Control by U. S. Coast and Geodetic Survey, Oscar Jones,
 Hargraves Wood, H. S. Senseney, and H. P. Kilby.
 Surveyed in 1915 and 1921.

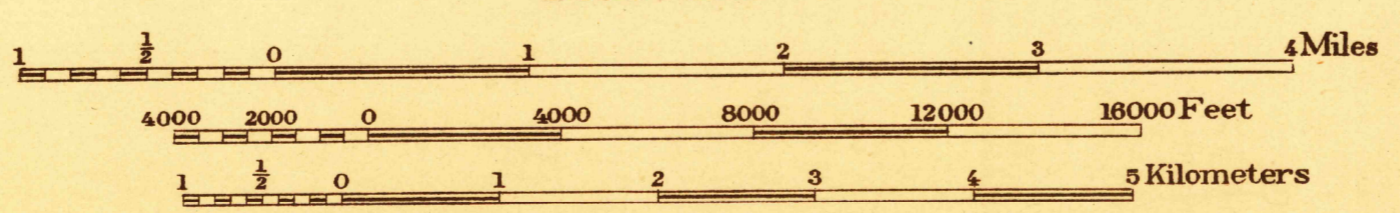

Contour interval 50 feet.
 Datum is mean sea level.

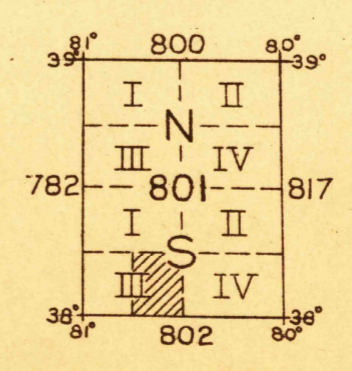

Polygonic projection, North American datum
 5000 yard grid based upon U. S. zone system, B
FILE COPY
 RETURN TO CENTRAL FILE
 APPROXIMATE MEAN DECLINATION 1921