

817-N-111-E/2 STATE OF WEST VIRGINIA I. C. WHITE STATE GEOLOGIST

DEPARTMENT OF THE INTERIOR U. S. GEOLOGICAL SURVEY

Advance sheet. Subject to correction.

WEST VIRGINIA-VIRGINIA SPRUCE KNOB QUADRANGLE

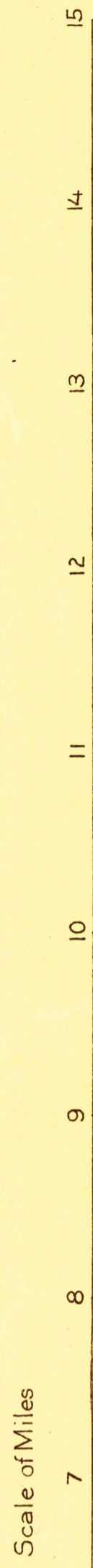
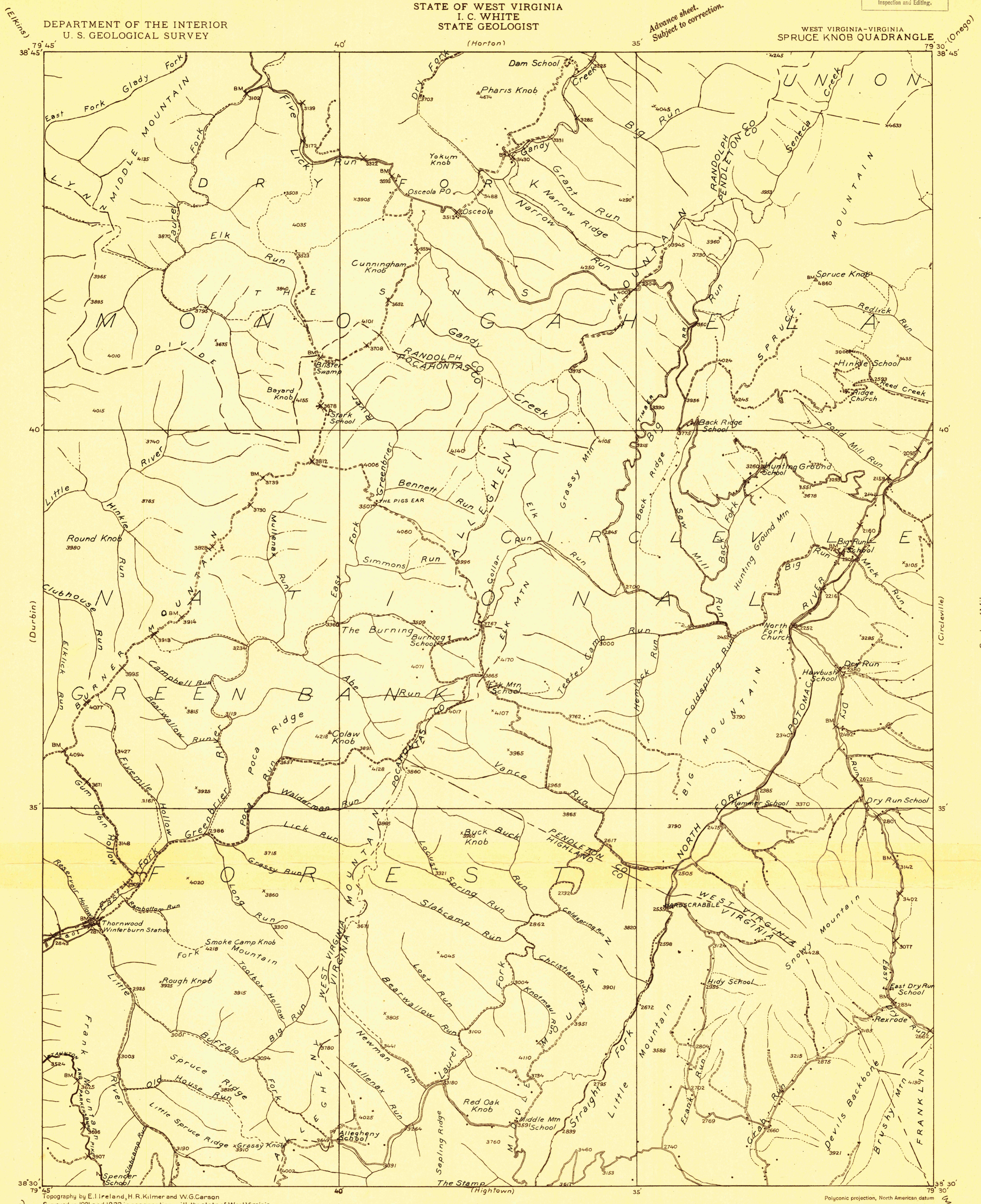

Topography by E. I. Ireland, H. R. Kilmer and W. G. Carson Surveyed in 1921 and 1922 in cooperation with the state of West Virginia.

Scale 48000

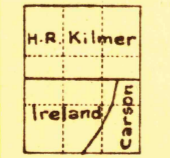
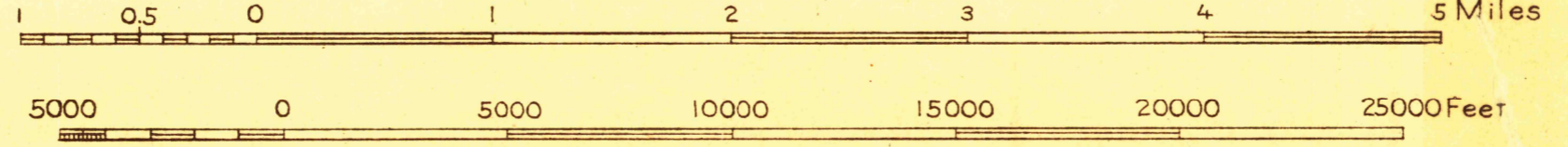

APPROXIMATE MEAN DECLINATION 1922

Datum is mean sea level.

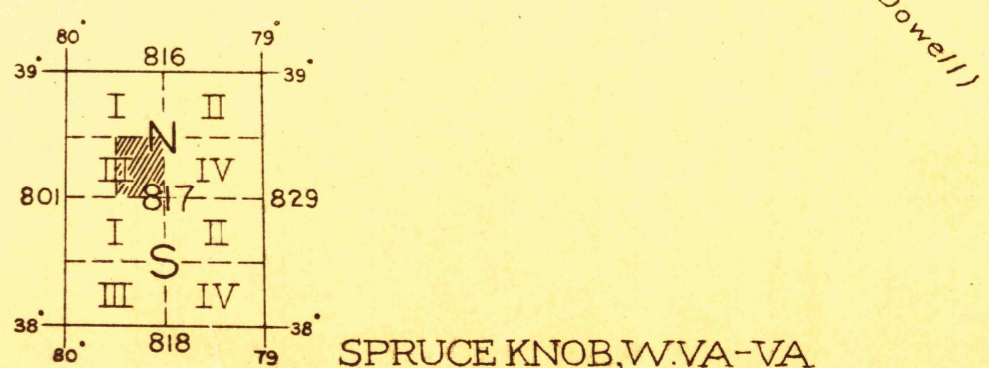

SPRUCE KNOB, W.VA-VA