

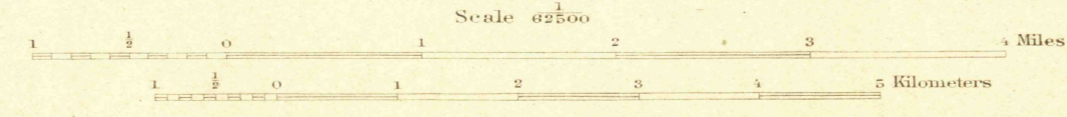

C.H. Birdssey, Chief Topographic Engineer,  
Frank Sutton, Division Topographic Engineer,  
E.J. Ireland, Topographic Engineer in charge,  
Topography by E.J. Ireland, R.C. Seitz, and R.T. Evans.  
Control by E.L. McNair, F.L. Shalibo, C.F. Shalibo, and E.E. Harris.  
Surveyed in 1920-1921.

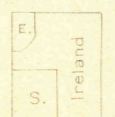

APPROXIMATE MEAN  
DECLINATION, 1954

Polygonic projection, North American datum,  
5000 yard grid based upon U.S. zone system, B.

RONCEVERTE  
Edition of 1923.