

UNITED STATES
DEPARTMENT OF THE INTERIOR
GEOLOGICAL SURVEY

BONNEVILLE SW QUADRANGLE
WYOMING-FREMONT CO.
7.5 MINUTE SERIES (TOPOGRAPHIC)

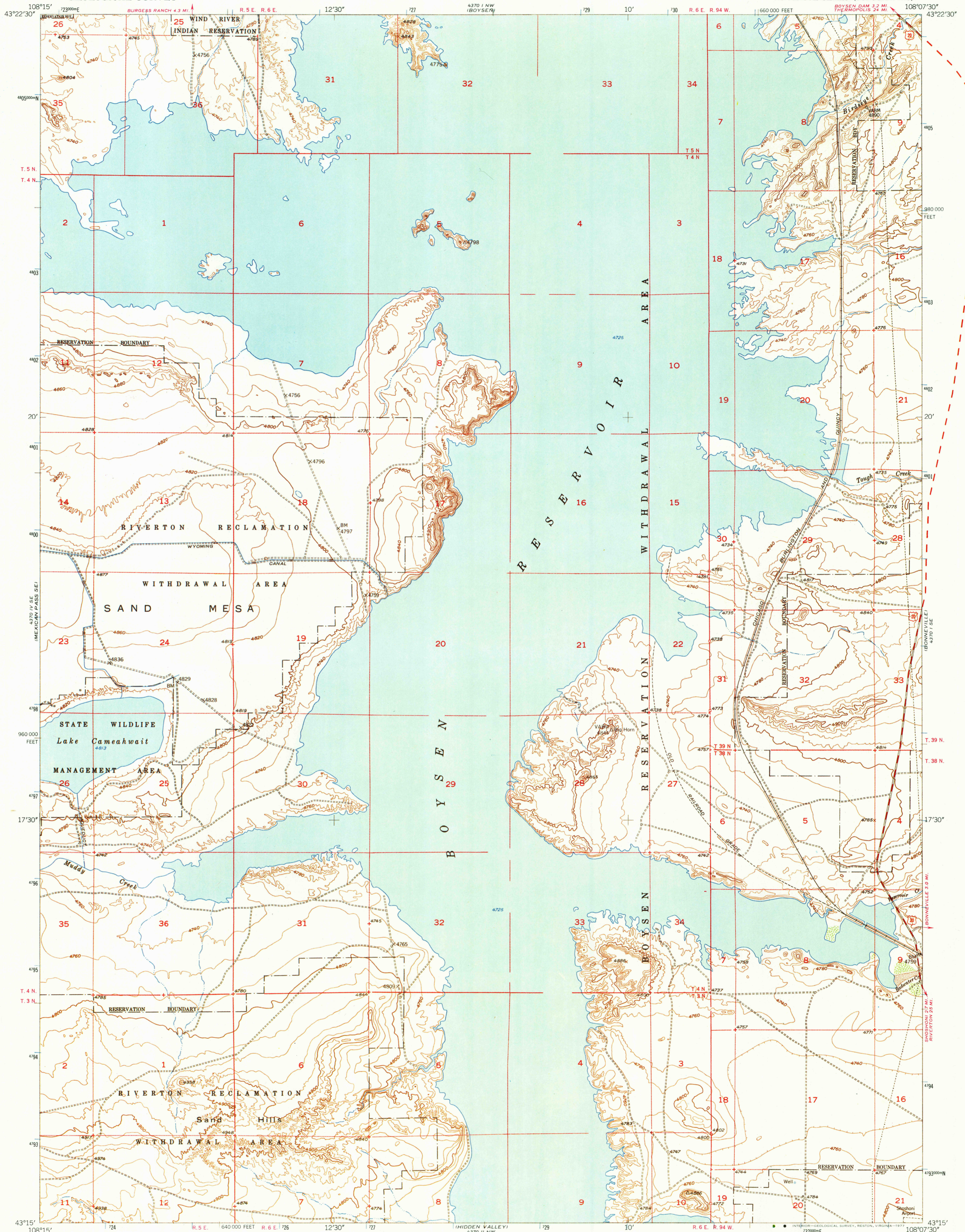

Mapped by the Geological Survey and the Bureau of Reclamation Edited and published by the Geological Survey as part of the Department of the Interior program for the development of the Missouri River Basin
Control by USGS and USC&GS
Topography by planetable surveys, 1942, and from aerial photographs by multiplex methods. Aerial photographs taken October 1948. Field check 1950. Revised 1958
Polyconic projection. 1927 North American datum
10,000-foot grid based on Wyoming coordinate system, west central zone
1000-meter Universal Transverse Mercator grid ticks, zone 12, shown in blue
T_s. 3, 4, and 5 N., R_s. 5 and 6 E., based on the Wind River Meridian.
T_s. 38 and T_s. 39 N., R_s. 94 W., based on the Sixth Principal Meridian.

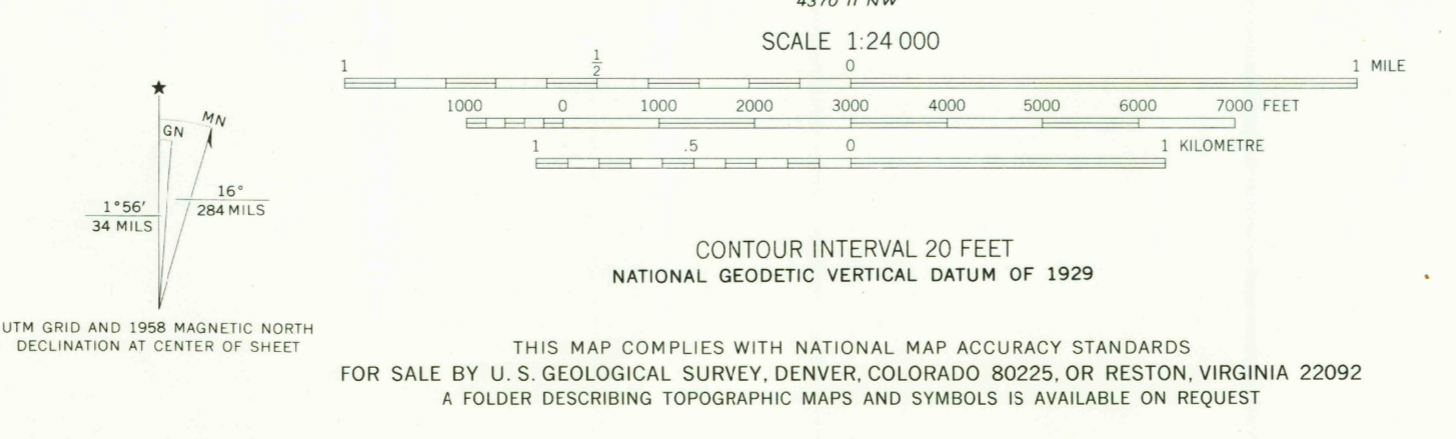

ROAD CLASSIFICATION
Primary highway, hard surface
Secondary highway, hard surface
Light-duty road, hard or improved surface
Unimproved road
Interstate Route
U. S. Route
State Route

USGS Historical File Topographic Division
BONNEVILLE SW, WYO.
N4315-W10807.5/7.5
1958
AMS 4370 1 SW-SERIES V874

This map was reproduced by electronic color scanning of an earlier printing (1959).

RETURN TO:
USGS AND HISTORICAL MAP ARCHIVES

MAR 23 1977
400