

Produced by the U.S. Geological Survey
Revised by the U.S. Forest Service
Areas outside the National Forest System lands may not have been revised
Control by USGS and USFS
Compiled from aerial photographs taken 1963. Revised from aerial
photographs taken 1989. Partial field check by U.S. Forest Service 1993
North American Datum of 1927 (NAD 27). Projection and 10 000-foot ticks:
Wyoming coordinate system, east central zone (Lambert conformal conic). Blue
1000-meter Universal Transverse Mercator ticks, zone 13
North American Datum of 1983 (NAD 83) is shown by dashed corner ticks.
The values of the shift between NAD 27 and NAD 83 for 7.5-minute
intersections are obtainable from National Geographic Survey NADCON software
Non-National Forest System lands within the National Forest
Inholdings may exist in other National or State reservations
This map is not a legal land line or ownership document. Public lands are
subject to change and leasing, and may have access restrictions; check
with local offices. Obtain permission before entering private lands

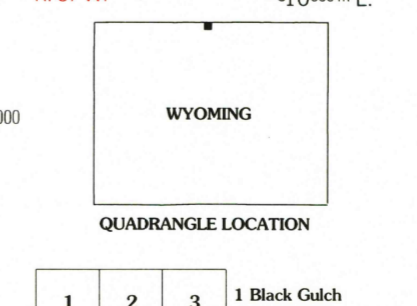
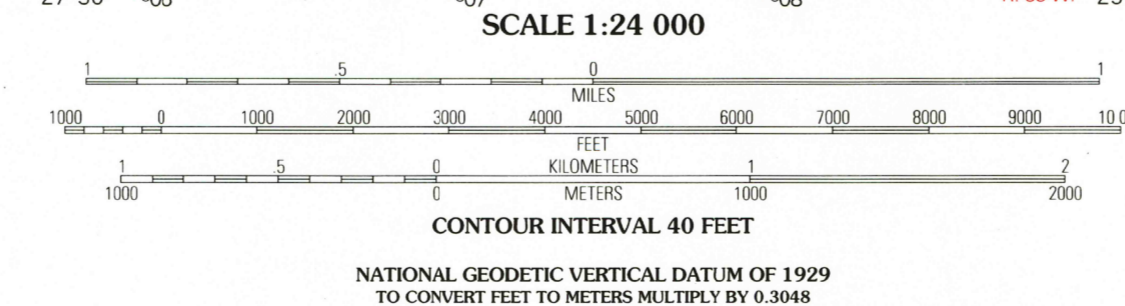
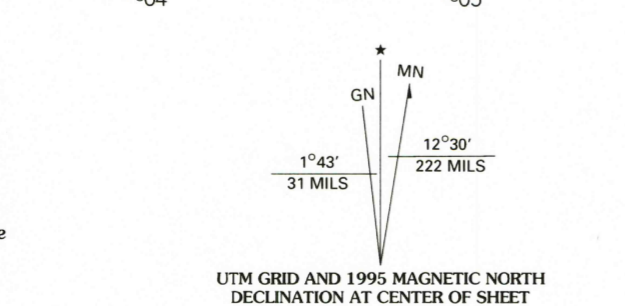

1	2	3	1 Black Gulch
4	5	6	2 Pass Creek West
7	8	7	3 Pass Creek East
		8	4 West Pass
			5 Dayton North
			6 Burgess Junction
			7 Skull Ridge
			8 Dayton South

HIGHWAYS AND ROADS

Interstate		Primary highway	
U. S.		Secondary highway	
State		Light-duty road	
County		Paved	
National Forest, suitable for passenger cars		Gravel	
National Forest, suitable for high clearance vehicles		Dirt	
National Forest Trail		Composition unspecified	
		Unimproved; 4 wheel drive	
		Trail	
		Gate	

COLUMBUS PEAK, WYO.
44107-H4-TF-024
1993
DMA 4573 IV NW - SERIES V874

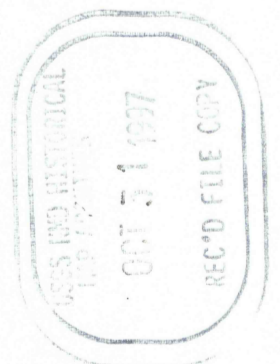

ISBN 0-607-85524-6
9 780607 855246