

BRONNVILLE SW

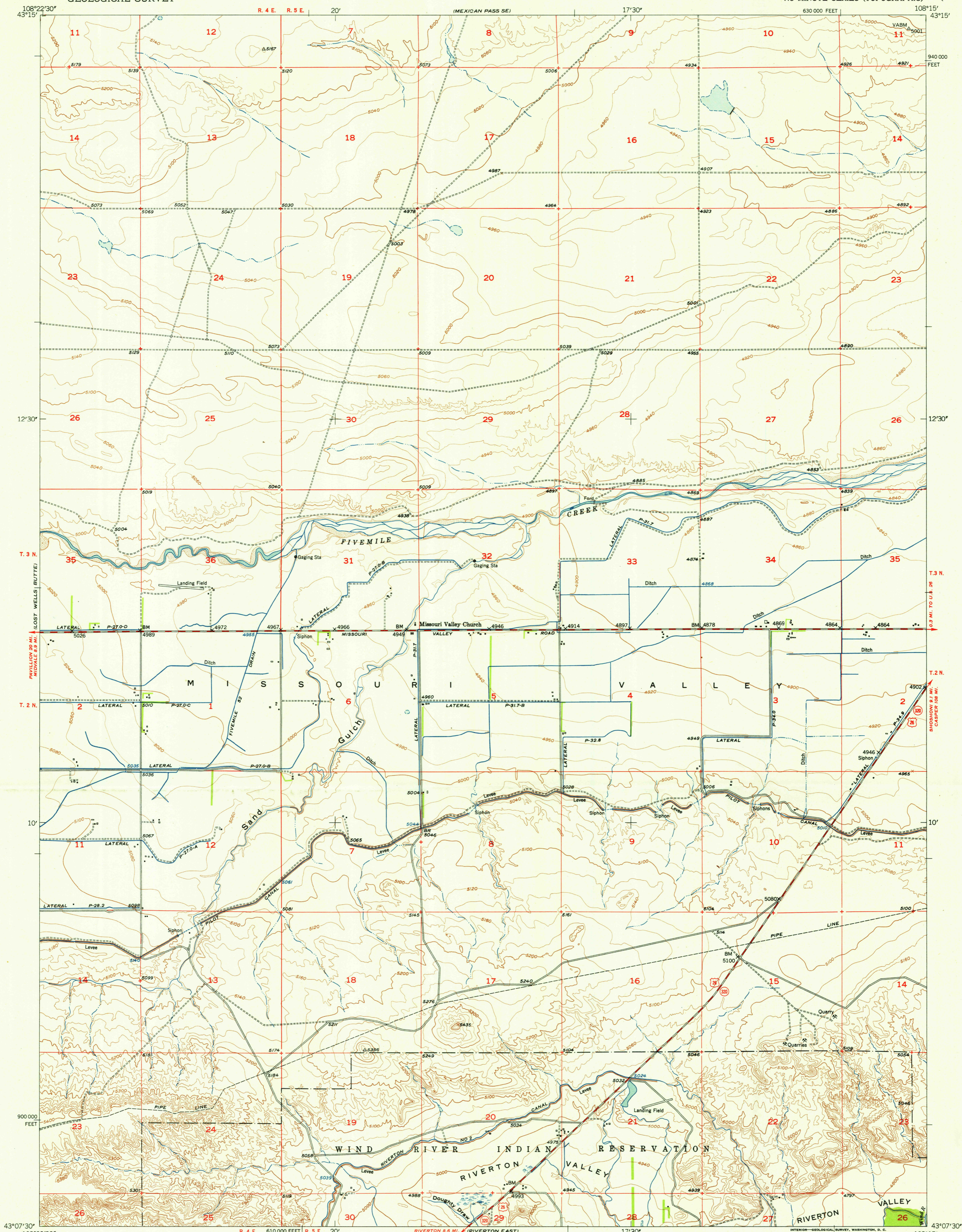

108°22'30"
43°15'
12°30'
T. 3 N.
T. 2 N.
10'
900 000 FEET
43°07'30"

108°15'
43°15'
940 000 FEET
T. 3 N.
T. 2 N.
10'
43°07'30"

Mapped, edited, and published by the Geological Survey as part of the Department of the Interior program for the development of the Missouri River Basin
Control by USGS and USC&GS
Topography from aerial photographs by multiplex methods
Aerial photographs taken October 1948. Field check, 1950
Polyconic projection. 1927 North American datum
10,000-foot grid based on Wyoming coordinate system, west central zone

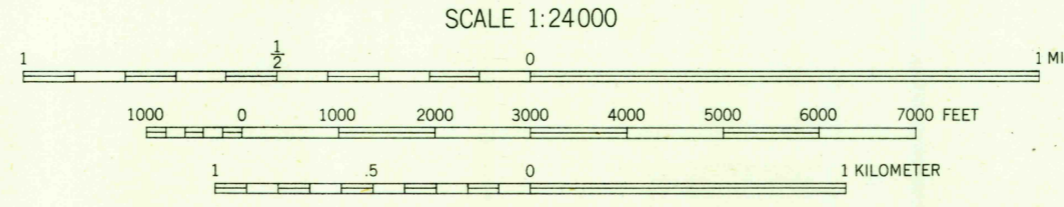
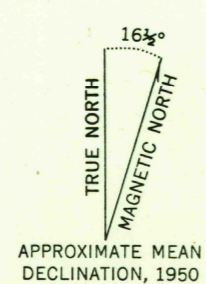

ROAD CLASSIFICATION

Heavy-duty	4 LANE 18 LANE	Light-duty
Medium-duty	4 LANE 18 LANE	Unimproved dirt
U. S. Route		State Route

THIS MAP COMPLIES WITH NATIONAL MAP ACCURACY STANDARDS
FOR SALE BY U. S. GEOLOGICAL SURVEY, FEDERAL CENTER, DENVER, COLORADO OR WASHINGTON 25, D. C.
A FOLDER DESCRIBING TOPOGRAPHIC MAPS AND SYMBOLS IS AVAILABLE ON REQUEST

U. S. G. S.
FILE COPY
Inspection and Editing

RIVERTON NE, WYO.
N4307.5-W10815/7.5
EDITION OF 1952

RETURN TO:
USGS AND HISTORICAL MAP ARCHIVES