

UNITED STATES  
DEPARTMENT OF THE INTERIOR  
GEOLOGICAL SURVEY

SHEEP CANYON QUADRANGLE  
WYOMING-BIG HORN CO.  
7.5 MINUTE SERIES (TOPOGRAPHIC)

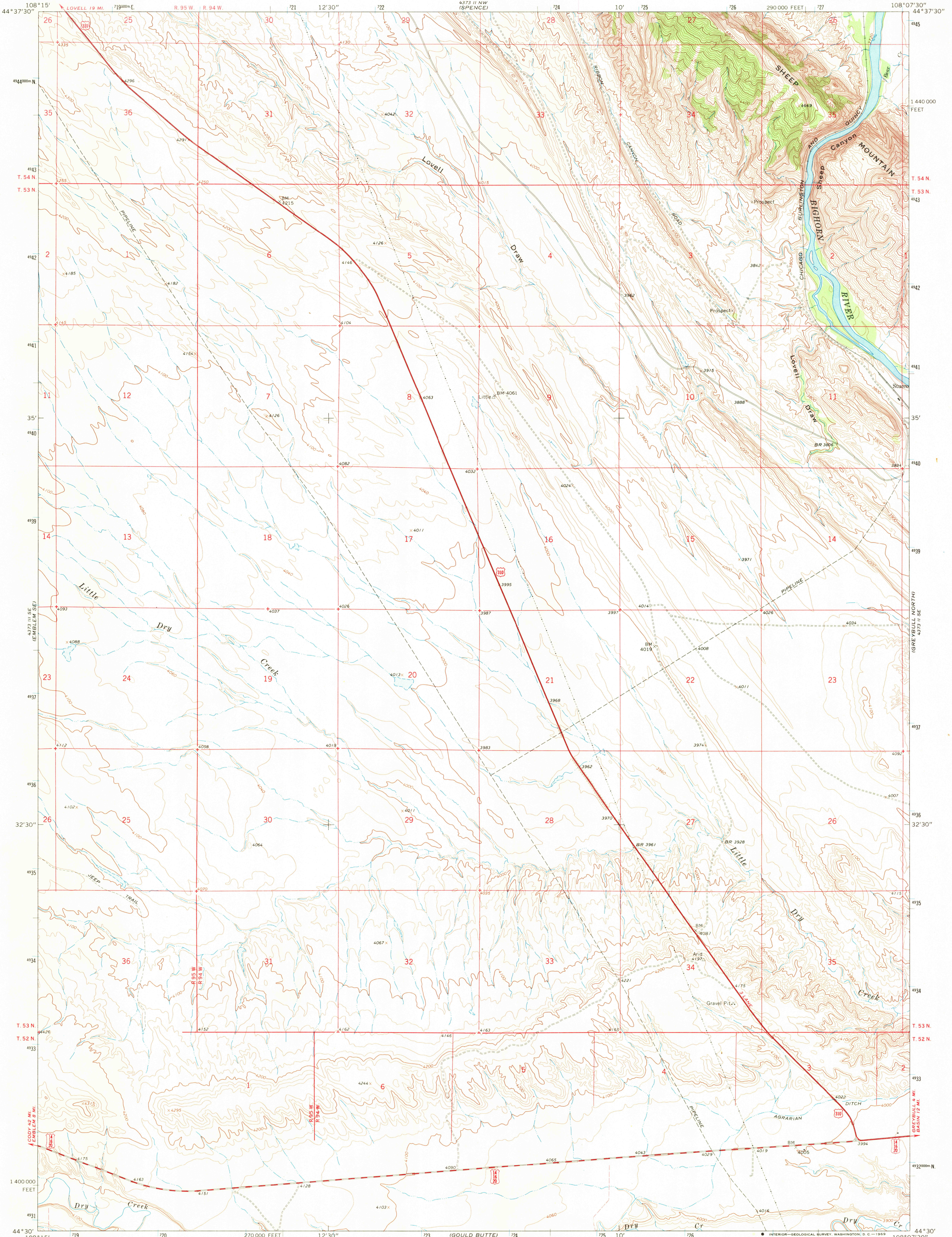

Mapped, edited, and published by the Geological Survey

Control by USGS and USC&GS

Topography by photogrammetric methods from aerial

photographs taken 1964. Field checked 1966

Polyconic projection. 1927 North American datum

10,000-foot grid based on Wyoming coordinate system,

east central zone. 1000-meter Universal Transverse Mercator grid ticks,

zone 12, shown in blue

Fine red dashed lines indicate selected fence lines

Land lines are omitted in areas of extensive tract surveys

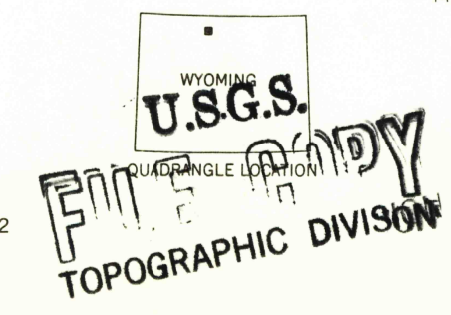
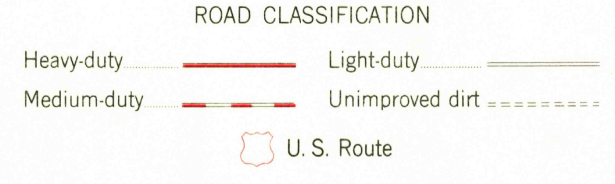
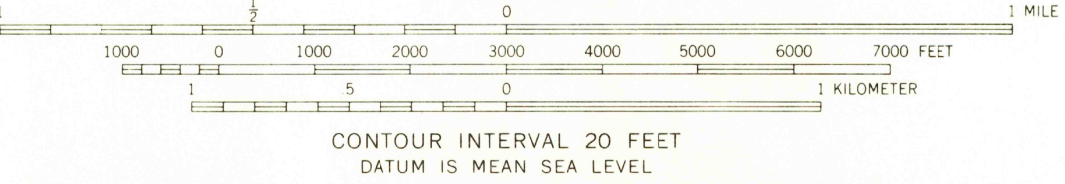
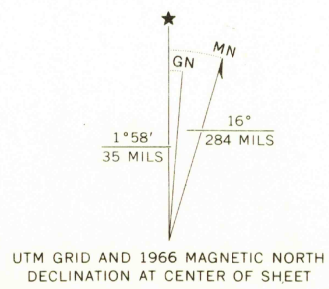

SHEEP CANYON, WYO.  
N4430-W10807.5/7.5

1966

AMS 4373 II SW-SERIES V874

THIS MAP COMPLIES WITH NATIONAL MAP ACCURACY STANDARDS  
FOR SALE BY U.S. GEOLOGICAL SURVEY, DENVER, COLORADO 80225, OR WASHINGTON, D. C. 20242  
A FOLDER DESCRIBING TOPOGRAPHIC MAPS AND SYMBOLS IS AVAILABLE ON REQUEST

RETURN TO:  
USGS HISTORICAL MAP ARCHIVES

2395  
SEP 25 1969