

Mapped, edited, and published by the Geological Survey as part of the Department of the Interior program for the development of the Missouri River Basin  
Control by USGS and NOS/NOAA  
Topography from aerial photographs by multiplex methods  
Aerial photographs taken 1949 Field check 1953  
Polyconic projection, 1927 North American datum  
10,000-foot grid based on Wyoming coordinate system, east central zone  
Dashed land lines indicate approximate locations  
1000-meter Universal Transverse Mercator grid ticks, zone 13, shown in blue  
To place on the predicted North Datum 1983 move the projection lines 8 meters north and 51 meters east as shown by dashed corner ticks

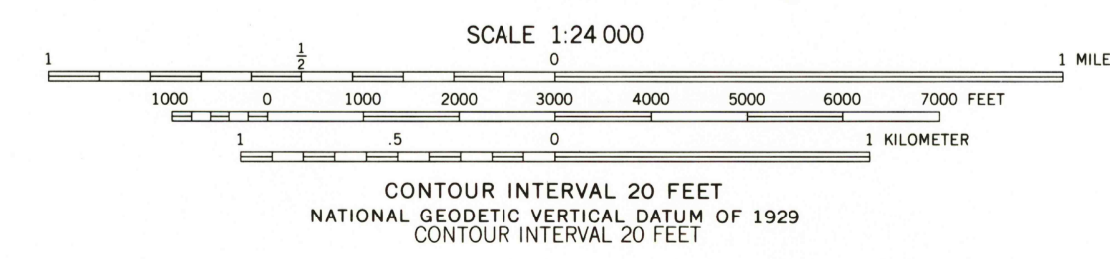
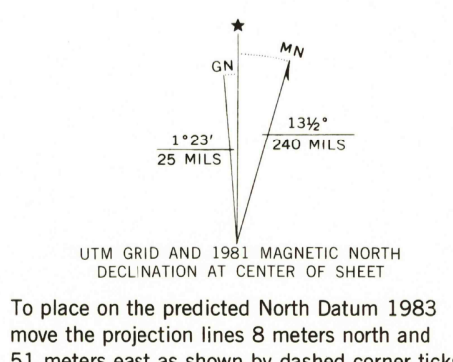

THIS MAP COMPLIES WITH NATIONAL MAP ACCURACY STANDARDS  
FOR SALE BY U. S. GEOLOGICAL SURVEY, DENVER, COLORADO 80225, OR RESTON, VIRGINIA 22092  
A FOLDER DESCRIBING TOPOGRAPHIC MAPS AND SYMBOLS IS AVAILABLE ON REQUEST

ROAD CLASSIFICATION

Heavy-duty	4 LANE 16 LANE	Light-duty
Medium-duty	4 LANE 16 LANE	Unimproved dirt

U. S. Route State Route Interstate Route

WYOMING

QUADRANGLE LOCATION

SINCLAIR, WYO.  
N4145-10700/7.5

1953  
PHOTOREVISED 1981  
DMA 4567 I SE-SERIES V874

Revisions shown in purple compiled from aerial photographs taken 1980 and other source data. This information not field checked. Map edited 1981

RETURN TO:  
USGS AND HISTORICAL MAP ARCHIVES

1986  
STEP 7  
1960