

UNITED STATES
DEPARTMENT OF THE INTERIOR
GEOLOGICAL SURVEY

THE GAP SW QUADRANGLE
WYOMING—CAMPBELL CO.
7.5 MINUTE SERIES (TOPOGRAPHIC)

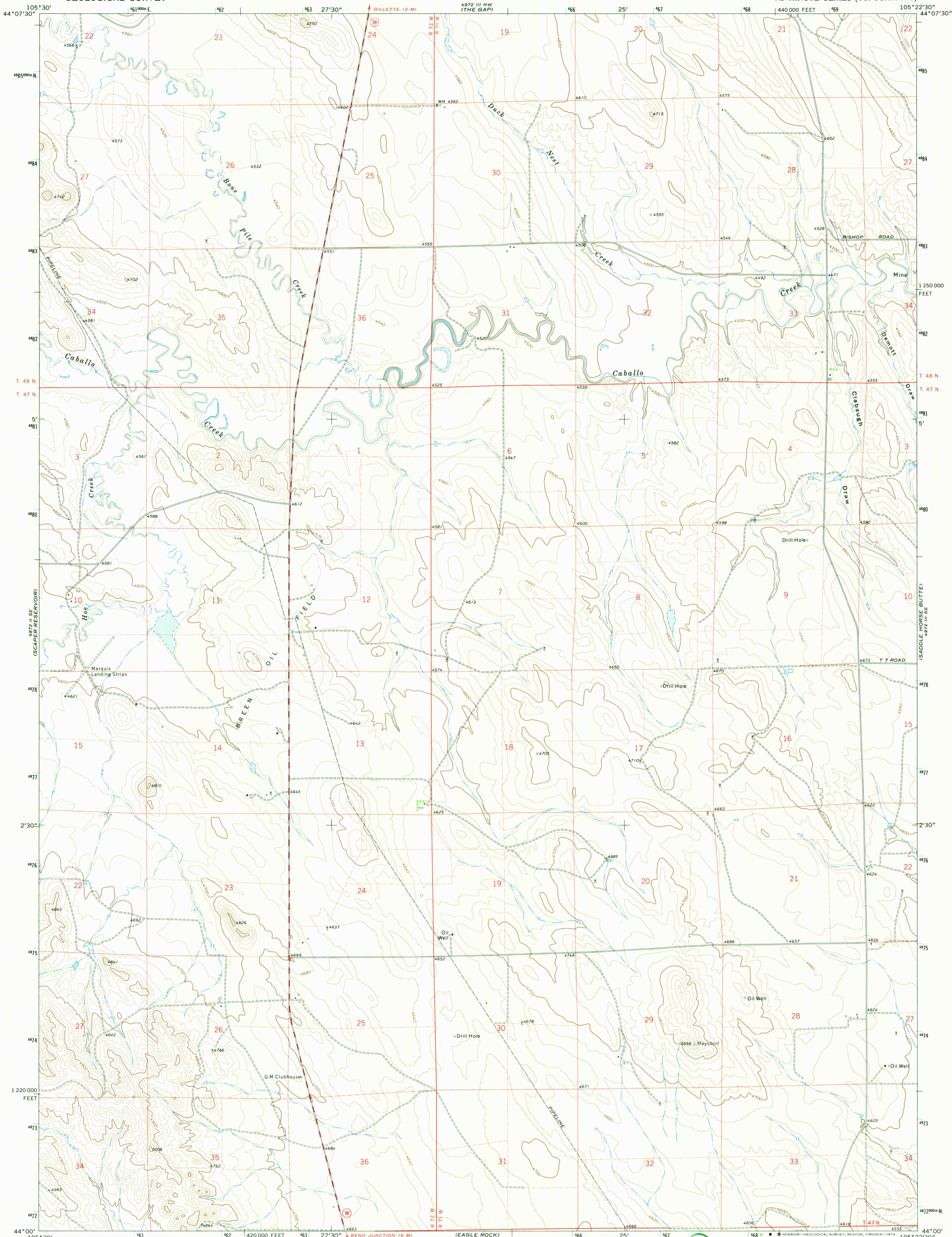

Mapped, edited, and published by the Geological Survey
Control by USGS and USC&GS
Topography by photogrammetric methods from aerial
photographs taken 1970. Field checked 1971.
Projection and 10,000-foot grid ticks: Wyoming
coordinate system, east zone (transverse Mercator).
1000-meter Universal Transverse Mercator grid ticks,
zone 13, shown in blue. 1927 North American datum.
Fine red dashed lines indicate selected fence lines.

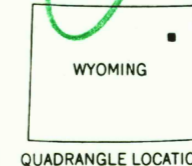
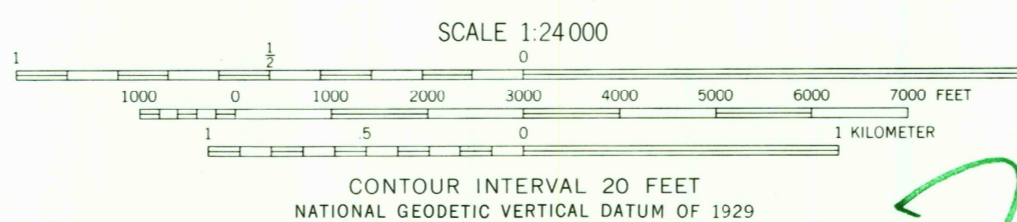
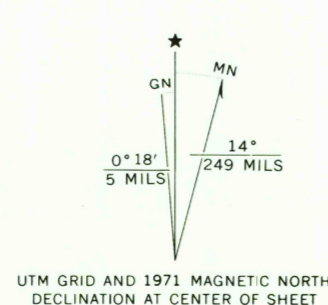

ROAD CLASSIFICATION
Primary highway, hard surface ——— Light-duty road, hard or improved surface ———
Secondary highway, hard surface ——— Unimproved road ———
○ Interstate Route ○ U. S. Route ○ State Route

USGS
Historical File
Topographic Division

THE GAP SW, WYO.
N4400—W10522.5/7.5
1971

AMS 4972 III SW—SERIES W874

RETURN TO:
USGS NHD HISTORICAL MAP ARCHIVES

NOV 08 1974