

UNITED STATES  
DEPARTMENT OF THE INTERIOR  
GEOLOGICAL SURVEY

WILDLIFE DRAW EAST QUADRANGLE  
WYOMING—WESTON CO.  
7.5 MINUTE SERIES (TOPOGRAPHIC)

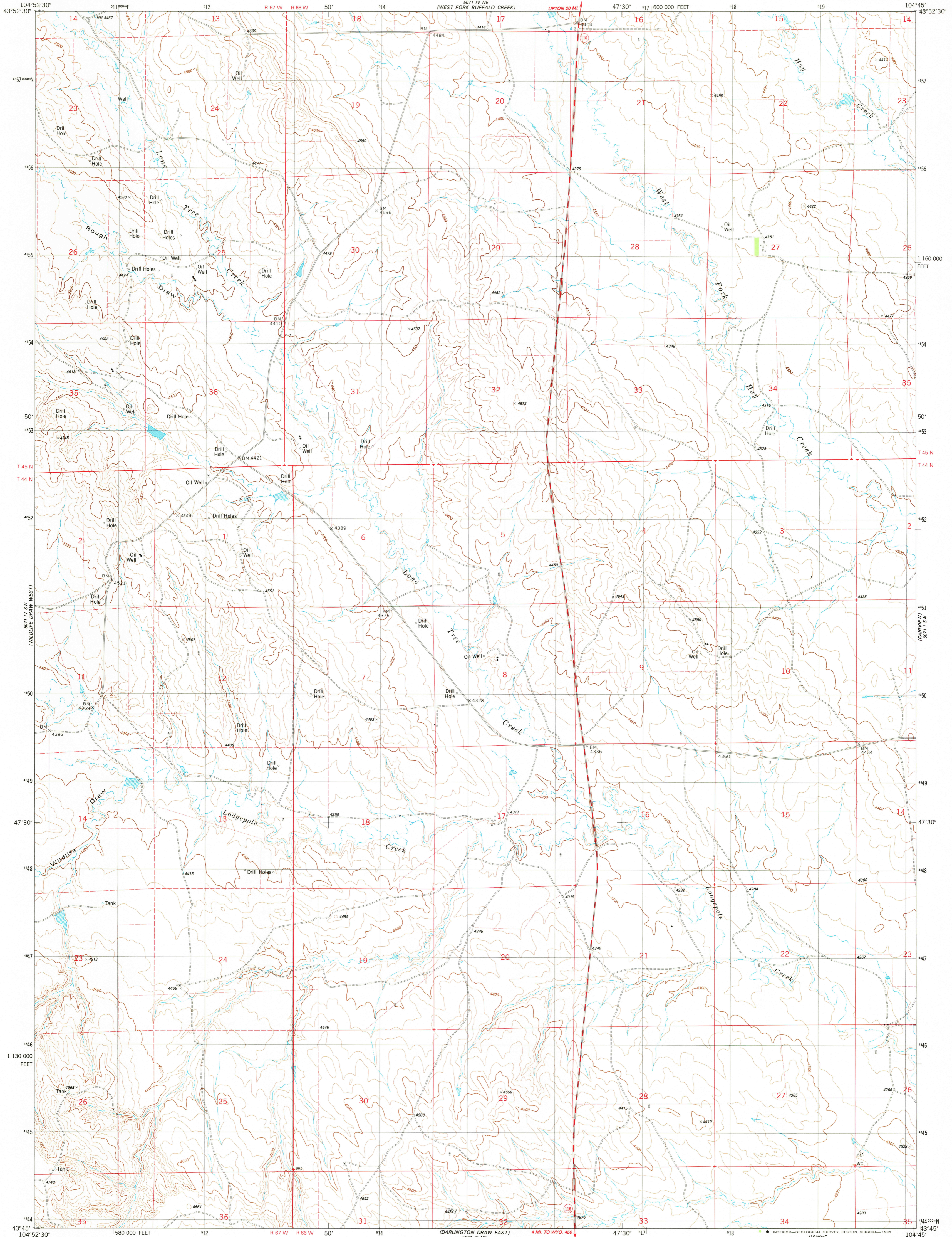

Mapped, edited, and published by the Geological Survey  
Control by USGS and NOS/NOAA  
Topography by photogrammetric methods from aerial photographs taken 1974. Field checked 1975. Map edited 1982  
Projection and 10,000-foot grid ticks: Wyoming coordinate system, east zone (transverse Mercator) 1000-meter Universal Transverse Mercator grid, zone 13 1927 North American datum  
To place on the predicted North American Datum 1983 move the projection lines 7 meters north and 45 meters east as shown by dashed corner ticks  
Fine red dashed lines indicate selected fence lines

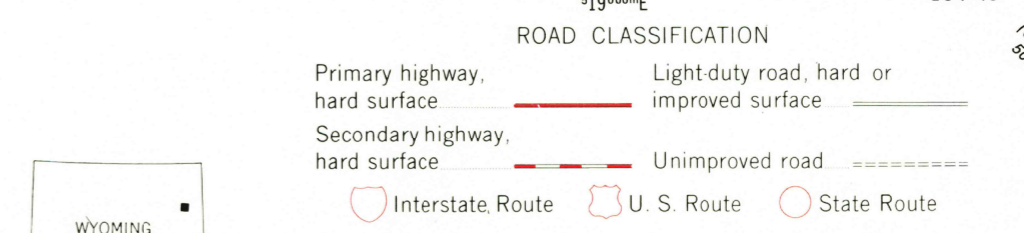
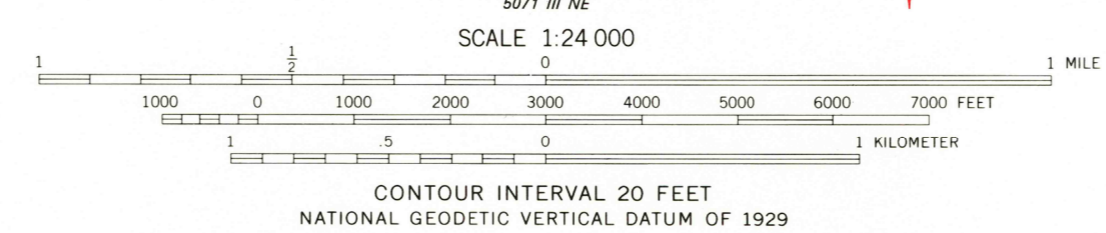
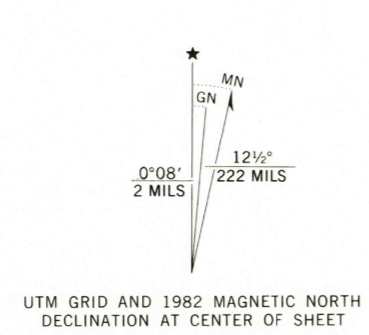

WILDLIFE DRAW EAST, WYO.  
N4345-W10445/7.5

1982

DMA 5071 IV SE—SERIES V674

THIS MAP COMPLIES WITH NATIONAL MAP ACCURACY STANDARDS  
FOR SALE BY U. S. GEOLOGICAL SURVEY, DENVER, COLORADO 80225, OR RESTON, VIRGINIA 22092  
A FOLDER DESCRIBING TOPOGRAPHIC MAPS AND SYMBOLS IS AVAILABLE ON REQUEST

DEC 29 1982

2000

5071 IV SW (FAIRVIEW)

5071 IV NE (WEST FORK BUFFALO CREEK)

5071 IV SW (WILDLIFE DRAW WEST)

5071 IV NE (DARLINGTON DRAW EAST)

5071 IV SW (FAIRVIEW)

RETURN TO:  
USGS AND HISTORICAL MAP ARCHIVES