

4971 NW
(LONE TREE)

UNITED STATES
DEPARTMENT OF THE INTERIOR
GEOLOGICAL SURVEY

WILDLIFE DRAW WEST QUADRANGLE
WYOMING—WESTON CO.
7.5 MINUTE SERIES (TOPOGRAPHIC)

5071 NE
(WES FOK, BUFFALO CREEK)

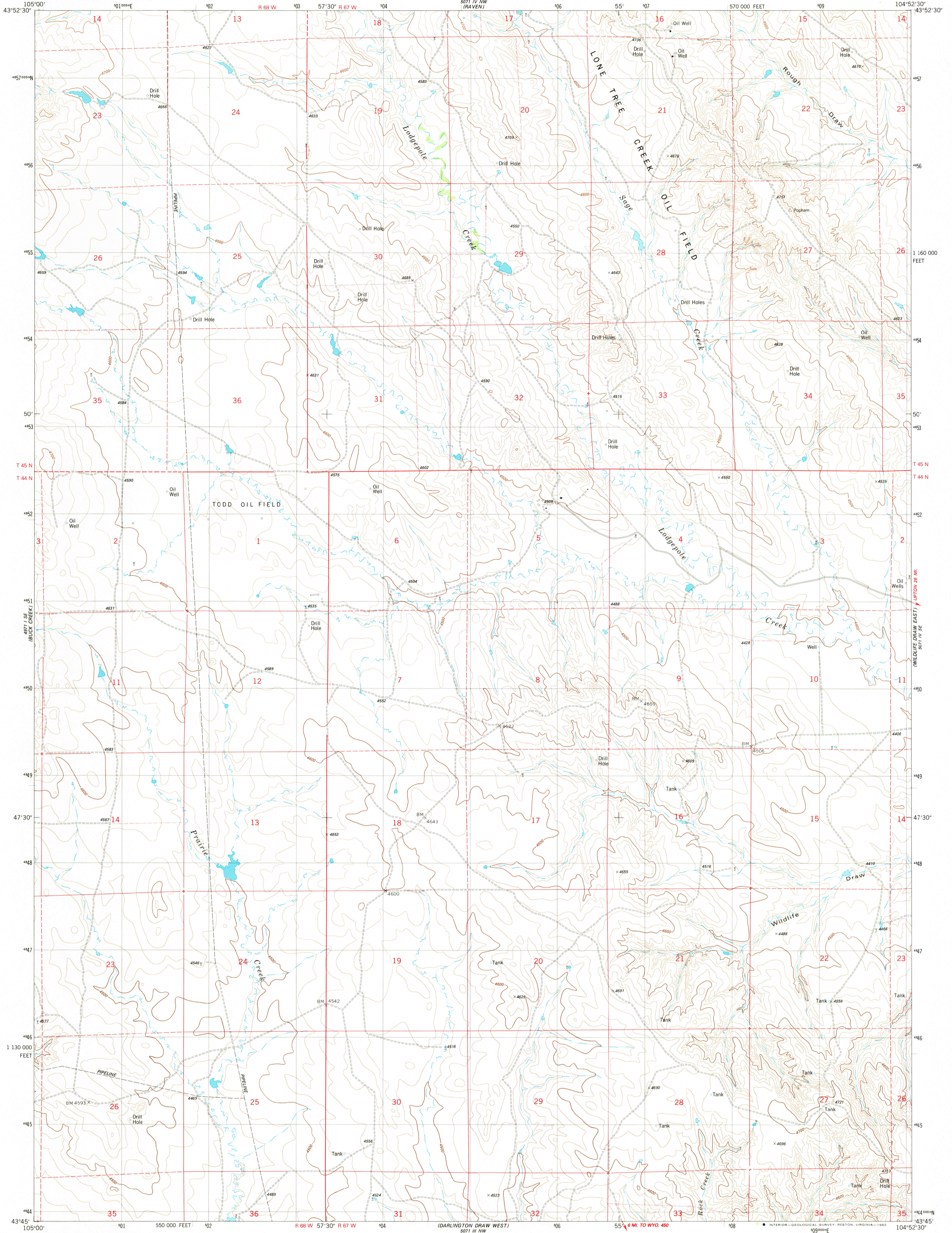

Mapped, edited and published by the Geological Survey
Control by USGS, NOS/NOAA, and USFS
Topography by photogrammetric methods from aerial photographs taken 1974. Field checked 1975. Map edited 1982
Projection and 10,000-foot grid ticks: Wyoming coordinate system, east zone (transverse Mercator)
1000-meter Universal Transverse Mercator grid, zone 13
1927 North American datum
To place on the predicted North American Datum 1983 move the projection lines 7 meters north and 45 meters east as shown by dashed corner ticks
Fine red dashed lines indicate selected fence lines

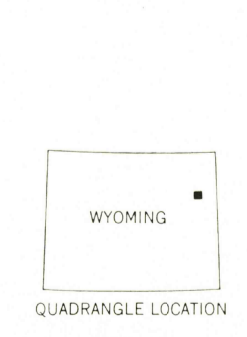
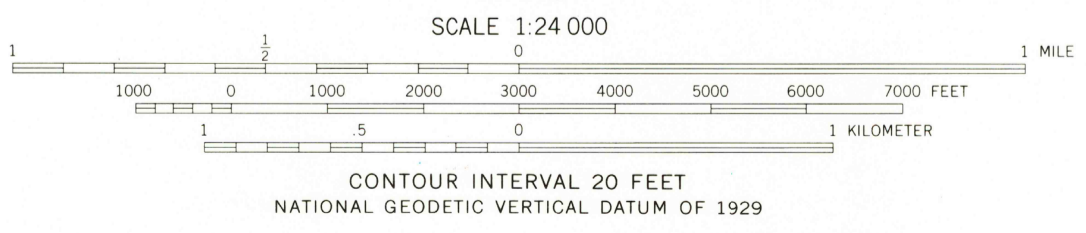
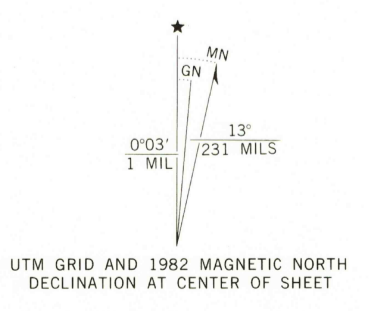

ROAD CLASSIFICATION

Primary highway, hard surface	Light-duty road, hard or improved surface
Secondary highway, hard surface	Unimproved road
Interstate Route	U. S. Route
	State Route

WILDLIFE DRAW WEST, WYO.
N4345-W10452.5/7.5
1982
DMA 5071 IV SW—SERIES V874

THIS MAP COMPLIES WITH NATIONAL MAP ACCURACY STANDARDS
FOR SALE BY U. S. GEOLOGICAL SURVEY, DENVER, COLORADO 80225, OR RESTON, VIRGINIA 22092
A FOLDER DESCRIBING TOPOGRAPHIC MAPS AND SYMBOLS IS AVAILABLE ON REQUEST

RETURN TO:
USGS AND HISTORICAL MAP ARCHIVES

DEC 29 1982

WUC