

U. S. G. S.
FILE COPY
Inspection and Editing.

Unadjusted advance sheet
Subject to correction

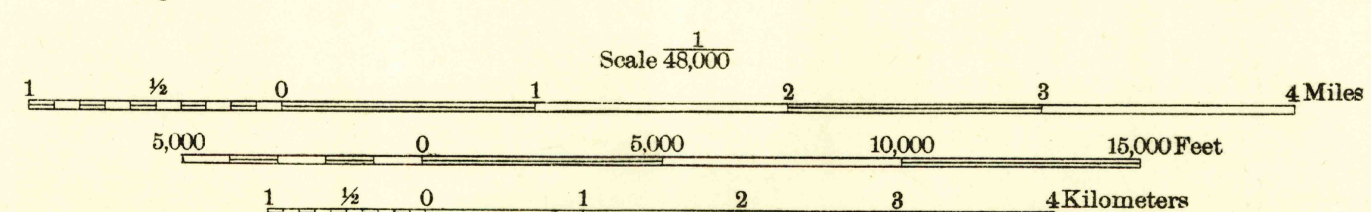

H. H. Hodgeson, Division Engineer
Topography by T. F. Murphy and S. C. Kain
Surveyed in 1936 and 1937

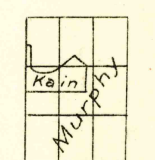

Polyconic projection. 1927 North American datum
APPROXIMATE MEAN DECLINATION, 1937

MOCCASIN LAKE, WYO.

RETURN TO:
USGS NHD HISTORICAL MAP ARCHIVES