

Produced by the United States Geological Survey

North American Datum of 1983 (NAD83) World Geodetic System of 1984 (WGS84) Projection and 1 000-meter grid: Universal Transverse Mercator, Zone 16R 10 000-foot ticks: Alabama Coordinate System of 1983 (west zone)

This map is not a legal document. Boundaries may be generalized for this map scale. Private lands within government reservations may not be shown. Obtain permission before entering private lands.

Imagery.....NAIP, December 2013  
Roads.....HERE, ©2013  
Names.....GNIS, 2013  
Hydrography.....National Hydrography Dataset, 2013  
Contours.....National Elevation Dataset, 2008  
Boundaries.....Multiple sources; see metadata file 1972 - 2013

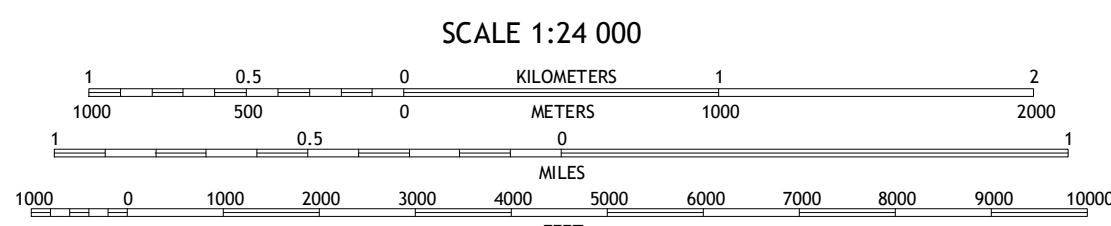
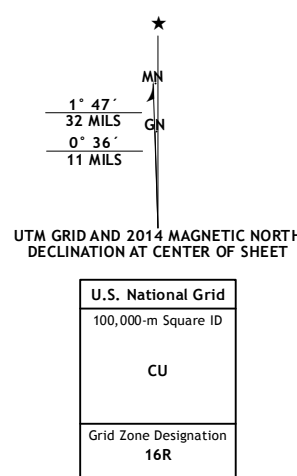

CONTOUR INTERVAL 10 FEET NORTH AMERICAN VERTICAL DATUM OF 1988 This map was produced to conform with the National Geospatial Program US Topo Product Standard, 2011. A metadata file associated with this product is draft version 0.6.16

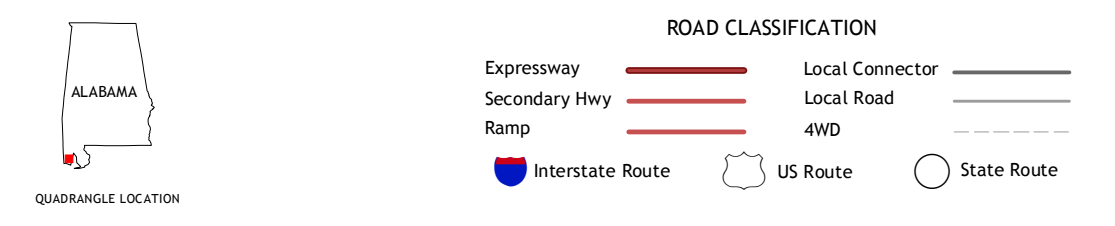

ADJOINING QUADRANGLES table with 8 cells containing numbers 1-8 and corresponding place names: 1 Tanner Williams, 2 Spring Hill, 3 Mobile, 4 Saint Elmo, 5 Hollingers Island, 6 Grand Bay, 7 Coden, 8 Bellefontaine

