

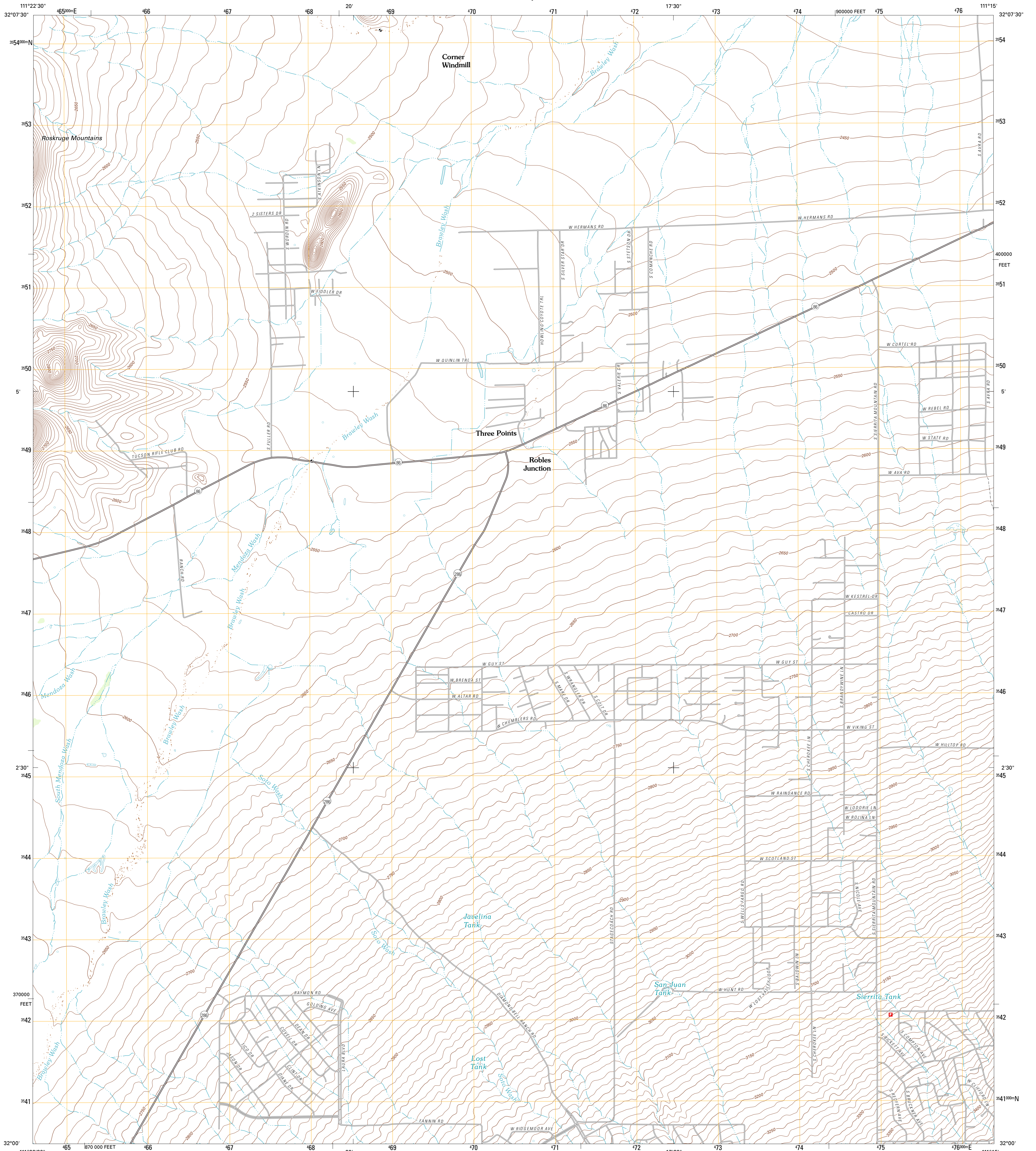

U.S. DEPARTMENT OF THE INTERIOR  
U. S. GEOLOGICAL SURVEY



THREE POINTS QUADRANGLE  
ARIZONA-PIMA CO.  
7.5-MINUTE SERIES



Produced by the United States Geological Survey  
North American Datum of 1983 (NAD83)  
World Geodetic System of 1984 (WGS84) Projection and  
1 000-meter grid; Universal Transverse Mercator, Zone 12S  
10 000-foot ticks; Arizona Coordinate System of 1983  
(central zone)

Imagery: NAD, June 2010  
©2006-2011 Terracon  
Names: GNS, 2011  
Hydrography: National Hydrography Dataset, 2007  
Contours: National Elevation Dataset, 2002  
Boundaries: Census, IBWC, IBC, USGS, 1972-2010

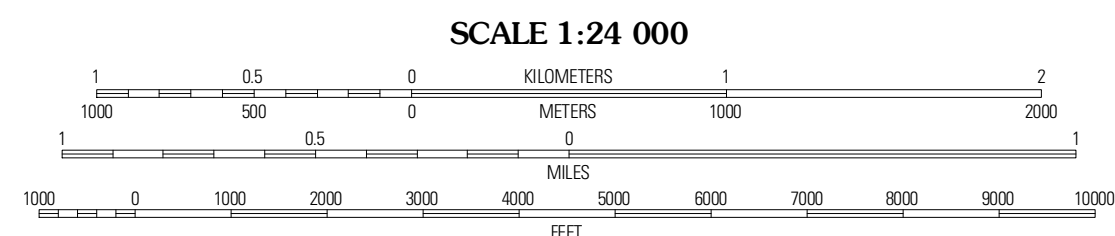
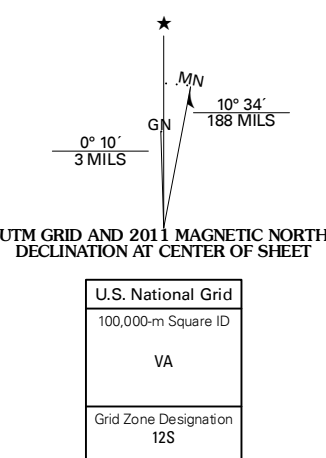

CONTOUR INTERVAL 10 FEET  
NORTH AMERICAN VERTICAL DATUM OF 1988  
This map was produced to conform with the  
National Geospatial Program US Topo Product Standard, 2011.  
A metadata file associated with this product is draft version 0.6.1



QUADRANGLE LOCATION

La Tortuga Butte	Cocoraque Butte	Brown Mountain
San Pedro	Three Points	San Xavier Mission SW
Palo Alto Ranch	Stevens Mountain	Samaniego Peak

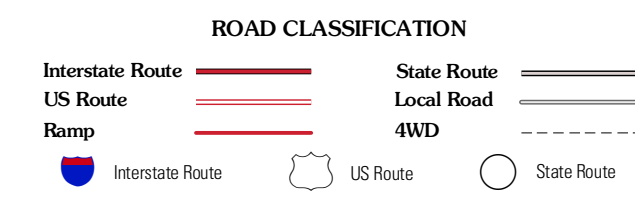

THREE POINTS, AZ  
2011

ADJOINING 7.5 QUADRANGLES