

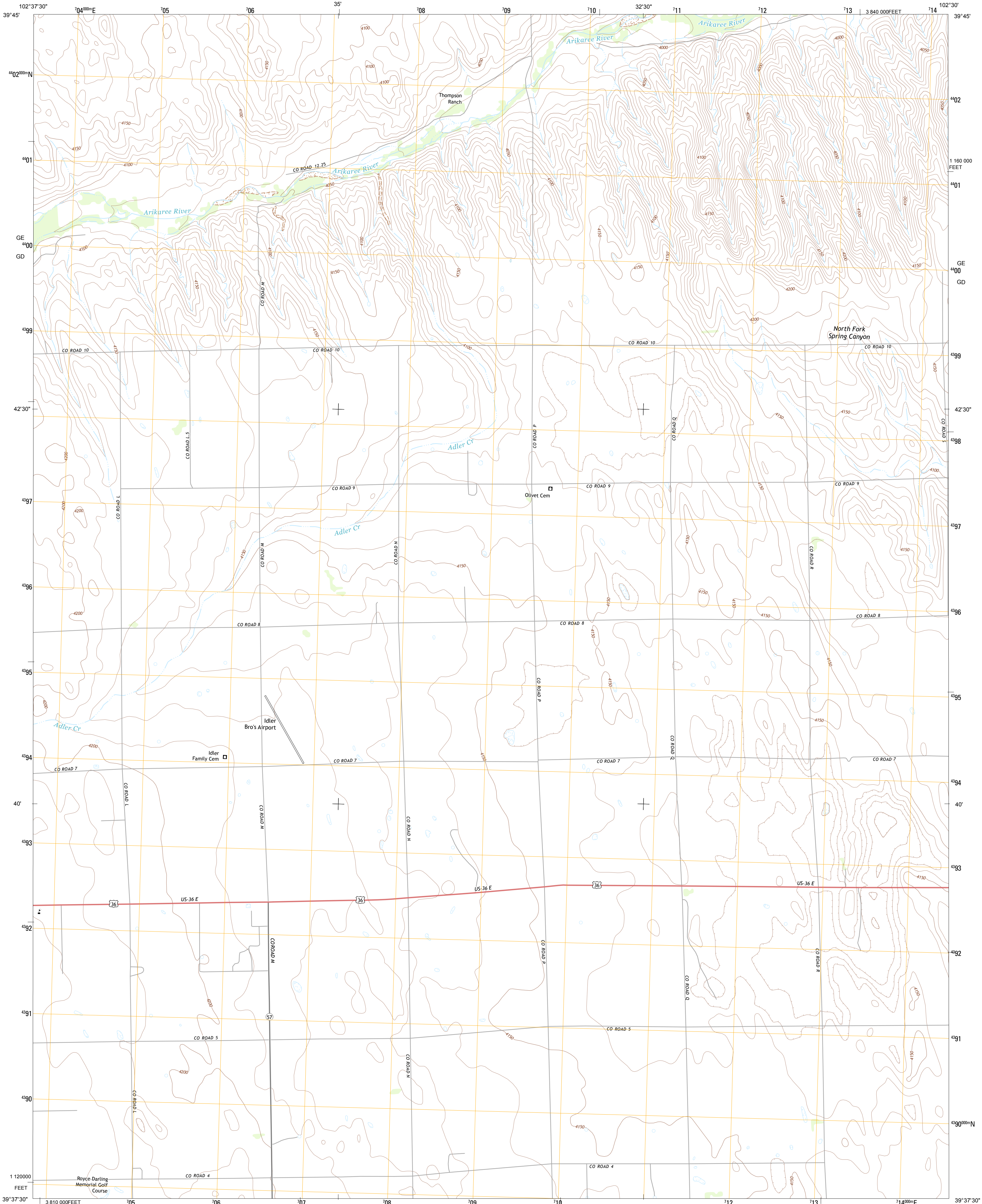

U.S. DEPARTMENT OF THE INTERIOR
U. S. GEOLOGICAL SURVEY



ADLER CREEK QUADRANGLE
COLORADO-YUMA CO.
7.5-MINUTE SERIES



Produced by the United States Geological Survey
North American Datum of 1983 (NAD83)
World Geodetic System of 1984 (WGS84), Projection and
1 000-meter grid; Universal Transverse Mercator, Zone 13S
10 000-foot ticks; Colorado Coordinate System of 1983 (north
zone)

Imagery.....NAIP, July 2011
Roads.....©2006-2012 TomTom
Names.....GNIS, 2013
Hydrography.....National Hydrography Dataset, 2011
Contours.....National Elevation Dataset, 2007
Boundaries, IRWC, IBC, USGS, 1972 - 2012
Public Land Survey System.....BLM, 2011

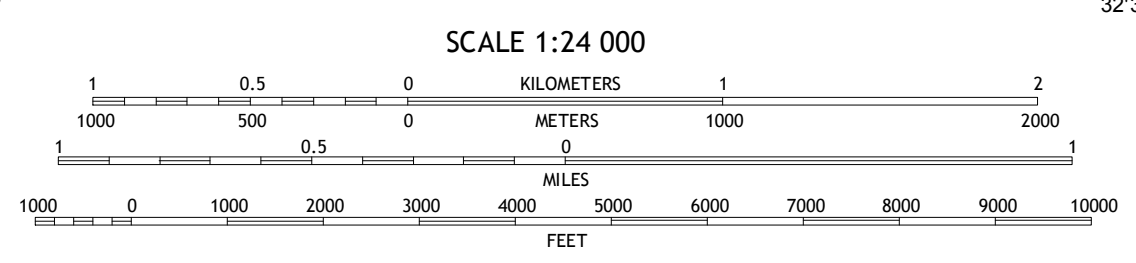
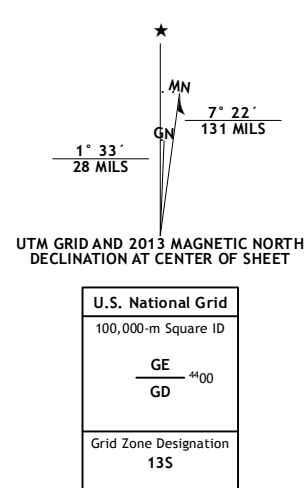

This map was produced to conform with the
National Geospatial Program US Topo Product Standard, 2011.
A metadata file associated with this product is draft version 0.6.14

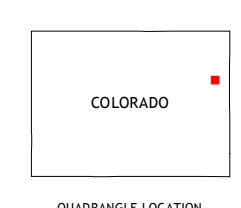

QUADRANGLE LOCATION

Abarr	Abarr SE	Vernon SW
Joel	Adler Creek	Spring Canyon
Joel SW	Kirk	Idalia SW

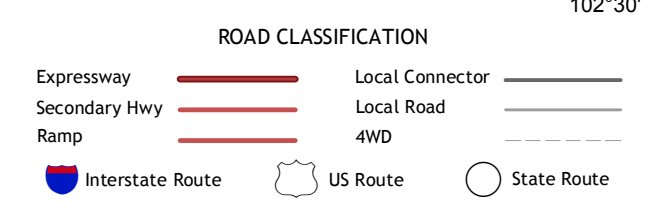

ADLER CREEK, CO
2013