

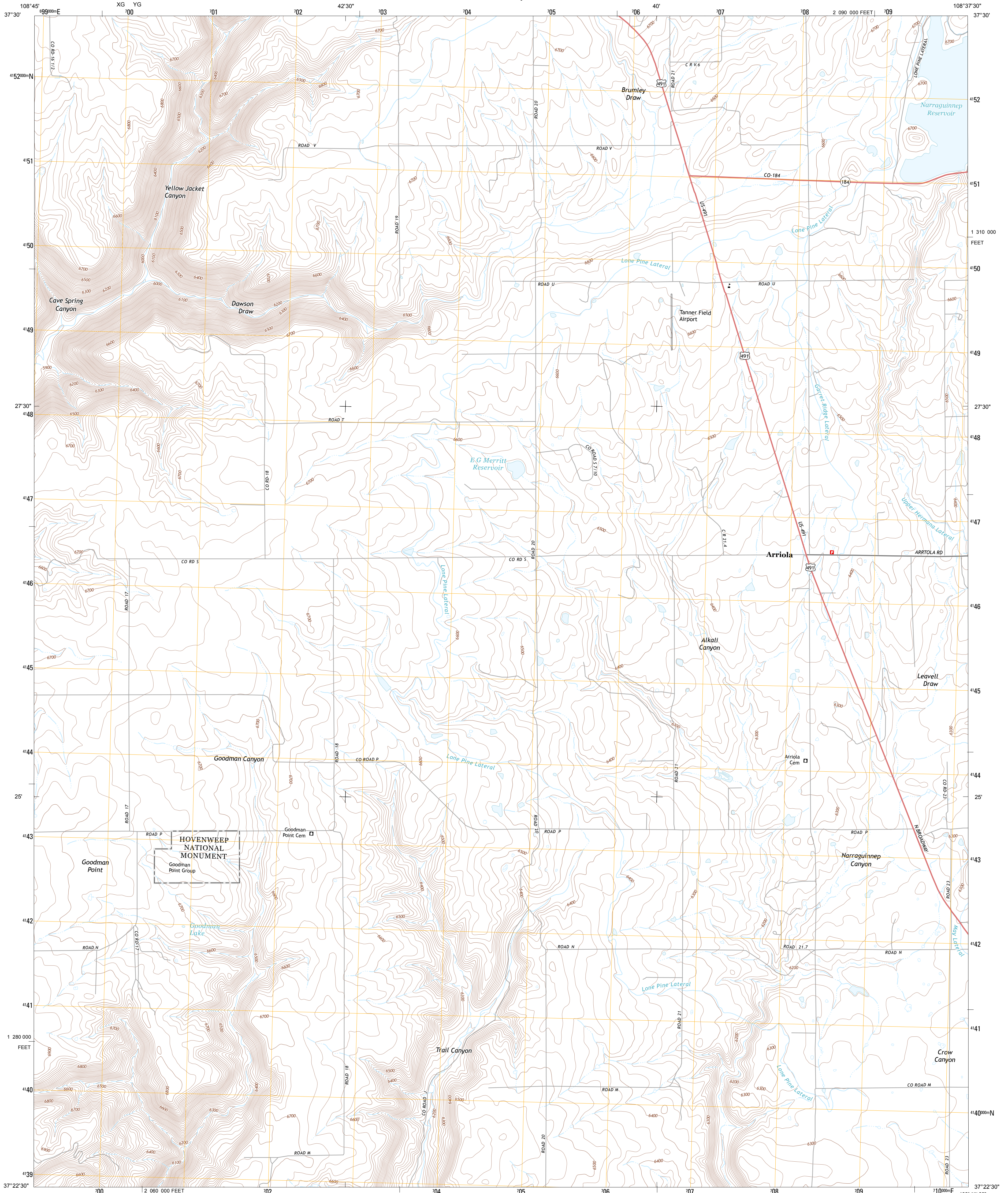

U.S. DEPARTMENT OF THE INTERIOR  
U. S. GEOLOGICAL SURVEY



ARRIOLA QUADRANGLE  
COLORADO-MONTEZUMA CO.  
7.5-MINUTE SERIES



Produced by the United States Geological Survey  
North American Datum of 1983 (NAD83)  
World Geodetic System of 1984 (WGS84), Projection and  
1 000-meter grid: Universal Transverse Mercator, Zone 12S  
10 000-foot ticks: Colorado Coordinate System of 1983 (south  
zone)

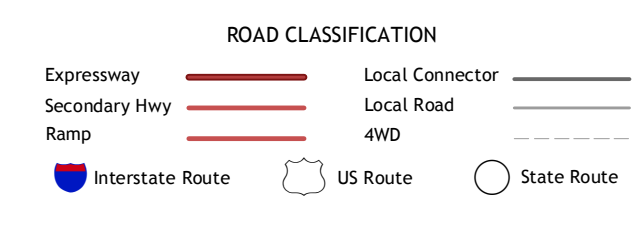
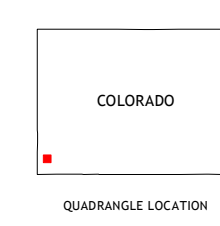
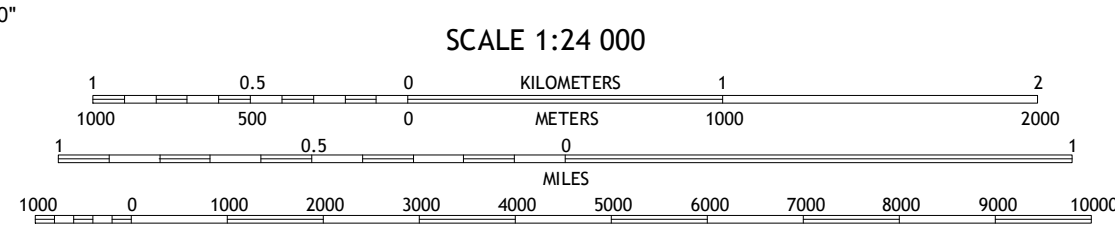
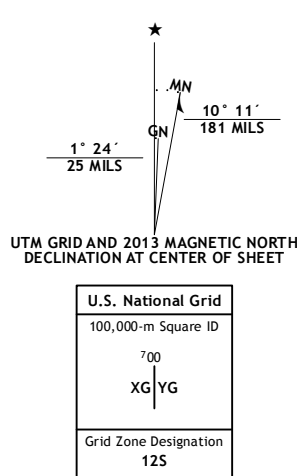

QUADRANGLE LOCATION

Pleasant View	Yellow Jacket	Trimble Point
Woods Canyon	Arriola	Dolores West
Battle Rock	Mud Creek	Cortez

CONTOUR INTERVAL 20 FEET  
NORTH AMERICAN VERTICAL DATUM OF 1988  
This map was produced to conform with the  
National Geospatial Program US Topo Product Standard, 2011.  
A metadata file associated with this product is draft version 0.6.14

ARRIOLA, CO  
2013

ADJOINING 7.5' QUADRANGLES